

## Silencers

# Series S



The silencers metal wire stainless steel, bronze, brass, bronze powder and stainless steel are produced in Italy in accordance with ISO 9002 and are the solution to every need, from the purification of fluids (liquids and gases) to shock and noise absorption of liquids and gases.

## Technical sheet

<b>FLUIDS</b>		Liquids and gases, compressed air (for information please contact our technical Dept.)
<b>APPLICATIONS</b>		Pneumatic equipment, filtration systems, reduction, abatement and protection related to the use of fluids.
<b>SUGGESTED TUBES</b>		Normally not applied directly to pipes, however defined according to the applications.
<b>TEMPERATURE AND PRESSURE</b>		In pneumatic applications they follow the requirements of other similar components, such as fittings, the salient element, the maximum noise level, is anyway determined at 4 and 6 bar.
<b>THREAD TYPE</b>		BSP pipe thread no nickel
<b>MATERIALS</b>	<b>Bodies</b>	Brass, stainless steel AISI 304, AISI 316, copper-plated steel, acetal resin and nylon
	<b>Seals</b>	Acetal resin and nylon AISI 304, AISI 316
	<b>Filters</b>	Sintered bronze

## Additional technical informations

All silencers for air compressed illustrated ON the catalog have been classified according to objective evidence got as a result of flow tests and noise tests to which they were subjected by the manufacturer. The flow tests were carried out by varying the pressure upstream via the pressure regulator. The noise tests have been performed in the work environment at two pressure levels: 6 bar and 4 bar.

As an example is shown below the flow chart for the model SFE18 and a summary table of the levels of noise measured at a pressure of 6 bar on the main models (consider that at 4 bar such values fall on average values of about 3-6% depending on the model and size).

Model	Noise level at 6 BAR (dB)					
	1/8	1/4	3/8	1/2	3/4	1"
SBE	75	81	82	85		
SEB	79	78	82	85	94	95
SEP	73	74	85	89	89	90
SFE	74	72	88	90	90	92
SP	72	73	84	88	88	89
SVE	72	73	84	88	88	89
SPL	87	84	90	90	91	90
SPLF	87	90	92	92		

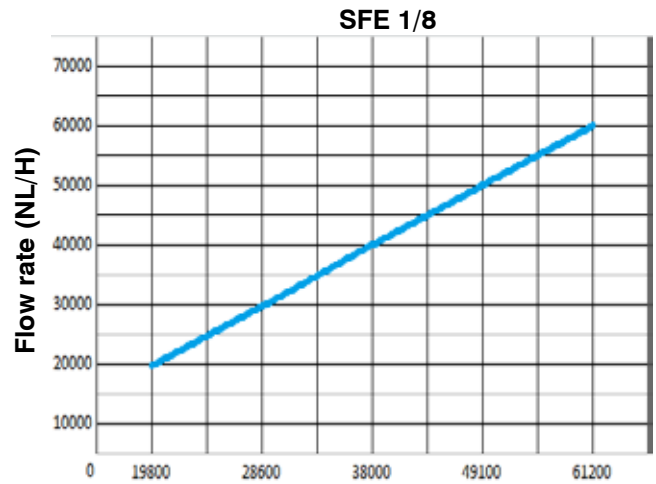

ART. **SBE**

**Conical-shaped silencer on hexagonal base**



COD.	A	N	F	L	H			
SBE18	1/8" BSP	8	6	15	29	13	50	8,80
SBE14	1/4" BSP	8	7	17	32	16	50	14,35
SBE38	3/8" BSP	7	8	25	40	19	25	22,88
SBE12	1/2" BSP	9	9	27	45	24	25	41,38
SBE34	3/4" BSP	10	9	37	56	30	5	82,90
SBE01	1" BSP	10	11	45	66	36	5	94,30
SBE5MA	M5"	4	4	9	17	8	100	2,40
SBE18FEM	1/8" FEM BSP	8	7	15	30	13	50	15,50

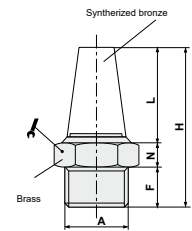

ART. **SBT**

**Conical-shaped silencer on a circular base**



COD.	A	E	F	L	H	N		
SBT18	1/8" BSP	12	6	15	25	4	100	8,83
SBT14	1/4" BSP	16	7	20	30	3	50	13,23
SBT38	3/8" BSP	19	8	27	38	3	25	21,30
SBT12	1/2" BSP	23	10	28	42	4	25	44,50
SBT34	3/4" BSP	29	10	38	52	4	5	81,00
SBT01	1" BSP	36	12	46	65,5	7,5	5	118,00

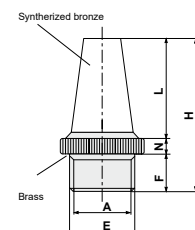

ART. **SAC**

**Thin conical silencer on hexagonal base**



COD.	A	N	F	L	H			
SAC18	1/8" BSP	8	6	30	44	13	100	10,10
SAC14	1/4" BSP	8	7	35	50	16	50	20,00
SAC38	3/8" BSP	7	8	39	54	19	25	30,00
SAC12	1/2" BSP	9	9	49	67	24	25	62,00
SAC34	3/4" BSP	10	9	46	65	30	5	95,00
SAC01	1" BSP	10	11	56	77	36	5	170,00
SAC5MA	M5"	4	4	18	26	8	100	2,00
SAC18FEM	1/8" FEM BSP	8	7	30	45	13	50	10,00

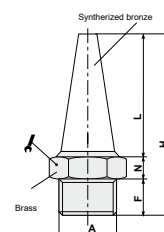

ART. **SBTE-SBTT**

**Silencer with screwdriver cut on a circular base**



COD.	A	E	F	L	H	N			
SBTT18	1/8" BSP	12	6	15	25	4	6	100	8,30
SBTT14	1/4" BSP	16	7	20	30	3	7	50	13,30
SBTT38	3/8" BSP	19	8	27	38	3	10	25	22,50
SBTT12	1/2" BSP	23	10	28	42	4	13	25	40,50
SBTT34	3/4" BSP	29	10	38	52	4	17	10	73,00
SBTT01	1" BSP	36	12	46	65,5	7,5	22	10	123,00
SBTE18	1/8" BSP	12	6	15	25	4	6	100	8,40
SBTE14	1/4" BSP	16	7	20	30	3	7	50	13,40
SBTE38	3/8" BSP	19	8	27	38	3	10	25	22,70
SBTE12	1/2" BSP	23	10	28	42	4	13	25	40,70
SBTE34	3/4" BSP	29	10	38	52	4	17	5	73,50
SBTE01	1" BSP	36	12	46	65,5	7,5	22	5	124,00

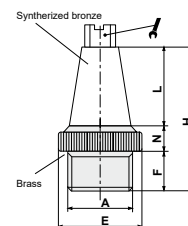

ART. **SPL**

**Dynamic self-cleaning silencer**



COD.	A	B	F	L	H		
SPL18	1/8" BSP	15	8	27	35	100	4,04
SPL14	1/4" BSP	19,5	9	36	45	50	5,86
SPL38	3/8" BSP	24,5	11	47	58	50	13,10
SPL12	1/2" BSP	24,5	11	47	58	50	15,86
SPL34	3/4" BSP	48	18	96	114	10	98,00
SPL01	1" BSP	48	18	96	114	10	117,50

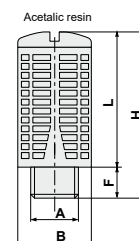

ART. **SPLB**

**Dynamic self-cleaning silencer - Black**



COD.	A	B	F	L	H		
SPLB18	1/8" BSP	15	8	27	35	100	4,04
SPLB14	1/4" BSP	19,5	9	36	45	50	5,86
SPLB38	3/8" BSP	24,5	11	47	58	50	13,10
SPLB12	1/2" BSP	24,5	11	47	58	50	15,86
SPLB34	3/4" BSP	48	18	96	114	10	98,00
SPLB01	1" BSP	48	18	96	114	10	117,50

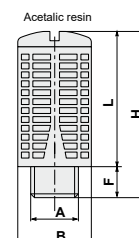

ART. **SPLF**

**Static felt silencer**



COD.	A	B	C	D	E			
SPLF18	1/8" BSP	28	16	6	34	10	100	2,24
SPLF14	1/4" BSP	36,5	19,5	6,5	43	13	50	3,96
SPLF38	3/8" BSP	46	24	10	56	17	50	8,02
SPLF12	1/2" BSP	46	24	10	56	17	50	9,38
SPLF34	3/4" BSP	95	48	16	111	(*)	10	65,00
SPLF01	1" BSP	95	48	16	111	(*)	10	70,00

(\*) Screwdriver cut

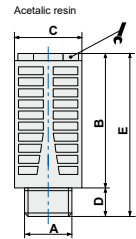

ART. **SVE**

**Silencer with regulating valve**



COD.	A	B min	B max	C			
SVE18	1/8" BSP	20	22	6	13	50	16,20
SVE14	1/4" BSP	22	24	8	15	50	23,52
SVE38	3/8" BSP	25	28	10	22	25	57,00
SVE12	1/2" BSP	26	29	11	22	25	57,55
SVE34	3/4" BSP	32	37	12	30	5	136,50
SVE01	1" BSP	32	37	12	36	5	195,00

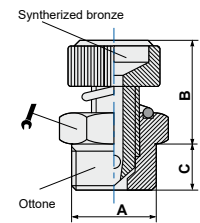

ART. **SVEX-316**

**Stainless steel AISI 316 silencer with regulating valve**



COD.	A	B min	B max	C			
SVE18X-316	1/8" BSP	20	22	6	13	1	14,70
SVE14X-316	1/4" BSP	22	24	8	15	1	21,90

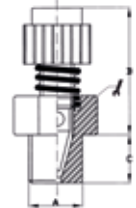

ART. **RBP**

**Silencer with regulating valve**



COD.	A	B min	B max	C			
RBP18	1/8" BSP	14	19	6	12	50	10,85
RBP14	1/4" BSP	17	22	8	15	50	17,50
RBP38	3/8" BSP	18	24	9	19	25	34,80
RBP12	1/2" BSP	18	24	10,5	22	10	50,00

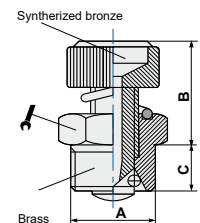

ART. **SM**

**Pressure damper**



COD.	A	L			
SM1018	1/8" BSP	30	14	50	17,00
SM2014	1/4" BSP	36	19	25	43,00
SM3038	3/8" BSP	45	27	25	120,00
SM4012	1/2" BSP	50	20	25	130,00

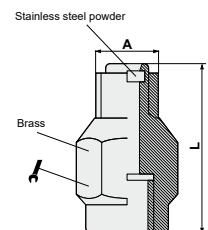

ART. **SC**

**Conical-shaped silencer on a circular base**



COD.	A	E	F	L	H		
SC18	1/8" BSP	12	6	15	21	100	6,19
SC14	1/4" BSP	15	6	19	25	50	11,40
SC38	3/8" BSP	19	8	28	36	25	26,60
SC12	1/2" BSP	23	10	33	43	25	41,00
SC34	3/4" BSP	29	13	40	53	5	75,50
SC01	1" BSP	36	15	48	63	5	133,00
SC5MA	M5"	6	4,5	8,5	13	100	1,46

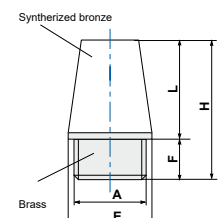

ART. **SEB**

**Conical-shaped silencer on hexagonal base**



COD.	A	C	E	F	H			
SEB18	1/8" BSP	12,6	4,5	3,8	20,5	12	100	47,00
SEB14	1/4" BSP	16	6	4,5	26,5	15	50	88,00
SEB38	3/8" BSP	20	7	5,4	33,9	19	25	22,20
SEB12	1/2" BSP	24,5	8	7	40,5	23	25	311,00
SEB34	3/4" BSP	32	9	7,5	51,5	30	5	619,00
SEB01	1" BSP	38,5	11	9	66	36	5	1283,00
SEB5MA	M5"	8	5,5	3,5	17	7	100	17,00

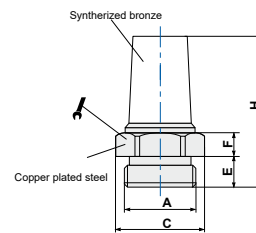

ART. **SET**

**Hexagonal head silencer**



COD.	A	E	F	L	H			
SET18	1/8" BSP	11,5	4,5	13	17,5	8	100	53,00
SET14	1/4" BSP	15	6	18	24	10	50	92,00
SET38	3/8" BSP	19	7	24	31	13	25	201,00
SET12	1/2" BSP	23	8	29	37	14	25	321,00
SET34	3/4" BSP	30	9	41	50	19	5	640,00
SET01	1" BSP	37	11	51	62	24	5	1157,00
SET5MA	M5"	8,5	5	15	20	27	100	28,00

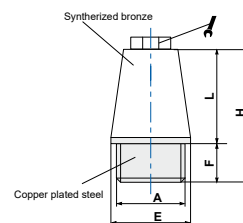

ART. **SCQ**

**Square head silencer**



COD.	A	E	F	L	H			
SCQ18	1/8" BSP	12	6	15	21	7	100	7,60
SCQ14	1/4" BSP	15	6	19	25	9	50	14,50
SCQ38	3/8" BSP	19	8	28	38	10	25	25,00
SCQ12	1/2" BSP	23	10	33	43	14	25	47,00
SCQ34	3/4" BSP	29	13	40	53	17	5	102,00
SCQ01	1" BSP	36	15	48	63	23	5	166,50

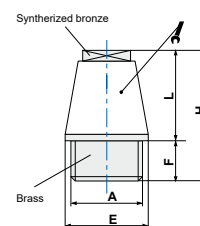

ART. **SFT**

**Square head silencer**



COD.	A	F	H	ØE		
SFT18	1/8" BSP	6	13	12	100	5,30
SFT14	1/4" BSP	7	14	16	50	9,50
SFT38	3/8" BSP	8	18	19	25	12,60
SFT12	1/2" BSP	10	19	23	25	23,50
SFT34	3/4" BSP	10	22	29	5	31,50
SFT01	1" BSP	12	23	36	5	53,70
SFT5MA	M5"	5	12	11	100	4,50

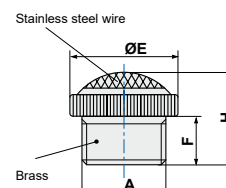

ART. **STT**

Cap silencer with screwdriver cut



COD.	A	B	F	L	H	C		
STT18	1/8" BSP	10	6	6	12	1,5	100	4,20
STT14	1/4" BSP	13	6	6	12	1,5	50	7,40
STT38	3/8" BSP	17	7	8	15	1,5	25	14,80
STT12	1/2" BSP	21	10	8	18	1,5	25	21,70
STT34	3/4" BSP	26	13	9	22	1,5	5	32,20
STT01	1" BSP	33	14	11	25	1,5	5	68,00

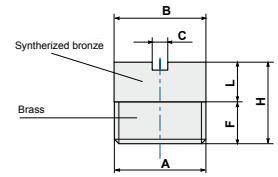

ART. **SFE**

Cap silencer with screwdriver cut



COD.	A	F	H			
SFE18	1/8" BSP	6	15	13	100	6,18
SFE14	1/4" BSP	7	18	16	50	11,97
SFE38	3/8" BSP	8	20	19	50	15,36
SFE12	1/2" BSP	10	22	24	25	23,95
SFE34	3/4" BSP	10	26	30	25	34,19
SFE01	1" BSP	12	28	36	10	58,00
SFE5MA	M5"	4	8	8	100	1,76
SFE18FEM	1/8" FEM BSP	7	18	14	50	8,60

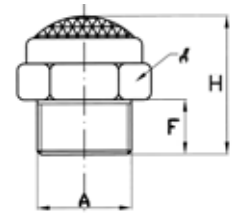

ART. **SFEX**

Stainless steel AISI 304 cap silencer on hexagonal base



COD.	A	F	H			
SFEXM5	M5	4	8	8	100	1,70
SFEX18	1/8" BSP	6	15	13	50	5,70
SFEX14	1/4" BSP	7	18	16	50	11,40
SFEX38	3/8" BSP	8	20	19	50	16,00
SFEX12	1/2" BSP	10	22	24	25	24,30
SFEX34	3/4" BSP	10	26	30	5	35,00
SFEX01	1" BSP	12	28	36	5	54,40

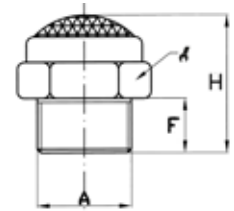

ART. **SFEX NPT-316**

Stainless steel AISI 316, NPT thread, cap silencer on hexagonal base



COD.	A	F	H			
SFE18XNPT-316	1/8" NPT	10	18	13	1	7,60
SFE14XNPT-316	1/4" NPT	15	25	16	1	14,80
SFE38XNPT-316	3/8" NPT	15	26	19	1	19,80
SFE12XNPT-316	1/2" NPT	19	33	24	1	36,80
SFE34XNPT-316	3/4" NPT	20	35	30	1	50,60
SFE01XNPT-316	1" NPT	24	45	36	1	118,10

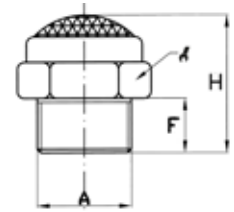

ART. **SBP**

Flat silencer on circular base



COD.	A	B	E	F	H		
SBP18	1/8" BSP	11	12	6	12	100	5,60
SBP14	1/4" BSP	14	16	7	13	50	10,00
SBP38	3/8" BSP	17	19	8	17	25	15,00
SBP12	1/2" BSP	22	23	10	18	25	25,40
SBP34	3/4" BSP	28	29	10	20	5	32,80
SBP01	1" BSP	35	36	12	21	5	56,50
SBP5MA	M5"	11	12	5	11,5	100	4,50

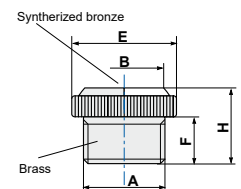

ART. **SEP**

**Flat silencer on hexagonal base**



COD.	A	B	F	H			
SEP18	1/8" BSP	11	6	14	13	100	52,00
SEP14	1/4" BSP	14	7	17	16	50	86,00
SEP38	3/8" BSP	17	8	18	19	25	130,00
SEP12	1/2" BSP	22	10	20	24	25	203,00
SEP34	3/4" BSP	28	10	23	30	5	285,00
SEP01	1" BSP	35	12	25	36	5	475,00
SEP5MA	M5"	7	5	12	8	100	15,00
SEP18FEM	1/8" FEM BSP	11	7	17	14	50	6,00

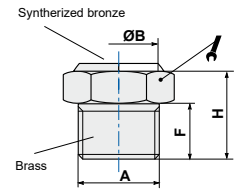

ART. **SP**

**Retractable flat silencer**



COD.	A	B	H		
SP18	1/8" BSP	6	5	100	11,00
SP14	1/4" BSP	8	6	50	26,00
SP38	3/8" BSP	10	7	25	50,00
SP12	1/2" BSP	15	8	25	10,70
SP34	3/4" BSP	20	9	5	14,00
SP01	1" BSP	26	10	5	26,50

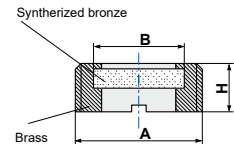

ART. **SPL-P**

**Polyethylene silencer with threaded base**



COD.	A	D	H	h		
SPLP-M5	M5	6,5	21,5	4,0	50	0,30
SPLP-18	1/8	12,5	34,5	5,5	50	1,81
SPLP-14	1/4	15,5	42,5	8,0	50	3,07
SPLP-38	3/8	18,5	67,5	11,5	50	6,34
SPLP-12	1/2	23,5	79,0	11,0	50	14,00
SPLP-34	3/4	38,5	139,8	16,0	50	49,50
SPLP-1	1"	49,0	154,0	21,0	50	82,66

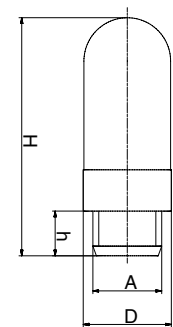

ART. **SPL-R**

**Plug-in polyethylene silencer**



COD.	A	D	H	h		
SPLR-04	4,0	7,0	32,0	16,0	50	3,30
SPLR-06	6,0	12,5	45,0	20,5	50	1,65
SPLR-08	8,0	13,5	43,5	21,5	50	1,85
SPLR-10	10,0	15,5	57,5	26,5	50	3,19
SPLR-12	12,0	18,5	83,0	29,0	50	6,35

