

Technopolymer flow regulators

Series TECNORAP - TECNORAP BLACK



The Tecnorap flow regulators series are produced in Italy according to the reference ISO norms as warranty of high quality level.

Ordering code

T 29 06 18 P

COLOUR (FITTING BODY + THRUST SLEEVE)

- T** = Grey body Green thrust sleeve
- TN** = Grey body Black thrust sleeve
- TS** = Grey body Grey thrust sleeve
- TA** = Grey body Blue thrust sleeve
- TB** = Black body Black thrust sleeve
- TBV** = Black body Green thrust sleeve
- TBS** = Black body Grey thrust sleeve
- TBA** = Black body Blue thrust sleeve

ADJUSTING STEM WITH KNOB

- 28** = For valve
- 29** = For cylinder
- 30** = Bidirectional

TUBE DIAMETER

- 04 ... 12** = For tube Ø4; Ø6; Ø8; Ø10, Ø12 mm

THREADED CONNECTION

- M5** = M5
- 18** = G1/8"
- 14** = G1/4"
- 38** = G3/8"
- 12** = G1/2"

TYPE

- blank** = Orientable type with screwdriver nut
- P** = Swivel type with adjusting knob

Technical sheet

FLUIDS		Compressed air (for different fluid please contact our Technical Dept.)
APPLICATIONS		Pneumatic circuits, low pressure hydraulic applications, according to DIN 3861-3870 norms.
SUGGESTED TUBES		TPU (Polyurethane), PA11/PA12 (Polyamide), TPE (Polyethylene), TPA (Polyurethane/Copolyester)
TUBES TOLERANCES		Diam. between 4 and 10 mm +/- 0,05 Diam. from 12 mm +/- 0,1
TEMPERATURE AND PRESSURE	Recommended limit values	Temperatures and pressures usually depend by the technical features of the employed tubes, anyway it is suggested a limit working pressure of 15 bar and a temperature range between -20°C and +70°C
	Technical testing data	At page 51 there are indicated the load traction resistance values and the main working and breaking limit (Pressure and Temperature) of the main commercial tubing.
	Note	For more complete informations please read the technical catalogue of your tube supplier.
THREAD TYPE		BSP paralell UNI-ISO 228
MATERIALS	Regulation stem	Brass UNI EN 12164 CW614N
	TRAP body, sleeve, collar and back ring	POM copolymer ISO1043-1
	Spring	Stainless steel AISI 301 austenitic
	Seals	NBR 70 DWGV-EN549 UL157

ART. **T28**

Orientable flow regulator for valve



COD.	ØD	G	ØA	H	L	L1			
T2804M5	4	M5	2,0	4	22,5	19,0	8	25	6,15
T280418	4	1/8	5,0	5,5	34,0	21,1	14	25	22,96
T2806M5	6	M5	2,0	4	22,5	22,0	8	25	6,00
T280618	6	1/8	5,0	5,5	34,0	24,3	14	25	23,41
T280614	6	1/4	6,0	6,5	42,0	25,5	17	25	43,38
T280818	8	1/8	5,0	5,5	34,0	24,8	14	25	23,65
T280814	8	1/4	6,0	6,5	42,0	26,5	17	25	44,10
T280838	8	3/8	6,5	7,5	52,0	28,0	20	10	72,00
T281014	10	1/4	6,0	6,5	42,0	28,4	17	25	44,00
T281038	10	3/8	6,5	7,5	52,0	29,9	20	10	72,00
T281238	12	3/8	6,5	7,5	52,0	31,4	20	10	74,00

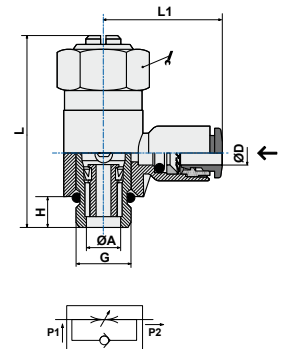

ART. **T29**

Orientable flow regulator for cylinder



COD.	ØD	G	ØA	H	L	L1			
T2904M5	4	M5	2,0	4	22,5	19,0	8	25	6,15
T290418	4	1/8	5,0	4	34,0	21,1	14	25	22,96
T2906M5	6	M5	2,0	4	22,5	22,0	8	25	6,00
T290618	6	1/8	5,0	5,5	34,0	24,3	14	25	23,41
T290614	6	1/4	6,0	6,5	42,0	25,5	17	25	43,38
T290818	8	1/8	5,0	5,5	34,0	24,8	14	25	23,65
T290814	8	1/4	6,0	6,5	42,0	26,5	17	25	44,10
T290838	8	3/8	6,5	7,5	52,0	28,0	20	10	72,00
T291014	10	1/4	6,0	6,5	42,0	28,4	17	25	44,00
T291038	10	3/8	6,5	7,5	52,0	29,9	20	10	72,00
T291012	10	1/2	10,0	9	61,0	30,0	26	10	12,00
T291238	12	3/8	6,5	7,5	52,0	31,4	20	10	7,40
T291212	12	1/2	10,0	9	61,0	34,9	26	10	122,00

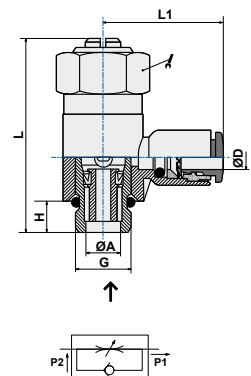

ART. **T30**

Orientable bidirectional flow regulator



COD.	ØD	G	ØA	H	L	L1			
T3004M5	4	M5	2,0	4	22,5	19,0	8	25	6,15
T300418	4	1/8	5,0	4	34,0	21,1	14	25	22,96
T3006M5	6	M5	2,0	4	22,5	22,0	8	5	6,00
T300618	6	1/8	5,0	5,5	34,0	24,3	14	25	23,41
T300614	6	1/4	6,0	6,5	42,0	25,5	17	25	43,38
T300818	8	1/8	5,0	5,5	34,0	24,8	14	25	23,65
T300814	8	1/4	6,0	6,5	42,0	26,5	17	25	44,10
T300838	8	3/8	6,5	7,5	52,0	28,0	20	10	72,00
T301014	10	1/4	6,0	6,5	42,0	28,4	17	25	44,00
T301038	10	3/8	6,5	7,5	52,0	29,9	20	10	72,00
T301238	12	3/8	6,5	7,5	52,0	31,4	20	10	74,00
T301212	12	1/2	10,0	9	61,0	34,9	26	10	74,00

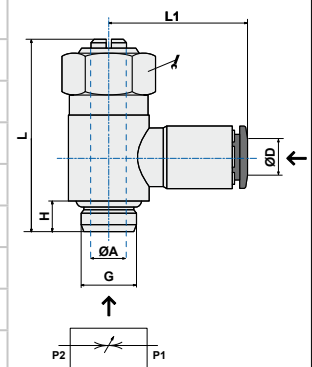

ART. **T28P**

Swivel flow regulator for valve



COD.	ØD	G	B	L	L1			
T2804M5P	4	M5	4	34	19,0	8,0	25	7,58
T280418P	4	1/8	5,5	43	21,1	9,0	25	17,26
T2806M5P	6	M5	4	34	22,0	8,0	25	8,00
T280618P	6	1/8	5,5	43	24,3	9,0	25	17,91
T280614P	6	1/4	6,5	50	25,5	12,0	25	34,79
T280638P	6	3/8	9,5	53	29,5	13,0	10	63,40
T280612P	6	1/2	12,0	61	30,2	13,0	10	104,00
T280818P	8	1/8	5,5	43	24,8	9,0	25	18,23
T280814P	8	1/4	6,5	50	26,5	12,0	25	34,76
T280838P	8	3/8	9,5	53	30,0	14,4	10	68,00
T280812P	8	1/2	12,0	61	35,8	14,4	10	104,20
T281018P	10	1/8	6,5	42	30,7	18,4	10	24,00
T281014P	10	1/4	6,5	50	28,4	12,0	25	35,50
T281038P	10	3/8	9,5	53	33,5	18,4	10	68,40
T281012P	10	1/2	12,0	61	36,5	18,4	10	108,00
T281214P	12	1/4	8,5	48	33,7	21,0	10	45,40
T281238P	12	3/8	9,5	53	35,5	19,0	10	70,40
T281212P	12	1/2	12,0	61	36,5	21,0	10	110,10

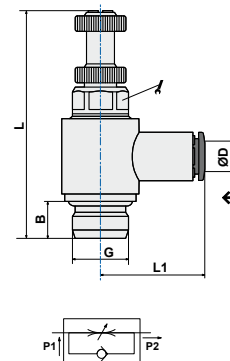

ART. **T29P**

Swivel flow regulator for cylinder



COD.	ØD	G	B	L	L1			
T2904M5P	4	M5	4	34	19,0	8,0	25	7,58
T290418P	4	1/8	5,5	43	21,1	9,0	25	17,26
T290414P	4	1/4	6,5	50	25,5	12,0	25	33,96
T2906M5P	6	M5	4	34	22,0	8,0	25	8,00
T290618P	6	1/8	5,5	43	24,3	9,0	25	17,72
T290614P	6	1/4	6,5	50	25,5	12,0	25	33,96
T290638P	6	3/8	9,5	53	29,5	13,0	10	63,40
T290612P	6	1/2	12,0	61	30,2	13,0	10	104,00
T290818P	8	1/8	5,5	43	24,8	9,0	25	18,04
T290814P	8	1/4	6,5	50	26,5	12,0	25	34,31
T290838P	8	3/8	9,5	53	30,0	14,4	10	68,00
T290812P	8	1/2	1,2	61	35,8	14,4	10	104,20
T291018P	10	1/8	6,5	42	30,7	18,4	10	24,00
T291014P	10	1/4	6,5	50	28,4	12,0	25	35,50
T291038P	10	3/8	9,5	53	33,5	18,4	10	68,40
T291012P	10	1/2	12,0	61	36,5	18,4	10	108,00
T291214P	12	1/4	8,5	48	33,7	21,0	10	45,40
T291238P	12	3/8	9,5	53	35,5	19,0	10	70,40
T291212P	12	1/2	12,0	61	36,5	21,0	10	110,10

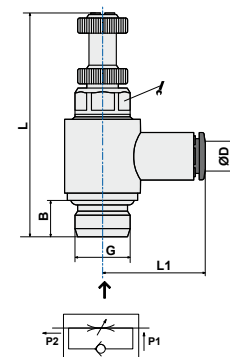

ART. **T30P**

Swivel bidirectional flow regulator



COD.	ØD	G	B	L	L1			
T3004M5P	4	M5	4	34	19,0	8	25	750
T300418P	4	1/8	5,5	43	21,1	9	25	17,31
T3006M5P	6	M5	4	34	22,0	8	25	8,00
T300618P	6	1/8	5,5	43	24,3	9	25	178,91
T300614P	6	1/4	6,5	50	25,5	12	25	34,79
T300818P	8	1/8	5,5	43	24,8	9	25	18,03
T300814P	8	1/4	6,5	50	26,5	12	25	34,31
T301014P	10	1/4	6,5	50	28,4	12	25	35,50

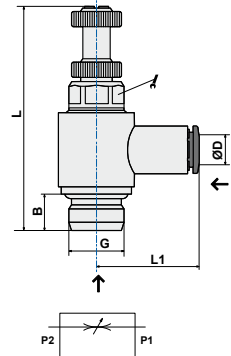

ART. **T31**

Flat flow regulator



COD.	ØD	B	G	F	S	Ød	J		
T310400	4	40,5	14,4	6,5	6,5	3,2	14	25	11,74
T310600	6	48,7	25,3	8,5	11,0	4,3	20	25	28,00
T310800	8	54,4	25,1	9,5	12,0	4,3	22	25	40,00
T311000	10	64,3	28,8	10,5	12,5	4,3	26	10	66,00
T311200	12	74,6	26,1	13,0	16,0	4,3	32	10	106,00

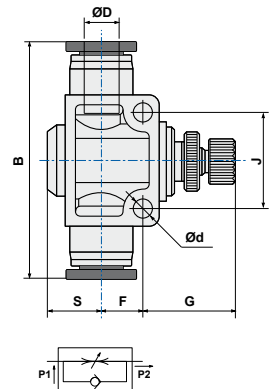

ART. **T29GS**

Speed controller for cylinders with lock cap



COD.	ØD	G	L1	L2	L3	L4	ØD1			
T29GS04M5	4	M5	3,5	18,0	28,0	18,0	9,5	9	25	4,00
T29GS0418	4	G1/8	5,5	21,5	33,5	24,0	13,0	13	25	12,00
T29GS06M5	6	M5	3,5	17,6	28,0	19,0	11,5	9	25	4,00
T29GS0618	6	G1/8	5,5	21,5	33,5	22,3	13,0	13	25	12,00
T29GS0614	6	G1/4	7,5	24,5	38,7	24,0	13,0	17	25	30,00
T29GS0818	8	G1/8	5,5	21,5	33,5	25,5	14,5	13	25	16,00
T29GS0814	8	G1/4	7,5	24,5	38,7	27,0	14,5	17	25	26,00

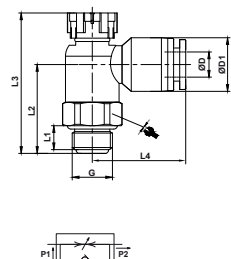

ART. **TB28**

Orientable flow regulator for valve



COD.	ØD	G	ØA	H	L	L1			
TB2804M5	4	M5	2,0	4	22,5	19,0	8	25	6,15
TB280418	4	1/8	5,0	5,5	34,0	21,1	14	25	22,96
TB2806M5	6	M5	2,0	4	22,5	22,0	8	25	6,00
TB280618	6	1/8	5,0	5,5	34,0	24,3	14	25	23,41
TB280614	6	1/4	6,0	6,5	42,0	25,5	17	25	43,42
TB280818	8	1/8	5,0	5,5	34,0	24,8	14	25	23,65
TB280814	8	1/4	6,0	6,5	42,0	26,5	17	25	43,72
TB280838	8	3/8	6,5	7,5	52,0	28,0	20	10	72,00
TB281014	10	1/4	6,0	6,5	42,0	28,4	17	25	44,00
TB281038	10	3/8	6,5	7,5	52,0	29,9	20	10	72,00
TB281238	12	3/8	6,5	7,5	52,0	31,4	20	10	74,00

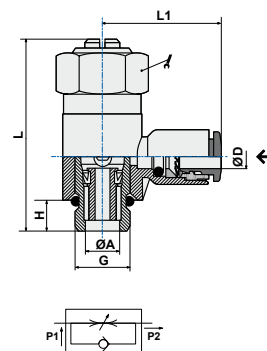

ART. **TB29**

Orientable flow regulator for cylinder



COD.	ØD	G	ØA	H	L1	L			
TB2904M5	4	M5	2,0	4	19,0	22,5	8	25	6,15
TB290418	4	1/8	5,0	4	21,1	34,0	14	25	22,96
TB2906M5	6	M5	2,0	4	22,0	22,5	8	25	6,00
TB290618	6	1/8	5,0	5,5	24,3	34,0	14	25	23,41
TB290614	6	1/4	6,0	6,5	25,5	42,0	17	25	43,42
TB290818	8	1/8	5,0	5,5	24,8	34,0	14	25	23,65
TB290814	8	1/4	6,0	6,5	26,5	42,0	17	25	43,72
TB290838	8	3/8	6,5	7,5	28,0	52,0	20	10	72,00
TB291014	10	1/4	6,0	6,5	28,4	42,0	17	25	44,00
TB291038	10	3/8	6,5	7,5	29,9	52,0	20	10	72,00
TB291012	10	1/2	10,0	9	30,0	61,0	26	10	120,00
TB291238	12	3/8	6,5	7,5	31,4	52,0	20	10	74,00
TB291212	12	1/2	10,0	9	34,9	61,0	26	10	122,00

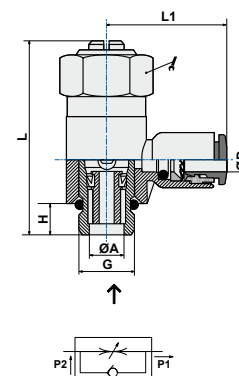

ART. **TB30**

Orientable bidirectional flow regulator



COD.	ØD	G	ØA	H	L1	L			
TB3004M5	4	M5	2,0	4	19,0	22,5	8	25	6,15
TB300418	4	1/8	5,0	4	21,1	34,0	14	25	22,96
TB3006M5	6	M5	2,0	4	22,0	22,5	8	5	6,00
TB300618	6	1/8	5,0	5,5	24,3	34,0	14	25	23,41
TB300614	6	1/4	6,0	6,5	25,5	42,0	17	25	43,42
TB300818	8	1/8	5,0	5,5	24,8	34,0	14	25	23,65
TB300814	8	1/4	6,0	6,5	26,5	42,0	17	25	43,72
TB300838	8	3/8	6,5	7,5	28,0	52,0	20	10	72,00
TB301014	10	1/4	6,0	6,5	28,4	42,0	17	25	44,00
TB301038	10	3/8	6,5	7,5	29,9	52,0	20	10	72,00
TB301238	12	3/8	6,5	7,5	31,4	52,0	20	10	74,00
TB301212	12	1/2	10,0	9	34,9	61,0	26	10	122,00

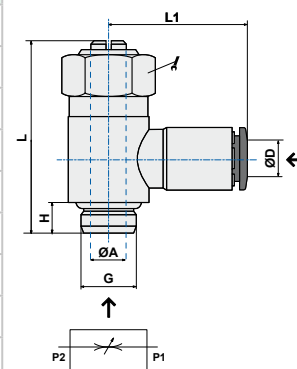

ART. **TB28P**

Swivel flow regulator for valve



COD.	ØD	G	B	L	L1			
TB2804M5P	4	M5	4	34	19,0	8,0	25	7,58
TB280418P	4	1/8	5,5	43	21,1	9,0	25	17,26
TB2806M5P	6	M5	4	34	22,0	8,0	25	8,00
TB280618P	6	1/8	5,5	43	24,3	9,0	25	17,91
TB280614P	6	1/4	6,5	50	25,5	12,0	25	34,79
TB280638P	6	3/8	9,5	53	29,5	13,0	10	63,40
TB280612P	6	1/2	12,0	61	30,2	13,0	10	104,00
TB280818P	8	1/8	5,5	43	24,8	9,0	25	18,23
TB280814P	8	1/4	6,5	50	26,5	12,0	25	34,76
TB280838P	8	3/8	9,5	53	30,0	14,4	10	68,00
TB280812P	8	1/2	1,2	61	35,8	14,4	10	104,20
TB281018P	10	1/8	6,5	42	30,7	18,4	10	24,00
TB281014P	10	1/4	6,5	50	28,4	12,0	25	35,50
TB281038P	10	3/8	9,5	53	33,5	18,4	10	68,40
TB281012P	10	1/2	12,0	61	36,5	18,4	10	108,00
TB281214P	12	1/4	8,5	48	33,7	21,0	10	45,40
TB281238P	12	3/8	9,5	53	35,5	19,0	10	70,40
TB281212P	12	1/2	12,0	61	36,5	21,0	10	110,10

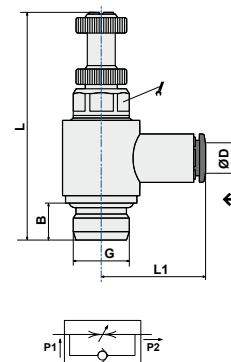

ART. **TB29P**

Swivel flow regulator for cylinder



COD.	ØD	G	B	L	L1			
TB2904M5P	4	M5	4	34	15,0	8,0	25	7,58
TB290418P	4	1/8	5,5	43	21,1	9,0	25	17,26
TB290414P	4	1/4	6,5	50	25,5	12,0	25	33,96
TB2906M5P	6	M5	4	34	22,0	8,0	25	8,00
TB290618P	6	1/8	5,5	43	24,3	9,0	25	17,91
TB290614P	6	1/4	6,5	50	25,5	12,0	25	34,79
TB290638P	6	3/8	9,5	53	29,5	13,0	10	63,40
TB290612P	6	1/2	12,0	61	30,2	13,0	10	104,00
TB290818P	8	1/8	5,5	43	24,8	9,0	25	18,23
TB290814P	8	1/4	6,5	50	26,5	12,0	25	34,76
TB290838P	8	3/8	9,5	53	30,0	14,4	10	68,00
TB290812P	8	1/2	1,2	61	35,8	14,4	10	104,20
TB291018P	10	1/8	6,5	42	30,7	18,4	10	24,00
TB291014P	10	1/4	6,5	50	28,4	12,0	25	35,50
TB291038P	10	3/8	9,5	53	33,5	18,4	10	68,40
TB291012P	10	1/2	12,0	61	36,5	18,4	10	108,00
T2B91214P	12	1/4	8,5	48	33,7	21,0	10	45,40
TB291238P	12	3/8	9,5	53	35,5	19,0	10	70,40
TB291212P	12	1/2	12,0	61	36,5	21,0	10	110,10

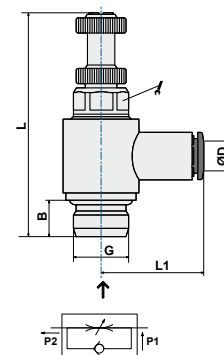

ART. **TB30P**

Swivel bidirectional flow regulator



COD.	ØD	G	B	L	L1			
TB3004M5P	4	M5	4	34	19,0	8	25	16,15
TB300418P	4	1/8	5,5	43	21,1	9	25	22,96
TB3006M5P	6	M5	4	34	22,0	8	25	6,00
TB300618P	6	1/8	5,5	43	24,3	9	25	23,41
TB300614P	6	1/4	6,5	50	25,5	12	25	43,42
TB300818P	8	1/8	5,5	43	24,8	9	25	23,65
TB300814P	8	1/4	6,5	50	26,5	12	25	43,72
TB301014P	10	1/4	6,5	50	28,4	12	25	44,00

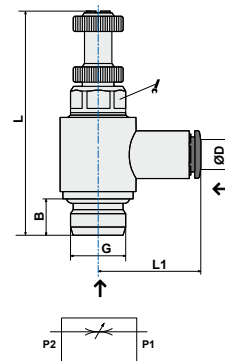

ART. **TB31**

Flat flow regulator



COD.	ØD	B	G	F	S	Ød	J		
TB310400	4	40,5	14,4	6,5	6,5	3,2	14	25	11,74
TB310600	6	48,7	25,3	8,5	11,0	4,3	20	25	28,00
TB310800	8	54,4	25,1	9,5	12,0	4,3	22	25	40,00
TB311000	10	64,3	28,8	10,5	12,5	4,3	26	10	66,00
TB311200	12	74,6	26,1	13,0	16,0	4,3	32	10	106,00

