

Ball taps

Series 600



Ball taps made of brass alloy CW164N (nickel-plated) from hexagonal bar. Suitable for a wide range of regulation: pneumatic/oleodynamic, hydraulic and medium/low vacuum systems.

Technical sheet

FLUIDS		Compressed air (for different fluid please contact our Technical Dept.)
APPLICATIONS		Pneumatic, oleodynamic and hydraulic circuits
SUGGESTED TUBES		Plastic: TPU, PA, PE, etc. Metal: copper, aluminium, steel
TEMPERATURE AND PRESSURE	Working temperature	from -20°C to +80°C
	Max working pressure	20 bar
THREAD TYPE		BSPP pipe thread ISO 228
MATERIALS	Ball, ogive, nut, ring nut and shaft	Brass UNI EN 12164 CW614N (nickel plated)
	Body	Brass UNI EN 12165 CW617N (nickel plated)
	Handle	PA66 plastic material. Lever colours: Standard black. It is available in the following colours by adding the following letters at the end of the code: B=Blue, R=Red, G=Yellow, T= Chrome-plated
	Washer ball seat	PTFE
	O-Ring	NBR 70

ART. **600**

F/F ball tap with lever



COD.	G	ØP	L	L1	L3			
6001818	1/8	8	39	9	27,2	20	1	80,04
6001414	1/4	8	39	9	27,2	20	1	81,13
6003838	3/8	8	42	9,9	27,1	20	1	73,65
6001212	1/2	10	47	11,7	29,4	24	1	109,35
6003434	3/4	13,5	54	12	32	30	1	188,85

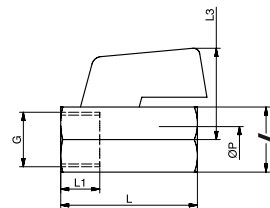

ART. **601**

F/F screwdriver cut ball tap



COD.	G	I	L	ØA	h			
6011818	1/8	9	39	8	13	20	1	83,99
6011414	1/4	9	39	8	13	20	1	88,50
6013838	3/8	9,9	42	8	13	20	1	81,72
6011212	1/2	11,7	47	10	15,4	24	1	124,00
6013434	3/4	12	54	13,5	18	30	1	190,00

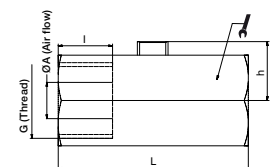

ART. **602**

Long lever F/F ball tap



COD.	G	I	L	ØP	h			
6021818	1/8	9	39	8	31,3	20	1	83,26
6021414	1/4	9	39	8	31,3	20	1	95,52
6023838	3/8	9,9	42	8	31,3	20	1	88,75
6021212	1/2	11,7	47	10	33,8	24	1	131,03
6023434	3/4	12	54	13,5	36,4	30	1	197,00

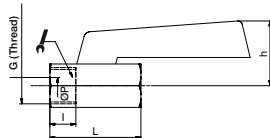

ART. **605**

M/F ball tap with lever



COD.	G	G1	H1	H	L	h			
6051818	1/8	1/8	9	10	39	27,2	20	1	80,11
6051414	1/4	1/4	9,2	11	39	27,2	20	1	80,79
6053838	3/8	3/8	10,2	9,8	40	27,2	20	1	72,34
6051212	1/2	1/2	12,2	11,6	45	29,5	24	1	116,56
6053434	3/4	3/4	14	12,2	51	32	30	1	172,63

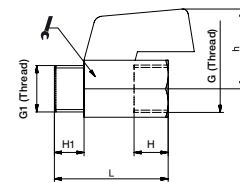

ART. **606**

M/F screwdriver cut ball tap



COD.	G	G1	L1	L2	L	P	h			
6061818	1/8	9,0	10,0	39,0	8,0	13,0	20	20	1	83,32
6061414	1/4	9,2	11,0	39,0	8,0	13,0	20	20	1	79,52
6063838	3/8	10,2	9,8	40,0	8,0	13,0	20	20	1	77,55
6061212	1/2	12,2	11,6	45,0	10,0	15,4	24	24	1	100,51
6063434	3/4	14,0	12,2	51,0	13,5	17,9	30	30	1	170,00

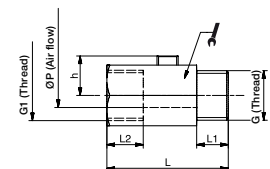

ART. **607**

Long lever M/F ball tap



COD.	G	G1	H1	H	ØP	h			
6071818	1/8	1/8	9,0	10	8	20	20	1	83,32
6071414	1/4	1/4	9,2	11	8	20	20	1	79,52
6073838	3/8	3/8	10,2	10	8	20	20	1	77,55
6071212	1/2	1/2	12,2	11,6	10	24	24	1	100,51
6073434	3/4	3/4	14,0	14	13,5	30	30	1	180,00

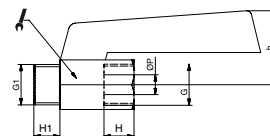

ART. **610**

M/M ball tap with lever



COD.	G	G1	L1	L	P	h			
6101414	1/4	1/4	9,0	40,4	8,0	27,2	20	1	65,15
6103838	3/8	3/8	10,0	42,4	8,0	27,4	20	1	70,32
6101212	1/2	1/2	11,6	49,7	10,0	29,4	24	1	106,07

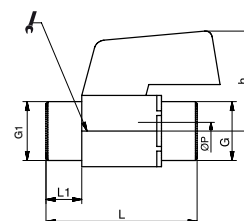

ART. **611**

M/M screwdriver cut ball tap



COD.	G	G1	L1	L2	L	ØP	h			
6111414	1/4	1/4	9,0	9,0	40,4	8,0	12,9	20	1	64,35
6113838	3/8	3/8	10,0	10,0	42,4	8,0	12,9	20	1	64,94
6111212	1/2	1/2	11,6	11,6	49,7	10,0	15,4	24	1	99,44

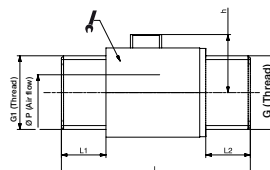

ART. **650**

F/F ball tap with lever



COD.	G	L1	L	ØP	L3			
6501414	1/4	9,0	35,0	5,5	26,1	18	1	53,69
6503838	3/8	7,0	38,5	8,0	27,0	20	1	64,94
6501212	1/2	8,5	42,0	10,0	28,9	24	1	99,44

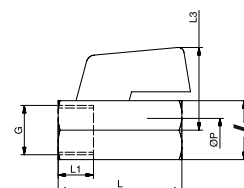

ART. **655**

M/F ball tap with lever



COD.	G	G1	H1	H	L	P	h			
6551414	1/4	1/4	9,0	7,0	35,0	5,5	26,1	18	1	51,00
6553838	3/8	3/8	10,0	7,0	38,5	8,0	27,0	20	1	64,09
6551212	1/2	1/2	9,0	9,3	32,0	10,0	28,9	24	1	86,62

