



Series 514 High Performance

NAMUR valves are 5/2, 4/2 and 3/2 valves and electrovalves, piloted electrically or pneumatically, utilised primarily to operate rotary actuators and wherever there is a NAMUR standard installation plan.

The product is classified for use in potentially explosive atmospheres (Directive 2014/34/EU).

NAMUR valves have been developed using the latest, technical design solutions which guarantee flexibility and an increased flow rate capacity exceeding that of traditional, spool valves.

Innovative materials guarantee high performances also in critical environment conditions.

Available NPT and BSPT connections.

The solenoid valves are available with protection classes for zones 2-22, 1-21 solenoids Ex ec, Ex mb, Ex ia, international approvals IECEx, FM and CSA.

1
AIR DISTRIBUTION



Construction characteristics

Body	Aluminium
Spacers	Technopolymer
Seals	Nitrile rubber
Springs	Stainless Steel
Operators	Technopolymer
Spools	Steel
Screws	Zinc coated Steel / Stainless steel

“NAMUR” interface dimensions:
according to standard (VDI/VDE 3847 July 2003)

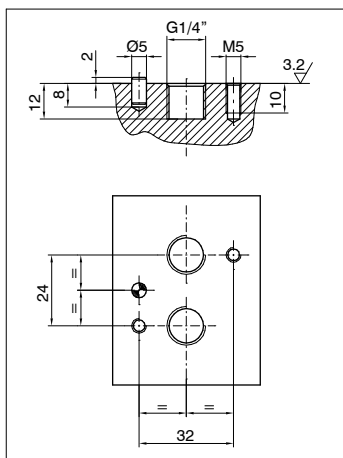

Certifications available





Order codes

51 4 . 52 . 00 . 39 . B04

Model
: Standard valve
X : ATEX valve
(-20°C ... +40°C) - only with solenoid coils "B##", "C##" e "X##"
(-30°C ... +50°C) - only with solenoid coils "MHC", "MH#"

Connections
4 : G1/4" - supplied with plate
6 : 1/4" NPT - supplied with plate

Type
32 : 3 ways, 2 positions
42 : 4 ways, 2 positions
52 : 5 ways, 2 positions
92 : Universal kit version (4/2 and 5/2)
93 : Universal kit version (3/2 and 5/2)

Version
16 : Pneumatic-Differential
18 : Pneumatic-Pneumatic
19 : Pneumatic-Spring
35 : Solenoid-Solenoid
36 : Solenoid-Differential
39 : Solenoid-Spring

Voltages	Valve marking with ATEX solenoid coil	Protection method of the ATEX solenoid coil
B00 : Ø10 stem without solenoid coil to be used with the following solenoid coils	II 2G Ex h IIC T5 Gb X II 2D Ex h IIIC T96°C Db X	/
B04 : 12 V DC - for all models B05 : 24 V DC - for all models B09 : 24 V DC (2W) - only for standard model B56 : 24 V AC (50-60 Hz) - for all models B57 : 110 V AC (50-60 Hz) - for all models B58 : 230 V AC (50-60 Hz) - for all models C04 : 12 V DC - for all models C05 : 24 V DC - for all models C09 : 24 V DC (2W) - only for standard model C56 : 24 V AC (50-60 Hz) - for all models C57 : 110 V AC (50-60 Hz) - for all models C58 : 230 V AC (50-60 Hz) - for all models	II 3G Ex h IIC T4 Gc X II 3D Ex h IIIC T120°C Dc X IP65	Ex ec Ex tc
F00 : Ø9 stem without solenoid coil to be used with the following solenoid coils	II 2G Ex h IIC T5 Gb X II 2D Ex h IIIC T96°C Db X	/
X05 : 24 V DC - only for ATEX model X56 : 24 V AC (50-60 Hz) - only for ATEX model X57 : 110 V AC (50-60 Hz) - only for ATEX model X58 : 230 V AC (50-60 Hz) - only for ATEX model	II 2G Ex h IIC T4 Gb X II 2D Ex h IIIC T135°C Db X IP65	Ex mb
MHC : 24 V DC T6 - only for ATEX model complete with connector	II 2G Ex h IIB/IIC T4 Gb X II 2D Ex h IIIC T130°C Db X IP65	Ex ia
MH4 : 24 V DC T4 - only for ATEX model MH6 : 24 V DC T6 - only for ATEX model	II 2G Ex h IIB/IIC T4 Gb X	Ex ia
Electrical specifications for intrinsically safety Group IIC Ui max= 28 V, li max= 115 mA, Pi max= 1,6 W Group IIB Ui max= 32 V, li max= 195 mA, Pi max= 1,6 W		
Voltages	Solenoid coil marking	
L04 : 12 V DC - only for FM APPROVED model L05 : 24 V DC - only for FM APPROVED model L39 : 120 V AC - only for FM APPROVED model L41 : 240 V AC - only for FM APPROVED model		
FM APPROVED valve (-20°C ... +50°C) - only with solenoid coils "L##"		

Temperature options
: Standard valve (-10°C ... +50°C)
LT : Low temperature (-30°C ... +50°C)

Example: 514.52.00.39.B04: Standard valve, G1/4" connections supplied with plate, solenoid-spring 5 ways, 12 VDC solenoid coil

1
AIR DISTRIBUTION



Pneumatic-Differential

CODING: M51C.T.00.16C

Operational characteristics	
Fluid	Filtered air. No lubrication needed, if applied it shall be continuous
Max. working pressure (bar)	10
Temperature °C	See order codes page
Flow rate at 6 bar with $\Delta p=1$ (NI/min)	1100
Orifice size (mm)	8
Working ports size	G 1/4" - 1/4" NPT
Cv	1,11
kv	16,66

M	MODEL
	= Standard valve
	X = ATEX valve
	CONNECTIONS
C	4 = G1/4"
	6 = 1/4" NPT
	TYPE
T	32 = 3 ways, 2 positions
	42 = 4 ways, 2 positions
	52 = 5 ways, 2 positions
	TEMPERATURE OPTION
C	SEE ORDER CODES PAGE

Minimum pilot pressure 2,5 bar
Maximum fitting torque 9 N/m

AIR DISTRIBUTION

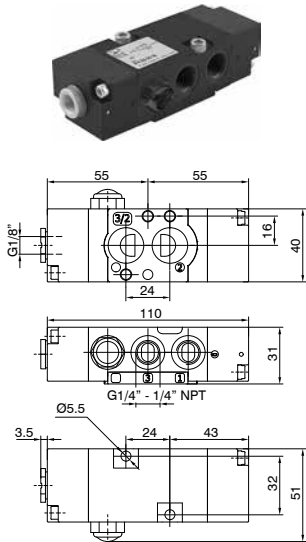

M51C.32.00.16C Weight 240 g

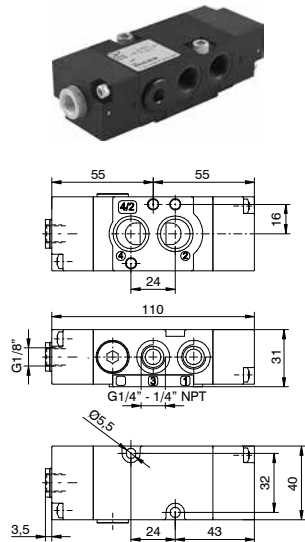
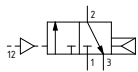

M51C.42.00.16C Weight 240 g

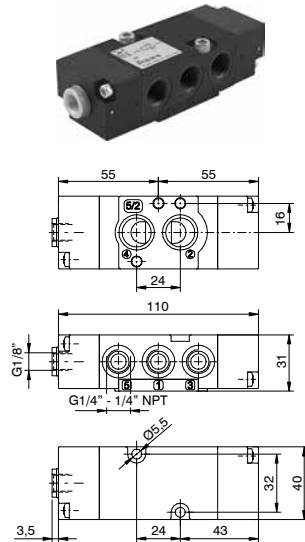
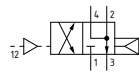

M51C.52.00.16C Weight 235 g

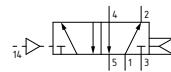

Pneumatic-Pneumatic

CODING: M51C.T.00.18C

Operational characteristics	
Fluid	Filtered air. No lubrication needed, if applied it shall be continuous
Max. working pressure (bar)	10
Temperature °C	See order codes page
Flow rate at 6 bar with $\Delta p=1$ (NI/min)	1100
Orifice size (mm)	8
Working ports size	G 1/4" - 1/4" NPT
Cv	1,11
kv	16,66

M	MODEL
	= Standard valve
	X = ATEX valve
	CONNECTIONS
C	4 = G1/4"
	6 = 1/4" NPT
	TYPE
T	32 = 3 ways, 2 positions
	42 = 4 ways, 2 positions
	52 = 5 ways, 2 positions
	TEMPERATURE OPTION
C	SEE ORDER CODES PAGE

Minimum pilot pressure 2,5 bar
Maximum fitting torque 9 N/m

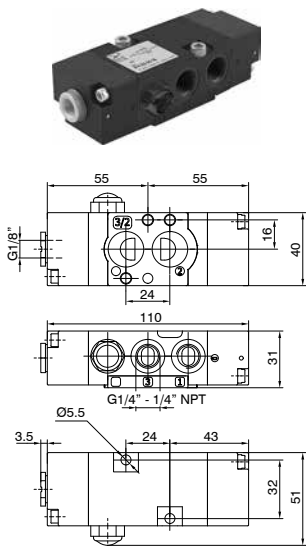

M51C.32.00.18C Weight 240 g

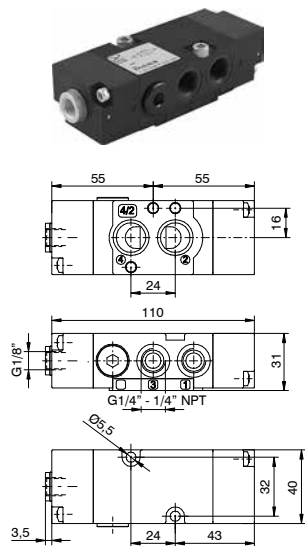
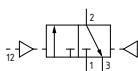

M51C.42.00.18C Weight 240 g

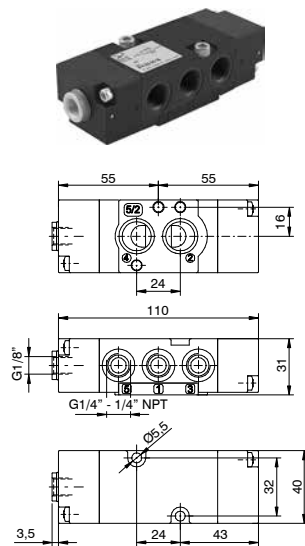
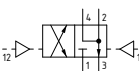

M51C.52.00.18C Weight 235 g

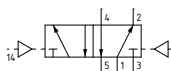







Pneumatic-Spring

CODING: M51C.T.00.19

Operational characteristics	
Fluid	Filtered air. No lubrication needed, if applied it shall be continuous
Max. working pressure (bar)	10
Temperature °C	See order codes page
Flow rate at 6 bar with Δp=1 (NI/min)	1100
Orifice size (mm)	8
Working ports size	G 1/4" - 1/4" NPT
Cv	1,11
kv	16,66

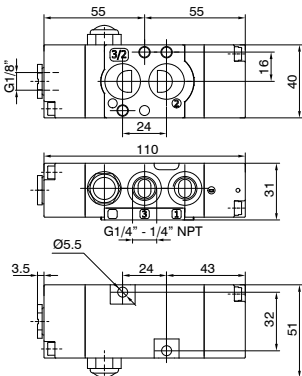
M	MODEL = Standard valve X = ATEX valve
C	CONNECTIONS 4 = G1/4" 6 = 1/4" NPT
T	TYPE 32 = 3 ways, 2 positions 42 = 4 ways, 2 positions 52 = 5 ways, 2 positions
○	TEMPERATURE OPTION SEE ORDER CODES PAGE

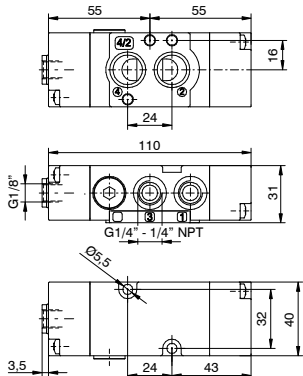
Minimum pilot pressure 2,5 bar
Maximum fitting torque 9 N/m

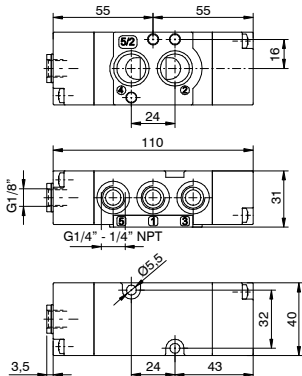
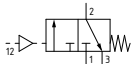
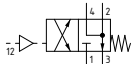
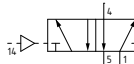
 	 	 
M51C.32.00.19 Weight 240 g	M51C.42.00.19 Weight 240 g	M51C.52.00.19 Weight 235 g
		





Solenoid-Solenoid

CODING: M51C.T.00.35.V

Operational characteristics	
Fluid	Filtered air. No lubrication needed, if applied it shall be continuous
Max. working pressure (bar)	10
Temperature °C	See order codes page
Flow rate at 6 bar with Δp=1 (NI/min)	1100
Orifice size (mm)	8
Working ports size	G 1/4" - 1/4" NPT
Cv	1,11
kv	16,66

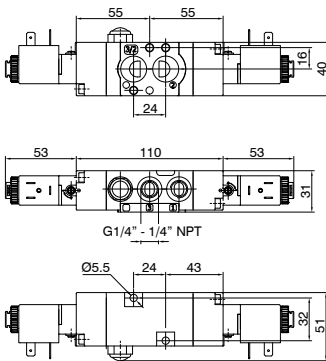
M	MODEL = Standard valve X = ATEX valve
C	CONNECTIONS 4 = G1/4" 6 = 1/4" NPT
T	TYPE 32 = 3 ways, 2 positions 42 = 4 ways, 2 positions 52 = 5 ways, 2 positions
V	VOLTAGE SEE ORDER CODES PAGE
○	TEMPERATURE OPTION SEE ORDER CODES PAGE

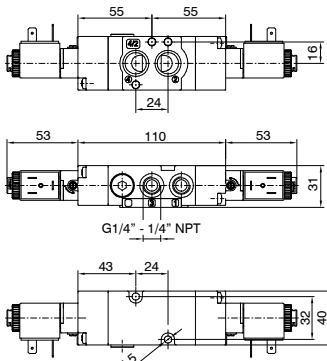
Minimum pilot pressure 2,5 bar
Maximum fitting torque 9 N/m

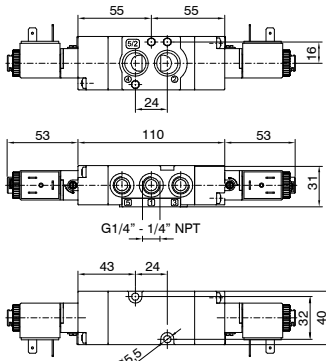
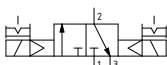
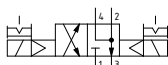
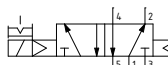
 	 	 
M51C.32.00.35.V Weight 410 g	M51C.42.00.35.V Weight 410 g	M51C.52.00.35.V Weight 405 g
		



CODING: M51C.T.00.36.VO

Solenoid-Differential

Operational characteristics	
Fluid	Filtered air. No lubrication needed, if applied it shall be continuous
Max. working pressure (bar)	10
Temperature °C	See order codes page
Flow rate at 6 bar with $\Delta p=1$ (NI/min)	1100
Orifice size (mm)	8
Working ports size	G 1/4" - 1/4" NPT
Cv	1,11
kv	16,66

M	MODEL
	= Standard valve
	X = ATEX valve
	CONNECTIONS
C	4 = G1/4"
	6 = 1/4" NPT
	TYPE
T	32 = 3 ways, 2 positions
	42 = 4 ways, 2 positions
	52 = 5 ways, 2 positions
	VOLTAGE
V	SEE ORDER CODES PAGE
	TEMPERATURE OPTION
O	SEE ORDER CODES PAGE

Minimum pilot pressure 2,5 bar
Maximum fitting torque 9 N/m

AIR DISTRIBUTION

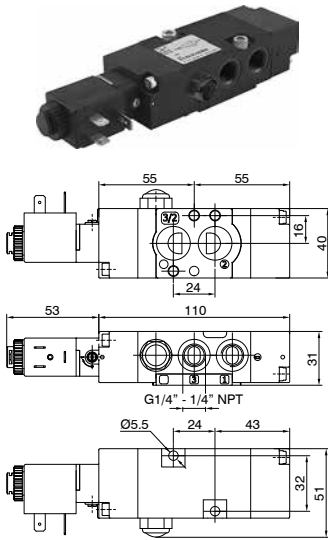

M51C.32.00.36.VO Weight 330 g

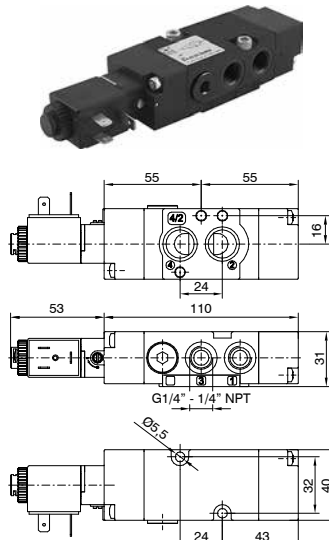
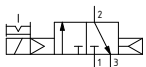

M51C.42.00.36.VO Weight 330 g

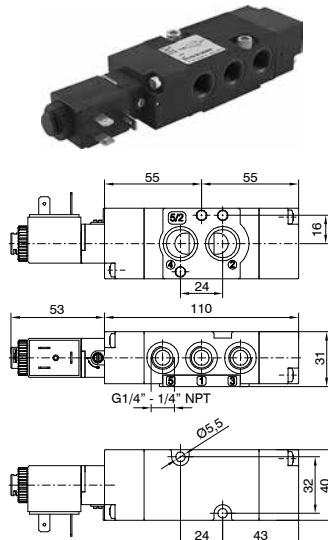
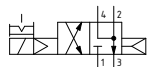

M51C.52.00.36.VO Weight 325 g

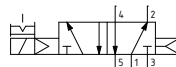

Solenoid-Spring

Operational characteristics	
Fluid	Filtered air. No lubrication needed, if applied it shall be continuous
Max. working pressure (bar)	10
Temperature °C	See order codes page
Flow rate at 6 bar with $\Delta p=1$ (NI/min)	1100
Orifice size (mm)	8
Working ports size	G 1/4" - 1/4" NPT
Cv	1,11
kv	16,66

CODING: M51C.T.00.39.VO

M	MODEL
	= Standard valve
	X = ATEX valve
	CONNECTIONS
C	4 = G1/4"
	6 = 1/4" NPT
	TYPE
T	32 = 3 ways, 2 positions
	42 = 4 ways, 2 positions
	52 = 5 ways, 2 positions
	VOLTAGE
V	SEE ORDER CODES PAGE
	TEMPERATURE OPTION
O	SEE ORDER CODES PAGE

Minimum pilot pressure 2,5 bar
Maximum fitting torque 9 N/m

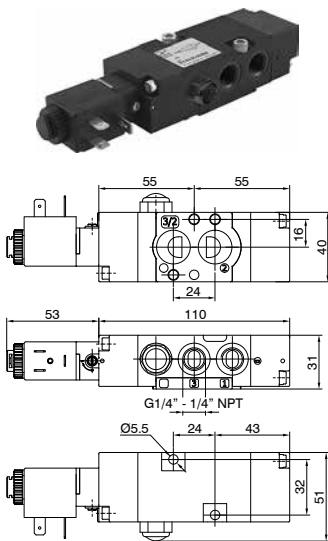

M51C.32.00.39.VO Weight 330 g

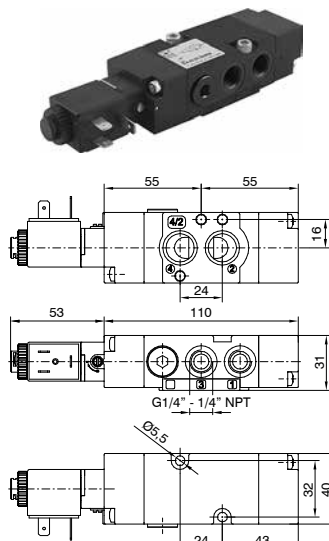
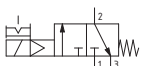

M51C.42.00.39.VO Weight 330 g

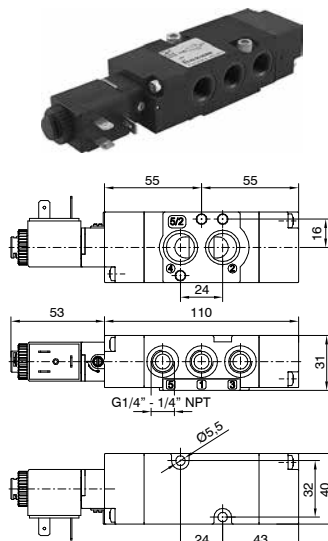
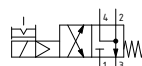

M51C.52.00.39.VO Weight 325 g

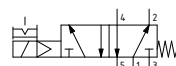

Universal kit version (4/2 and 5/2)

Operational characteristics	
Fluid	Filtered air. No lubrication needed, if applied it shall be continuous
Max. working pressure (bar)	10
Temperature °C	See order codes page
Flow rate at 6 bar with $\Delta p=1$ (NI/min)	1100
Orifice size (mm)	8
Working ports size	G 1/4" - 1/4" NPT
Cv	1,11
kv	16,66

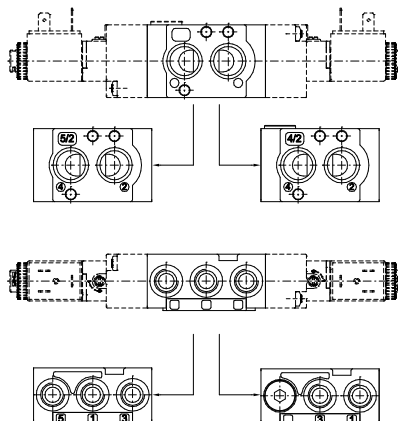

CODING: M51C.92.00.V.T.O

M	MODEL = Standard valve X = ATEX valve
C	CONNECTIONS 4 = G1/4" 6 = 1/4" NPT
V	VERSION 16 = Pneumatic-Differential 18 = Pneumatic - Pneumatic 19 = Pneumatic - Spring 35 = Solenoid - Solenoid 36 = Solenoid - Differential 39 = Solenoid - Spring
T	VOLTAGE SEE ORDER CODES PAGE
O	TEMPERATURE OPTION SEE ORDER CODES PAGE

Minimum pilot pressure 2,5 bar
Maximum fitting torque 9 N/m
To change a 5/2 valve into a 4/2: simply replace the bottom plate with the one included in the universal kit (cod. 51C.92...) and by plugging port 5

M51C.92.00.V.T.O Weight 405 g



Universal kit version (3/2 and 5/2)

Operational characteristics	
Fluid	Filtered air. No lubrication needed, if applied it shall be continuous
Max. working pressure (bar)	10
Temperature °C	See order codes page
Flow rate at 6 bar with $\Delta p=1$ (NI/min)	1100
Orifice size (mm)	8
Working ports size	G 1/4" - 1/4" NPT
Cv	1,11
kv	16,66

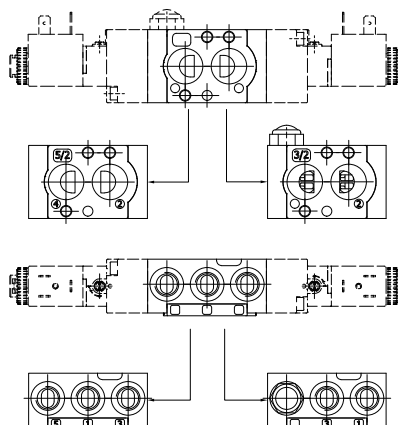

CODING: M51C.93.00.V.T.O

M	MODEL = Standard valve X = ATEX valve
C	CONNECTIONS 4 = G1/4" 6 = 1/4" NPT
V	VERSION 16 = Pneumatic-Differential 18 = Pneumatic - Pneumatic 19 = Pneumatic - Spring 35 = Solenoid - Solenoid 36 = Solenoid - Differential 39 = Solenoid - Spring
T	VOLTAGE SEE ORDER CODES PAGE
O	TEMPERATURE OPTION SEE ORDER CODES PAGE

Minimum pilot pressure 2,5 bar
Maximum fitting torque 9 N/m
To change a 5/2 valve into a 3/2: simply replace the bottom plate with the one included in the universal kit (cod. 51C.93...) and by applying a silencer to connection 5

M51C.93.00.V.T.O Weight 405 g

