

# ST LINE

## Sicomat

ED. 3  
UPD. 01



# Alusic

COMPRESSED AIR DISTRIBUTION

DISTRIBUZIONE ARIA COMPRESSA  
DISTRIBUCIÓN DE AIRE COMPRIMIDO  
DISTRIBUTION D'AIR COMPRIMÉ  
DRUCKLUFTVERTEILUNG

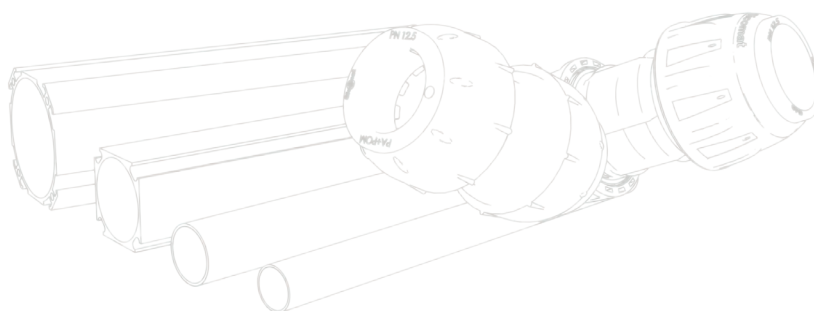



 **Alusic**

**SR** SERIES

**PIPES AND FITTINGS FOR COMPRESSED AIR**

TUBI E RACCORDI PER ARIA COMPRESSA

TUBOS Y RACORES PARA AIRE COMPRIMIDO

TUBES ET RACCORDS POUR AIR COMPRIMÉ

ROHRE UND VERBINDER FÜR DIE DRUCKLUFTVERTEILUNG



## PIPES AND FITTINGS FOR COMPRESSED AIR

TUBI E RACCORDI PER ARIA COMPRESSA / TUBOS Y RACORES PARA AIRE COMPRIMIDO  
TUBES ET RACCORDS POUR AIR COMPRIMÉ / ROHRE UND VERBINDER FÜR DIE DRUCKLUFTVERTEILUNG

Ø63 Ø50 Ø40 Ø32 Ø25 Ø20

### Available diameters for the SR Series

Diametri disponibili per la SR Series  
Diámetros disponibles para la Serie SR  
Diamètres disponibles pour la Série SR  
Verfügbare Durchmesser für die SR-Serie

### Hidden diameters are available for the SK Series

I diametri nascosti sono disponibili per la serie SK  
Los diámetros ocultos están disponibles para la Serie SK  
Diamètres Les diamètres cachés sont disponibles pour la Série SK  
Versteckte Durchmesser sind für die SK-Serie verfügbar

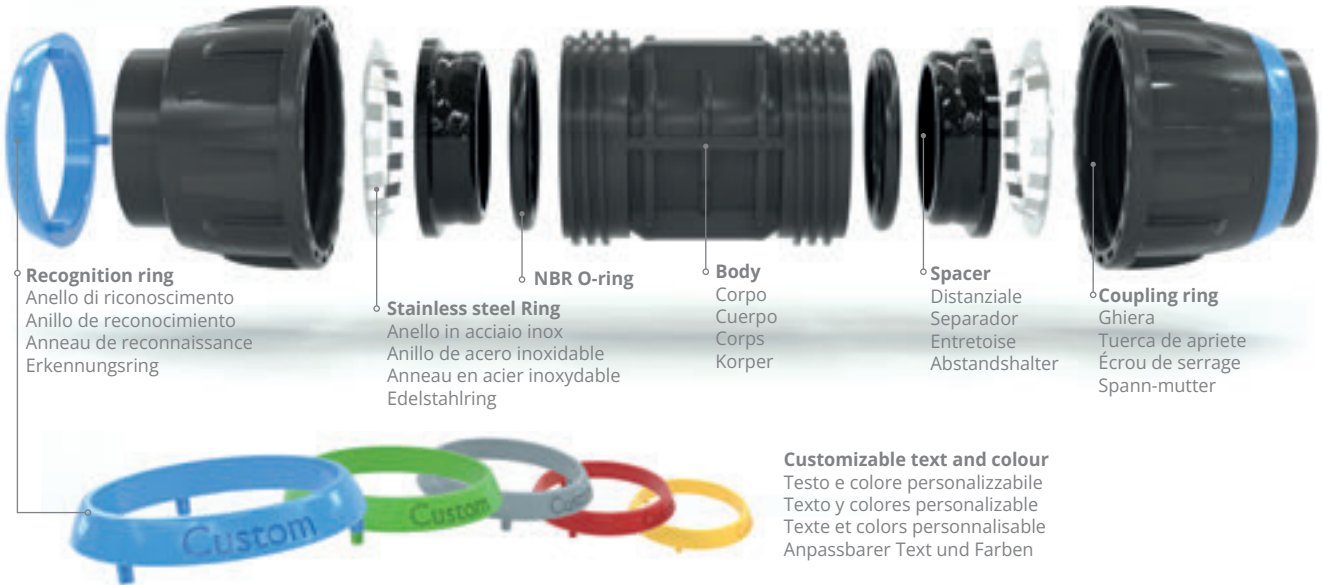

**Recognition ring**  
Anello di riconoscimento  
Anillo de reconocimiento  
Anneau de reconnaissance  
Erkennungsring

**Stainless steel Ring**  
Anello in acciaio inox  
Anillo de acero inoxidable  
Anneau en acier inoxydable  
Edelstahling

**NBR O-ring**

**Body**  
Corpo  
Cuerpo  
Corps  
Körper

**Spacer**  
Distanziale  
Separador  
Entretoise  
Abstandshalter

**Coupling ring**  
Ghiera  
Tuerca de apriete  
Écrou de serrage  
Spann-mutter

### Customizable text and colour

Testo e colore personalizzabile  
Texto y colores personalizable  
Texte et colors personnalisable  
Anpassbarer Text und Farben

## ASSEMBLY

ALLESTIMENTO / MONTAJE / INSTALLATION / MONTAGE

1



**Measure of insertion length**  
Segnatura inserimento tubo  
Marca de introducción del tubo  
Marquage introduction de tube  
Vorzeichnung Rohreinsetzung

2



**Insert the fitting up to mark**  
Inserire il raccordo fino al segno  
Introducir el racor hasta la señal  
Introduire le raccord jusqu'au repère  
Den Verbinder bis zum Zeichen einsetzen

3

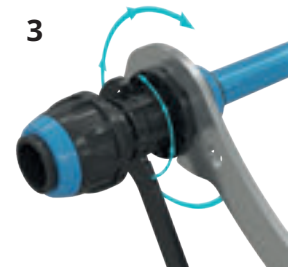

**Locking the fitting**  
Serratura del raccordo con le due chiavi  
Cierre del racor  
Fermeture du raccord  
Schliessung des Verbinders

## CLASSIC AND EVO COUPLING

GHIERE CLASSIC E EVO / TUERCAS DE FIJACIÓN CLASSIC Y EVO  
ÉCROUS DE SERRAGE CLASSIC ET EVO / CLASSIC UND EVO SICHERUNGSMUTTERN

CLASSIC



**Classic lock nut, available in 3 colors**  
Ghiera classica, disponibile in 3 colorazioni.  
Tuerca de fijación clásica, disponible en 3 colores  
Écrou de serrage classique, disponible en 3 coloris  
Klassische Sicherungsmutter, erhältlich in 3 Farben

EVO



**New design, with black body and colored insert. Available in 3 colors**  
Nuovo design, con corpo nero inserto colorato. Disponibili 3 colori.  
Nuevo diseño, con cuerpo negro e inserto de color. Disponible en 3 colores  
Nouveau design, avec corps noir et insert coloré. Disponible en 3 coloris  
Neues Design, mit schwarzem Körper und farbigem Einsatz. Erhältlich in 3 Farben



**ALUMINIUM PIPE**  
 TUBO IN ALLUMINIO  
 TUBO DE ALUMINIO  
 TUBE EN ALUMINIUM  
 ALUMINIUMROHR

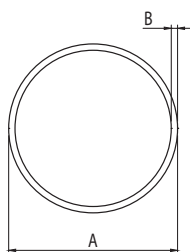

Code	Color	A	B	Length (m)	(Kg/m)
059.020.017	A	20	1,5	4	0,24
059.025.022	A	25	1,5	4	0,27
059.032.029	A	32	1,5	4	0,35
059.040.037	A	40	1,5	4	0,46
059.050.046	A	50	2	4	0,76
059.063.059	A	63	2	4	0,99
059.020.017G	A	20	1,5	4	0,24
059.025.022G	A	25	1,5	4	0,27
059.032.029G	A	32	1,5	4	0,35
059.040.037G	A	40	1,5	4	0,46
059.050.046G	A	50	2	4	0,76
059.063.059G	A	63	2	4	0,99
059.025.022V	A	25	1,5	4	0,27
059.040.037V	A	40	1,5	4	0,46
059.020.017-6	A	20	1,5	6	0,24
059.025.022-6	A	25	1,5	6	0,27
059.032.029-6	A	32	1,5	6	0,35
059.040.037-6	A	40	1,5	6	0,46
059.050.046-6	A	50	2	6	0,76
059.063.059-6	A	63	2	6	0,99
059.020.017-6G	A	20	1,5	6	0,24
059.025.022-6G	A	25	1,5	6	0,27
059.032.029-6G	A	32	1,5	6	0,35
059.040.037-6G	A	40	1,5	6	0,46
059.050.046-6G	A	50	2	6	0,76
059.063.059-6G	A	63	2	6	0,99
059.025.022-6V	A	25	1,5	6	0,27
059.040.037-6V	A	40	1,5	6	0,46

**Powder-coated aluminium** / Alluminio verniciato / Aluminio pintado  
 Aluminium peint / Lackiertes Aluminium

**DROP BENDS**

CURVE DI CALATA  
CURVAS DE BAJADA  
TUBES PREFORMÉS  
SCHWANENHALS-ROHRBOGEN

Code	Color	Ø	A	B	C	D			(g)
<b>059.020.100</b>		20	160	500	160	340			197
<b>059.025.100</b>		25	195	600	195	405			267
<b>059.025.100V</b>		25	195	600	195	405			267

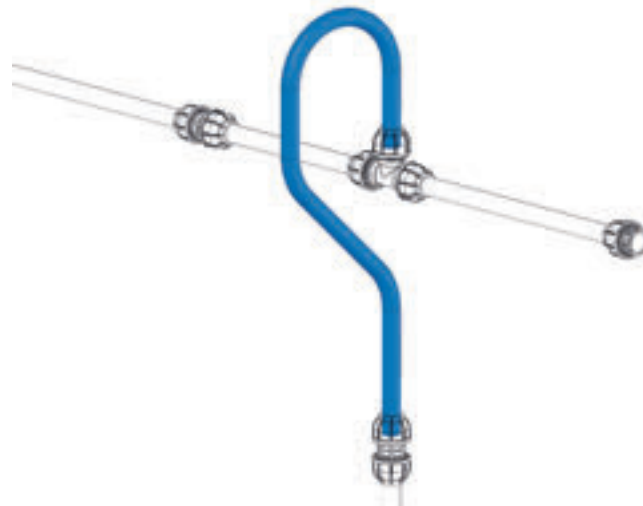
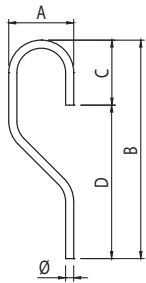
**BEND PREFORMED PIPES**

CURVE SPECIALI  
CURVAS ESPECIALES  
COUDES SPÉCIAUX  
SPEZIALE-FORMTEILE

Code	Color	Ø	A	B	C	D			(g)
<b>059.020.101</b>		20	150						72
<b>059.025.101</b>		25	160						86
<b>059.025.101V</b>		25	160						86

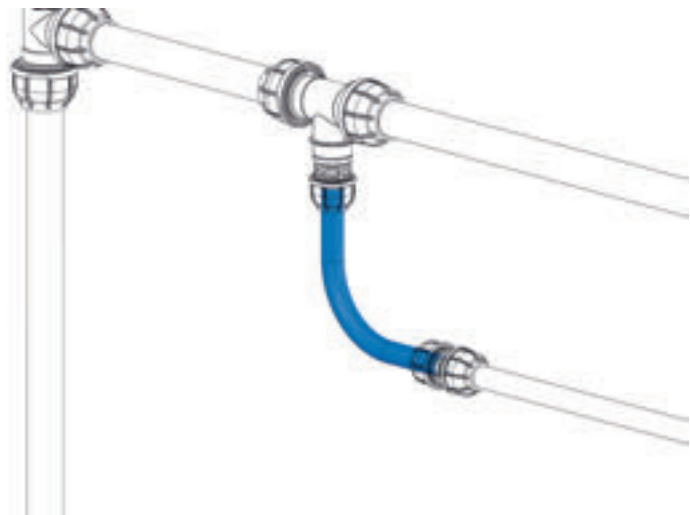
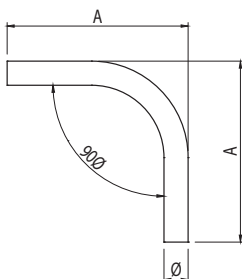



**BEND PREFORMED PIPES**

CURVE SPECIALI  
CURVAS ESPECIALES  
COUDES SPÉCIAUX  
SPEZIALE-FORMTEILE

Code	Color	Ø	A	B	C	D			(g)
<b>059.020.102</b>		20	195	165					135
<b>059.025.102</b>		25	215	200					165
<b>059.025.102V</b>		25	215	200					165

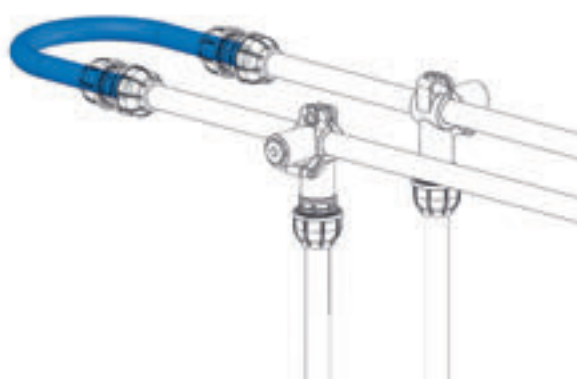
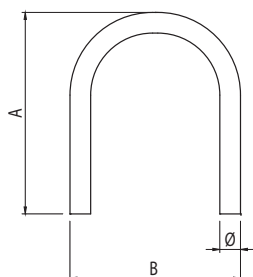
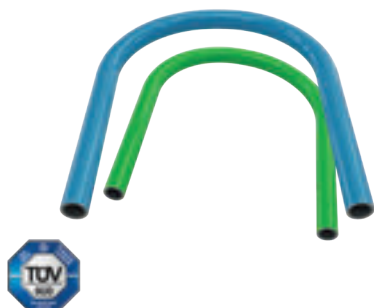

**BEND PREFORMED PIPES**

CURVE SPECIALI  
CURVAS ESPECIALES  
COUDES SPÉCIAUX  
SPEZIALE-FORMTEILE

Code	Color	Ø	A	B	C	D			(g)
<b>059.020.103</b>		20	425	143,5	100				126
<b>059.025.103</b>		25	470	150	125				160
<b>059.025.103V</b>		25	470	150	125				160

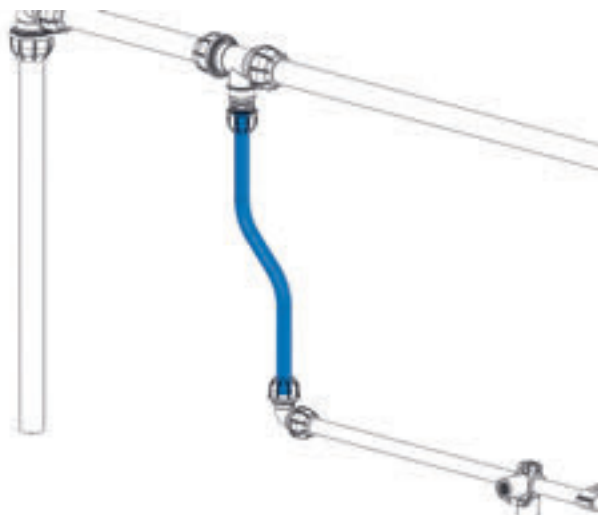
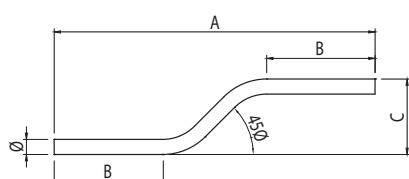
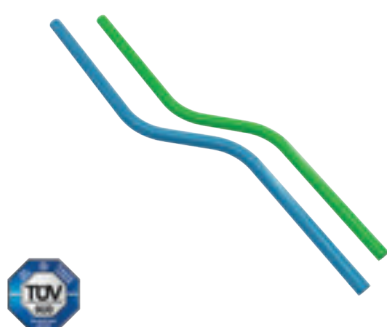



**BEND PREFORMED PIPES**  
 CURVE SPECIALI  
 CURVAS ESPECIALES  
 COUDES SPÉCIAUX  
 SPEZIALE-FORMTEILE

Code	Color	Ø	A	B	C	D			(g)
<b>059.020.104</b>		20	345	95	110	195			109
<b>059.025.104</b>		25	460	150	150	240			165
<b>059.025.104V</b>		25	460	150	150	240			165

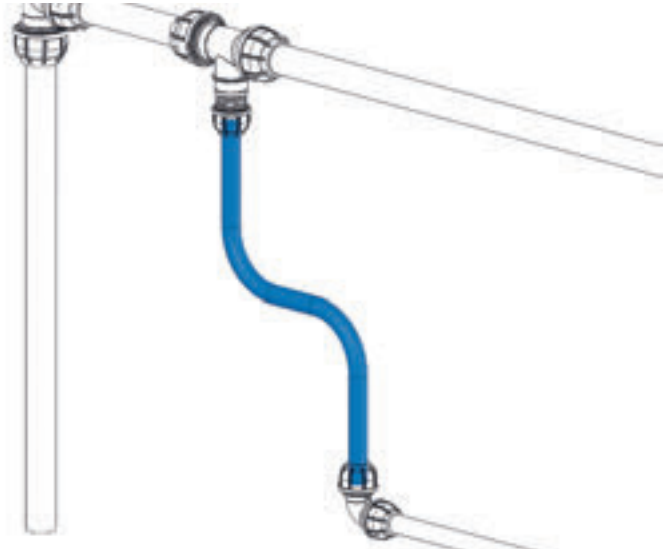
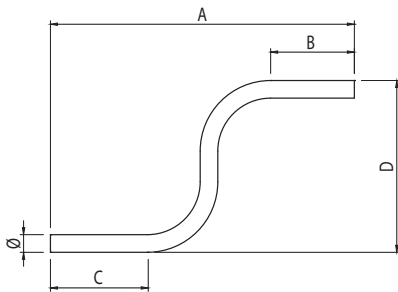
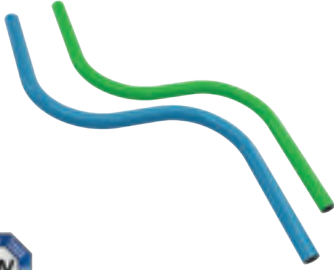

**STRAIGHT FITTING**

MANICOTTO GIUNZIONE DIRITTO  
MANGUITO DE UNIÓN RECTO  
MANCHON JONCTION DROIT  
GERADER VERBINDER

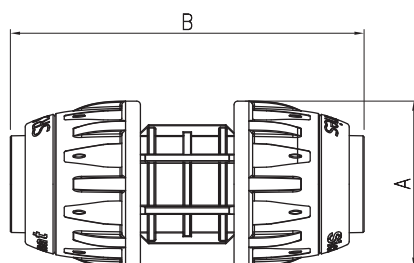
**NEW****EVO**

Code	Color	Ø	A	B	C	D			(g)
<b>EVO FITTING</b>									
SRR210.020.020		20X20	44	99,5			5	140	61
SRR210.025.025		25X25	52	105			5	90	105
SRR210.032.032		32X32	62	126			5	40	150
SRR210.040.040		40X40	72	143			1	35	240
SRR210.050.050		50X50	86,5	171			1	18	410
SRR210.063.063		63X63	105	193,5			1	12	642
SRG210.020.020		20X20	44	99,5			5	140	61
SRG210.025.025		25X25	52	10,5			5	90	105
SRG210.032.032		32X32	62	126			5	40	150
SRG210.040.040		40X40	72	143			1	35	240
SRG210.050.050		50X50	86,5	171			1	18	410
SRG210.063.063		63X63	105	193,5			1	12	642
SRA210.025.025		25X25	552	105			5	90	105
SRA210.040.040		40X40	72	143			1	35	240
<b>CLASSIC FITTING</b>									
R210.020.020		20X20	44	85			5	140	58
R210.025.025		25X25	52	97			5	90	97
R210.032.032		32X32	62	113			5	40	165
R210.040.040		40X40	72	129			1	35	215
R210.050.050		50X50	86,5	157			1	18	401
R210.063.063		63X63	105	182			1	12	633
A210.025.025		25X25	552	97			5	90	97
A210.040.040		40X40	72	129			1	35	215
V210.063.063		63X63	105	182			1	12	663

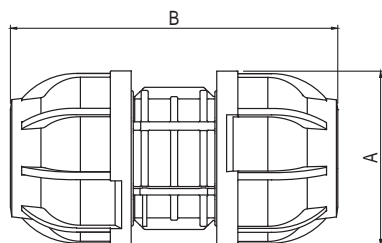
**CLASSIC**



**STRAIGHT REDUCING FITTING**  
 MANICOTTO GIUNZIONE RIDOTTO  
 MANGUITO DE UNIÓN REDUCIDO  
 MANCHON JONCTION RÉDUCTEUR  
 REDUZIERVERBINDER



**EVO**

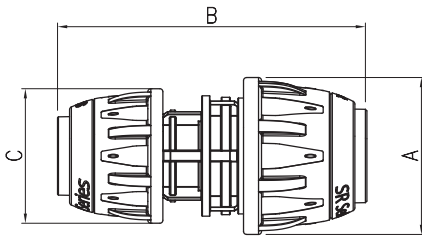

Code	Color	Ø	A	B	C	D			(g)
<b>EVO FITTING</b>									
SRR212.025.020	N	25X20	52	103	44		5	110	84
SRR212.032.025	N	32X25	62	117,5	52		5	60	128
SRR212.040.032	N	40X32	72	133	62		5	40	205,5
SRR212.050.040	N	50X40	86,5	157	72		1	25	333
SRR212.063.050	N	63X50	105	182	86,5		1	18	516,4
SRG212.025.020	N	25X20	52	103	44		5	110	84
SRG212.032.025	N	32X25	62	117,5	52		5	60	128
SRG212.040.032	N	40X32	72	133	62		5	40	205,5
SRG212.050.040	N	50X40	86,5	157	72		1	25	333
SRG212.063.050	N	63X50	105	182	86,5		1	18	516,4
SRA212.025.020	N	25X20	52	103	44		5	110	84
SRA212.040.032	N	40X32	72	133	62		5	40	205,5
<b>CLASSIC FITTING</b>									
R212.025.020	N	25X20	52	91	44		5	110	81
R212.032.025	N	32X25	62	103,5	52		5	60	133
R212.040.032	N	40X32	72	121	62		5	40	193
R212.050.040	N	50X40	86,5	145,5	72		1	25	320
R212.063.050	N	63X50	105	167	86,5		1	18	531



**CLASSIC**

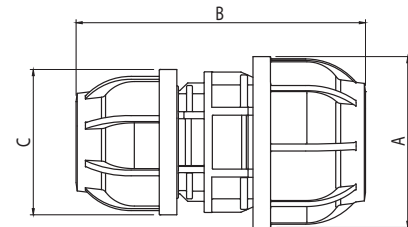



90° ELBOW FITTING  
RACCORDO GIUNZIONE 90°  
CODO 90°  
COUDE ÉGAL 90°  
WINKEL 90°



EVO

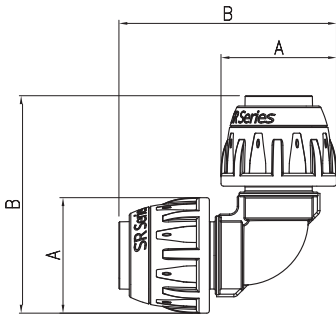

CLASSIC

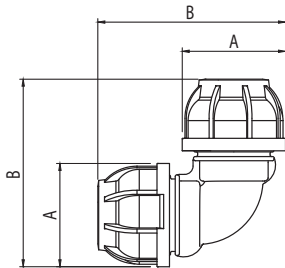

Code	Color	Ø	A	B	C	D			(g)
<b>EVO FITTING</b>									
SRR213.020.020	N	20X20	44	84			5	130	66,5
SRR213.025.025	N	25X25	52	102			5	70	118
SRR213.032.032	N	32X32	62	118			5	40	175,5
SRR213.040.040	N	40X40	72	135			1	30	269
SRR213.050.050	N	50X50	86,5	164			1	15	462,5
SRR213.063.063	N	63X63	105	193,5			1	9	756,5
SRG213.020.020	N	20X20	44	84			5	130	66,5
SRG213.025.025	N	25X25	52	102			5	70	118
SRG213.032.032	N	32X32	62	118			5	40	175,5
SRG213.040.040	N	40X40	72	135			1	30	269
SRG213.050.050	N	50X50	86,5	164			1	15	462,5
SRG213.063.063	N	63X63	105	193,5			1	9	756,5
SRA213.025.025	N	25X25	52	102			5	70	118
SRA213.040.040	N	40X40	72	135			1	30	269
<b>CLASSIC FITTING</b>									
R213.020.020	N	20X20	44	76			5	130	62
R213.025.025	N	25X25	52	92			5	70	106
R213.032.032	N	32X32	62	109			5	40	172
R213.040.040	N	40X40	72	127,5			1	30	243
R213.050.050	N	50X50	86,50	157,5			1	15	465
R213.063.063	N	63X63	105	184			1	9	745
A213.025.025	N	25X25	52	92			5	70	106
A213.040.040	N	40X40	72	127,5			1	30	243
V213.063.063	N	63X63	105	184			1	9	745

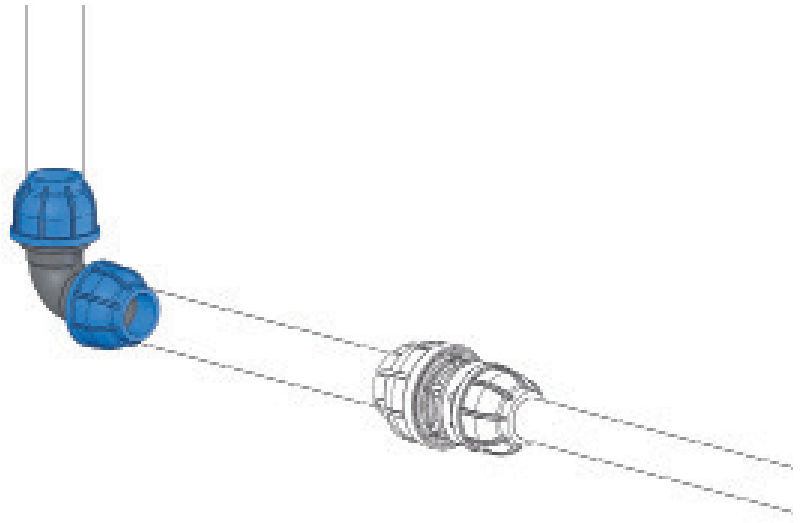



**45° ELBOW FITTING**  
 RACCORDO A GOMITO 45°  
 CODO 45°  
 JONCTION ANGULAIRE 45°  
 WINKEL 45°



**EVO**

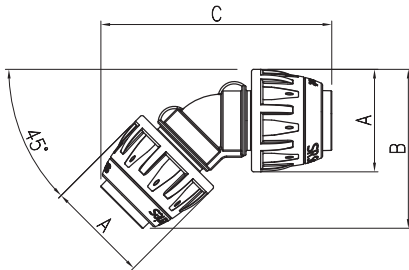

**CLASSIC**

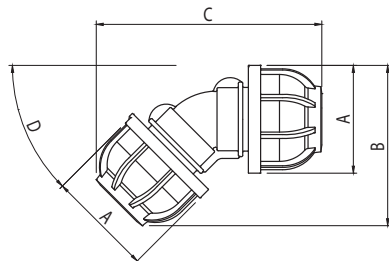

Code	Color	Ø	A	B	C	D			(g)
<b>EVO FITTING</b>									
SRR245.020.020		20X20	44	69,5	100,5	45°	5	140	69,5
SRR245.025.025		25X25	52	82	120	45°	5	70	113
SRR245.032.032		32X32	62	98	140	45°	5	40	167
SRR245.040.040		40X40	72	113	159	45°	1	30	253
SRR245.050.050		50X50	86,5	137	198	45°	2	26	438
SRR245.063.063		63X63	105	161	223,5	45°	1	9	705
SRG245.020.020		20X20	44	69,5	100,5	45°	5	140	69,5
SRG245.025.025		25X25	52	82	120	45°	5	70	113
SRG245.032.032		32X32	62	98	140	45°	5	40	167
SRG245.040.040		40X40	72	113	159	45°	1	30	253
SRG245.050.050		50X50	86,5	137	198	45°	2	26	438
SRG245.063.063		63X63	105	161	223,5	45°	1	9	705
SRA245.025.025		25X25	52	82	120	45°	5	70	113
SRA245.040.040		40X40	72	113	159	45°	1	30	253
<b>CLASSIC FITTING</b>									
R245.020.020		20X20	44	66,5	92	45°	5	140	65
R245.025.025		25X25	52	80	114	45°	5	70	110
R245.032.032		32X32	62	94	135	45°	5	40	175
R245.040.040		40X40	72	109	151	45°	1	30	245
R245.050.050		50X50	86,5	131	182	45°	2	26	560
R245.063.063		63X63	105	157	215	45°	1	9	670
A245.025.025		25X25	52	80	114	45°	5	70	110
A245.040.040		40X40	72	109	151	45°	1	30	245
V245.063.063		63X63	105	157	215	45°	1	9	670

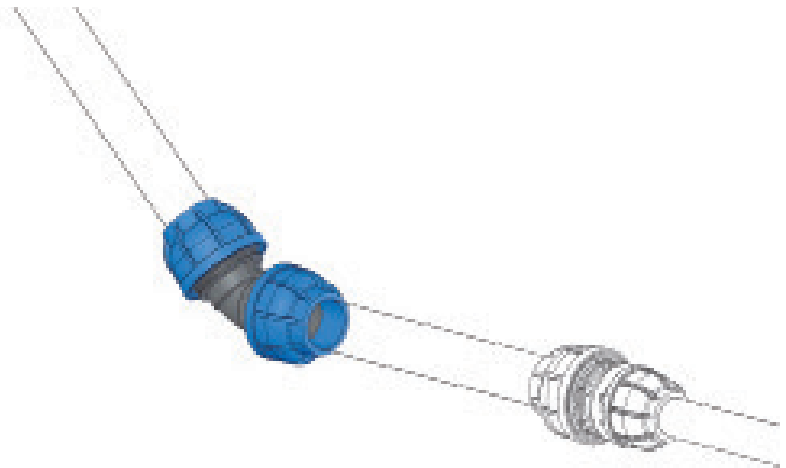



**"TEE" FITTING**  
RACCORDO "T" PARI  
EMPALME EN "T"  
RACCORD EN "T"  
T-STÜCK

**NEW**



**EVO**

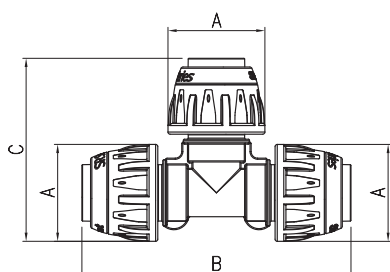

Code	Color	Ø	A	B	C	D	☐	📦	(g)
<b>EVO FITTING</b>									
SRR214.020.000	N	20x20x20	44	124	84,5		5	80	106
SRR214.025.000	N	25x25x25	52	146,5	99		5	40	171,5
SRR214.032.000	N	32x32x32	62	172,3	118		5	25	263
SRR214.040.000	N	40x40x40	72	195	134,5		1	18	410
SRR214.050.000	N	50x50x50	86,5	239	163,5		1	10	780
SRR214.063.000	N	63X63X63	105	275,5	191		1	5	1150
SRG214.020.000	N	20x20x20	44	124	84,5		5	80	106
SRG214.025.000	N	25x25x25	52	146,5	99		5	40	171,5
SRG214.032.000	N	32x32x32	62	172,3	118		5	25	263
SRG214.040.000	N	40x40x40	72	195	134,5		1	18	410
SRG214.050.000	N	50x50x50	86,5	239	163,5		1	10	780
SRG214.063.000	N	63X63X63	105	275,5	191		1	5	1150
SRA214.025.000	N	25X25X25	52	146,5	99		5	40	171,5
SRA214.040.000	N	40X40X40	72	195	134,5		1	18	410
<b>CLASSIC FITTING</b>									
R214.020.000	N	20x20x20	44	109,5	76,5		5	80	89
R214.025.000	N	25x25x25	52	132	93,5		5	40	155
R214.032.000	N	32x32x32	62	159,5	111		5	25	255
R214.040.000	N	40x40x40	72	182	127,5		1	18	367
R214.050.000	N	50x50x50	86,5	225	154		1	10	697
R214.063.000	N	63X63X63	105	262	182		1	5	1123
A214.025.000	N	25X25X25	52	132	93,5		5	40	155
A214.040.000	N	40X40X40	72	182	127,5		1	18	367
V214.063.000	N	63X63X63	105	262	182		1	5	1123



**CLASSIC**

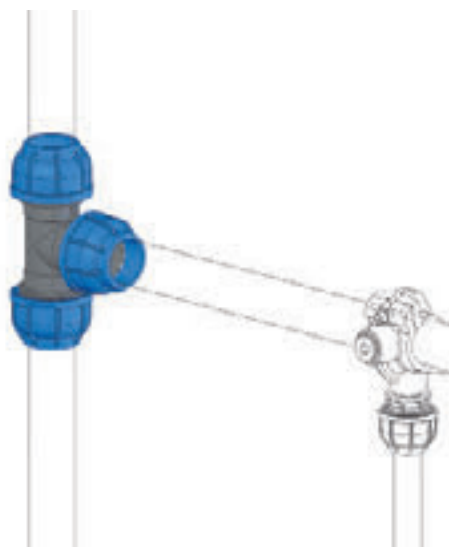
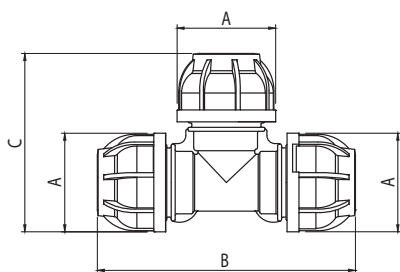



**STRAIGHT UNION FITTING**  
 RACCORDO A 3 PEZZI  
 RACOR A 3 PIEZAS  
 RACCORD UNION 3 PIÈCES  
 3-TEILIGER VERBINDER

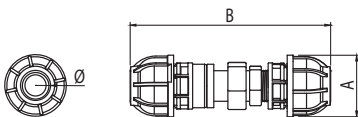
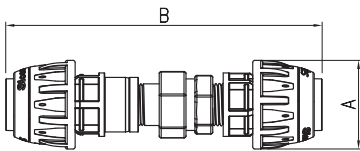

Code	Color	Ø	A	B	C	D			(g)
<b>EVO FITTING</b>									
SRR220.020.012		20x1/2"	44	159,5			-	-	195
SRR220.020.034		20x3/4"	44	159,5			-	-	195
SRR220.025.034		25x3/4"	52	178,5			-	-	180,5
SRR220.025.001		25x1"	52	178,5			-	-	203,5
SRR220.032.001		32x1"	62	199,5			-	-	237
SRR220.032.114		32x1 1/4"	62	204,5			-	-	237
SRR220.040.114		40x1 1/4"	72	230			-	-	445
SRR220.040.112		40x1 1/2"	72	235			-	-	821
SRR220.050.112		50x1 1/2"	86,50	277			-	-	1398
SRR220.050.002		50x2"	86,50	287			-	-	1764
SRR220.063.002		63x2"	105	319			-	-	1948
SRR220.063.212		63x2 1/2"	105	339			-	-	2338
SRG220.020.012		20x1/2"	44	159,5			-	-	195
SRG220.020.034		20x3/4"	44	159,5			-	-	195
SRG220.025.034		25x3/4"	52	178,5			-	-	180,5
SRG220.025.001		25x1"	52	178,5			-	-	203,5
SRG220.032.001		32x1"	62	199,5			-	-	237
SRG220.032.114		32x1 1/4"	62	204,5			-	-	237
SRG220.040.114		40x1 1/4"	72	230			-	-	445
SRG220.040.112		40x1 1/2"	72	235			-	-	821
SRG220.050.112		50x1 1/2"	86,50	277			-	-	1398
SRG220.050.002		50x2"	86,50	287			-	-	1764
SRG220.063.002		63x2"	105	319			-	-	1948
SRG220.063.212		63x2 1/2"	105	339			-	-	2338
SRA220.025.034		25x3/4"	52	178,5			-	-	180,5
SRA220.025.001		25x1"	52	178,5			-	-	203,5
SRA220.040.014		40x1 1/4"	72	230			-	-	445
SRA220.040.112		40x1 1/2"	72	235			-	-	821
<b>CLASSIC FITTING</b>									
R220.020.012		20x1/2"	44	150			-	-	174
R220.020.034		20x3/4"	44	150			-	-	174
R220.025.034		25x3/4"	52	170			-	-	277
R220.025.001		25x1"	52	170			-	-	300
R220.032.001		32x1"	62	190			-	-	473
R220.032.114		32x1 1/4"	62	195			-	-	473
R220.040.114		40x1 1/4"	72	220			-	-	710
R220.040.112		40x1 1/2"	72	225			-	-	1086
R220.050.112		50x1 1/2"	86,50	250			-	-	1234
R220.050.002		50x2"	86,50	260			-	-	1600
R220.063.002		63x2"	105	310			-	-	1710
R220.063.212		63x2 1/2"	105	330			-	-	2100
A220.025.034		25x3/4"	52	170			-	-	277
A220.025.001		25x1"	52	170			-	-	300
A220.040.014		40x1 1/4"	72	220			-	-	710
A220.040.112		40x1 1/2"	72	225			-	-	1986
V220.063.002		63x2"	105	310			-	-	1710
V220.063.212		63x2 1/2"	105	330			-	-	2100

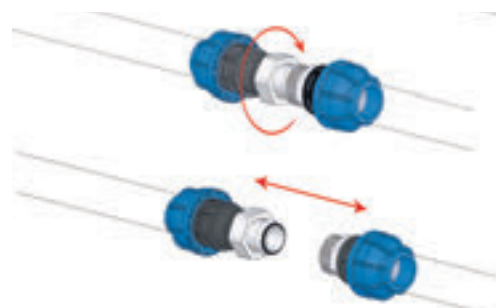



**STRAIGHT FEMALE FITTING**  
 RACCORDO DIRITTO FEMMINA  
 RACOR RECTO HEMBRA  
 RACCORD DROIT FEMELLE  
 GERADER VERBINDER MIT INNENGEWINDE



**BSP  
EVO**

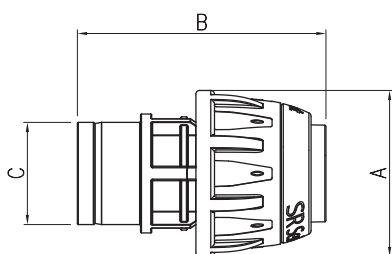

**BSP  
CLASSIC**

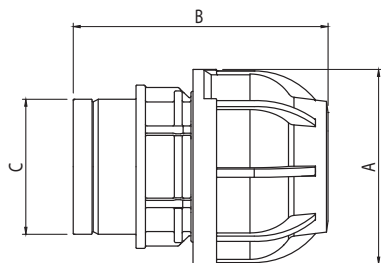

Code	Color	Ø	A	B	C	D			(g)
<b>EVO FITTING</b>									
SRR201.020.012		20x1/2"	44	67	30		5	200	41,2
SRR201.025.034		25x3/4"	52	75	37		5	140	66,5
SRR201.032.001		32x1"	62	84	43		5	80	101,5
SRR201.040.114		40x1 1/4"	72	97,5	54		1	50	154,5
SRR201.050.112		50x1 1/2"	86,50	112	62		1	30	252
SRR201.063.002		63x2"	105	126,5	122,5		1	20	394,5
SRR201.020.012		20x1/2"	44	67	30		5	200	41,2
SRG201.025.034		25x3/4"	52	75	37		5	140	66,5
SRG201.032.001		32x1"	62	84	43		5	80	101,5
SRG201.040.114		40x1 1/4"	72	97,5	54		1	50	154,5
SRG201.050.112		50x1 1/2"	86,50	112	62		1	30	252
SRG201.063.002		63x2"	105	126,5	122,5		1	20	394,5
SRA201.025.034		25x3/4"	52	75	37		5	140	66,5
SRA201.040.114		40x1 1/4"	72	97,5	54		1	50	154,5
<b>CLASSIC FITTING</b>									
R201.020.012		20x1/2"	44	60,50	30		5	200	38
R201.025.034		25x3/4"	52	69	37		5	140	64
R201.032.001		32x1"	62	81	43		5	80	104
R201.040.114		40x1 1/4"	72	92	54		1	50	142
R201.050.112		50x1 1/2"	86,5	105	62		1	30	246
R201.063.002		63x2"	105	122,5	122,5		1	20	389
A201.025.034		25x3/4"	52	69	37		5	140	64
A201.040.114		40x1 1/4"	72	92	54		1	50	142
V201.063.002		63x2"	105	122,5	77		1	20	389





**ALUMINIUM STRAIGHT FEMALE FITTING**  
 RACCORDO DIRITTO FEMMINA ALLUMINIO  
 RACOR RECTO HEMBRA ALUMINIO  
 RACCORD DROIT FEMELLE ALUMINIUM  
 GERADER VERBINDER MIT ALU INNENGEWINDE



**EVO**

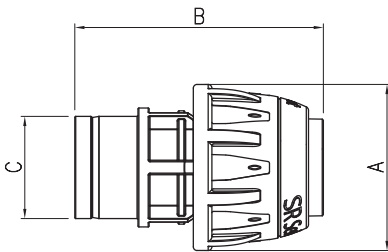

**CLASSIC**

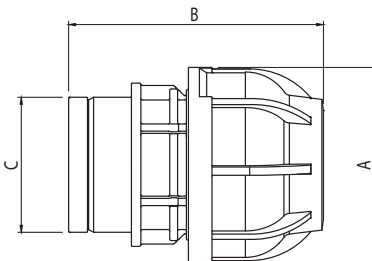

Code	Color	Ø	A	B	C	D			(g)
<b>EVO FITTING</b>									
SRR201.020.012NPT		20x1/2"	44	67	30		5	200	41,2
SRR201.025.034NPT		25x3/4"	52	75	37		5	140	66,5
SRR201.032.001NPT		32x1"	62	84	43		5	80	101,5
SRR201.040.114NPT		40x1 1/4"	72	97,5	54		1	50	154,5
SRR201.050.112NPT		50x1 1/2"	86,5	112	62		1	30	252
SRR201.063.002NPT		63x2"	105	126,5	122,5		1	20	394,5
SRG201.020.012NPT		20x1/2"	44	67	30		5	200	41,2
SRG201.025.034NPT		25x3/4"	52	75	37		5	140	66,5
SRG201.032.001NPT		32x1"	62	84	43		5	80	101,5
SRG201.040.114NPT		40x1 1/4"	72	97,5	54		1	50	154,5
SRG201.050.112NPT		50x1 1/2"	86,5	112	62		1	30	252
SRG201.063.002NPT		63x2"	105	126,5	122,5		1	20	394,5
SRA201.025.034NPT		25x3/4"	52	75	37		5	140	66,5
SRA201.040.114NPT		40x1 1/4"	72	97,5	54		1	50	154,5
<b>CLASSIC FITTING</b>									
R201.020.012NPT		20x1/2"	44	60,5	30		5	200	38
R201.025.034NPT		25x3/4"	52	69	37		5	140	64
R201.032.001NPT		32x1"	62	81	43		5	80	104
R201.040.114NPT		40x1 1/4"	72	92	54		1	50	142
R201.050.112NPT		50x1 1/2"	86,5	105	62		1	30	246
R201.063.002NPT		63x2"	105	122,5	122,5		1	20	389

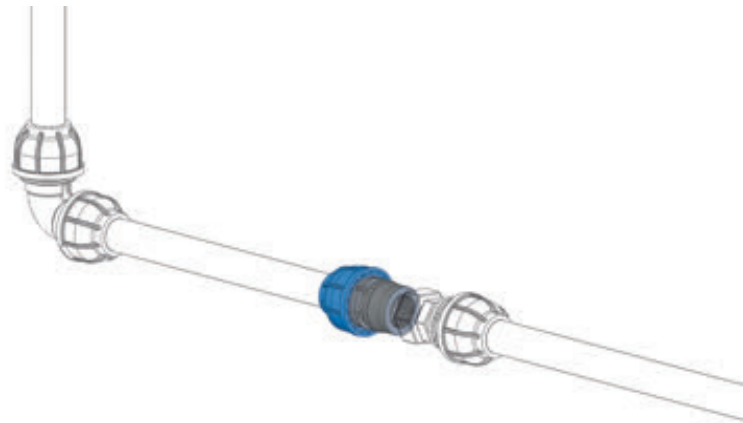



ALUMINIUM STRAIGHT FEMALE FITTING  
RACCORDO DIRITTO FEMMINA ALLUMINIO  
RACOR RECTO HEMBRA ALUMINIO  
RACCORD DROIT FEMELLE ALUMINIUM  
GERADER VERBINDER MIT ALU INNENGEWINDE



EVO

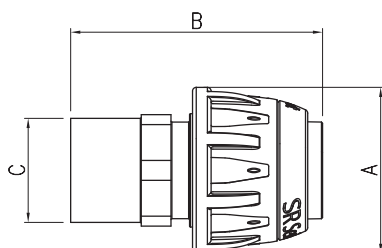

CLASSIC

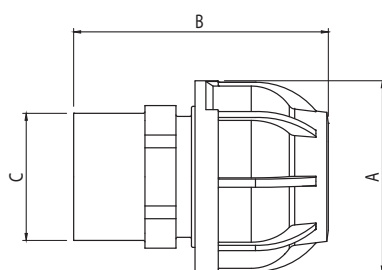

Code	Color	Ø	A	B	C	D			(g)
<b>EVO FITTING</b>									
SRR202.020.012	N	20x1/2"	44	68	30		5	40	42
SRR202.025.034	N	25x3/4"	52	75	37		5	30	60
SRR202.032.001	N	32x1"	62	87	43		5	20	90,5
SRR202.040.114	N	40x1 1/4"	72	95,5	54		1	15	143,5
SRR202.050.112	N	50x1 1/2"	86,50	112	62		1	6	217,5
SRR202.063.002	N	63x2"	105	126,5	122,5		1	4	345
SRG202.020.012	N	20x1/2"	44	68	30		5	40	42
SRG202.025.034	N	25x3/4"	52	75	37		5	30	60
SRG202.032.001	N	32x1"	62	87	43		5	20	90,5
SRG202.040.114	N	40x1 1/4"	72	95,5	54		1	15	143,5
SRG202.050.112	N	50x1 1/2"	86,50	112	62		1	6	217,5
SRG202.063.002	N	63x2"	105	126,5	122,5		1	4	345
SRA202.025.034	N	25x3/4"	52	75	37		5	30	60
SRA202.040.114	N	40x1 1/4"	72	95,5	54		1	15	143,5
<b>CLASSIC FITTING</b>									
R202.020.012	N	20x1/2"	44	60,5	30		5	40	59
R202.025.034	N	25x3/4"	52	69	37		5	30	91
R202.032.001	N	32x1"	62	81	43		5	20	152
R202.040.114	N	40x1 1/4"	72	92	54		1	15	210
R202.050.112	N	50x1 1/2"	86,5	105	62		1	6	342
R202.063.002	N	63x2"	105	122,5	122,5		1	4	549
A202.025.034	N	25x3/4"	52	69	37		5	30	91
A202.040.114	N	40x1 1/4"	72	92	54		1	15	210
V202.063.002	N	63x2"	105	122,50	77		1	4	549

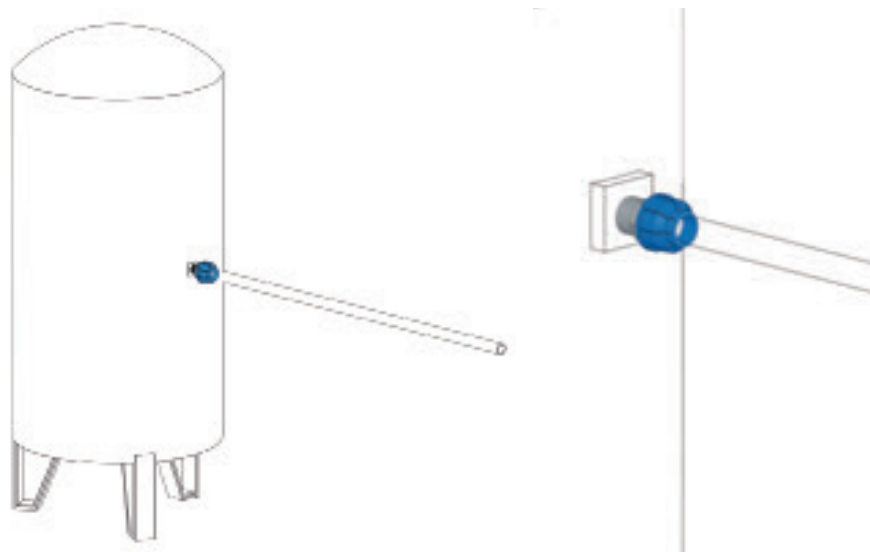



**STRAIGHT MALE FITTING**  
 RACCORDO DIRITTO MASCHIO  
 RACOR RECTO MACHO  
 RACCORD DROIT MÂLE  
 GERADER VERBINDER MIT AUSSENGEWINDE

**NEW**



**BSP  
EVO**

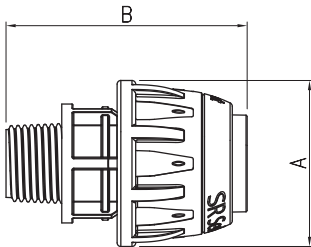

**BSP  
CLASSIC**

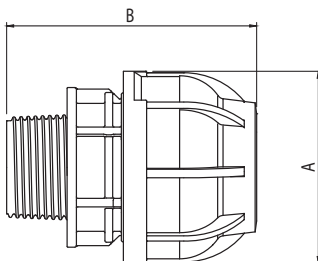

Code	Color	Ø	A	B	C	D	⌀	⊥	(g)
<b>EVO FITTING</b>									
SRR211.020.012	N	20x1/2"	44	65			5	240	35,5
SRR211.020.034	N	20x3/4"	44	67			5	240	39
SRR211.025.012	N	25x1/2"	52	72			5	170	59
SRR211.025.034	N	25x3/4"	52	73			5	170	60
SRR211.025.001	N	25x1"	52	75,5			5	170	61,5
SRR211.032.001	N	32x1"	62	85,5			5	80	94
SRR211.032.114	N	32x1 1/4"	62	88			5	80	98
SRR211.040.001	N	40x1"	72	94,5			1	60	138
SRR211.040.114	N	40x1 1/4"	72	97			1	60	144
SRR211.040.112	N	40x1 1/2"	72	96,5			1	60	142
SRR211.050.112	N	50x1 1/2"	86,50	109			1	30	249
SRR211.050.002	N	50x2"	86,50	109			1	30	246
SRR211.063.002	N	63x2"	105	126			1	20	276
SRR211.063.212	N	63x2 1/2"	105	133			1	20	383
SRG211.020.012	N	20x1/2"	44	65			5	240	35,5
SRG211.020.034	N	20x3/4"	44	67			5	240	39
SRG211.025.012	N	25x1/2"	52	72			5	170	59
SRG211.025.034	N	25x3/4"	52	73			5	170	60
SRG211.025.001	N	25x1"	52	75,5			5	170	61,5
SRG211.032.001	N	32x1"	62	85,5			5	80	94
SRG211.032.114	N	32x1 1/4"	62	88			5	80	98
SRG211.040.001	N	40x1"	72	94,5			1	60	138
SRG211.040.114	N	40x1 1/4"	72	97			1	60	144
SRG211.040.112	N	40x1 1/2"	72	96,5			1	60	142
SRG211.050.112	N	50x1 1/2"	86,50	109			1	30	249
SRG211.050.002	N	50x2"	86,50	109			1	30	246
SRG211.063.002	N	63x2"	105	126			1	20	276
SRA211.025.012	N	25x1/2"	52	72			5	170	59
SRA211.025.034	N	25x3/4"	52	73			5	170	60
SRA211.025.001	N	25x1"	52	75,5			5	170	61,5
SRA211.040.001	N	40x1"	72	94,5			1	60	138
SRA211.040.014	N	40x1 1/4"	72	97			1	60	144
SRA211.040.112	N	40x1 1/2"	72	96,5			1	60	142
<b>CLASSIC FITTING</b>									
R211.020.012	N	20x1/2"	44	60			5	240	34
R211.020.034	N	20x3/4"	44	61			5	240	40
R211.025.012	N	25x1/2"	52	66,5			5	170	55
R211.025.034	N	25x3/4"	52	68			5	170	57
R211.025.001	N	25x1"	52	71,5			5	170	60
R211.032.001	N	32x1"	62	78,5			5	80	96
R211.032.114	N	32x1 1/4"	62	80,5			5	80	100
R211.040.001	N	40x1"	72	88,5			1	60	132
R211.040.114	N	40x1 1/4"	72	90			1	60	132
R211.040.112	N	40x1 1/2"	72	89			1	60	135
R211.050.112	N	50x1 1/2"	86,5	104			1	30	234
R211.050.002	N	50x2"	86,5	108			1	30	236
R211.063.002	N	63x2"	105	119			1	20	374
R211.063.212	N	63x2 1/2"	105	125			1	20	380
A211.025.012	N	25x1/2"	52	66,5			5	170	55
A211.025.034	N	25x3/4"	52	68			5	170	57
A211.025.001	N	25x1"	52	71,5			5	170	60
A211.040.001	N	40x1"	72	88,5			1	60	132
A211.040.014	N	40x1 1/4"	72	90			1	60	132
A211.040.112	N	40x1 1/2"	72	89			1	60	135
V211.063.002	N	63x2"	105	119			1	20	549
V211.063.212	N	63x2 1/2"	105	125			1	20	380



**STRAIGHT MALE FITTING NPT**  
 RACCORDO DIRITTO MASCHIO NPT  
 RACOR RECTO MACHO NPT  
 RACCORD DROIT MÂLE NPT  
 GERADER VERBINDER MIT AUSSENGEWINDE NPT



**NPT**  
**EVO**

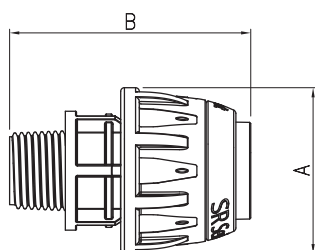

**NPT**  
**CLASSIC**

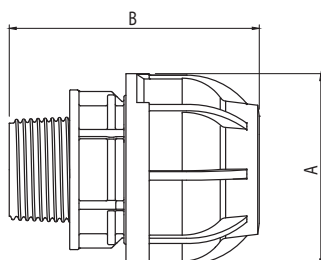

Code	Color	Ø	A	B	C	D			(g)
<b>EVO FITTING</b>									
SRR211.020.012NPT	N	20x1/2"	44	65			5	240	35,5
SRR211.025.034NPT	N	25x3/4"	52	73			5	170	60
SRR211.032.001NPT	N	32x1"	62	85,5			5	80	94
SRR211.040.114NPT	N	40x1 1/4"	72	97			1	60	144
SRR211.050.112NPT	N	50x1 1/2"	86,50	109			1	30	249
SRR211.063.002NPT	N	63x2"	105	126			1	20	376
SRG211.020.012NPT	N	20x1/2"	44	65			5	240	35,5
SRG211.025.034NPT	N	25x3/4"	52	73			5	170	60
SRG211.032.001NPT	N	32x1"	62	85,5			5	80	94
SRG211.040.114NPT	N	40x1 1/4"	72	97			1	60	144
SRG211.050.112NPT	N	50x1 1/2"	86,50	109			1	30	249
SRG211.063.002NPT	N	63x2"	105	126			1	20	376
SRA211.025.034NPT	N	25x3/4"	52	73			5	170	60
SRA211.040.114NPT	N	40x1 1/4"	72	97			1	60	144
<b>CLASSIC FITTING</b>									
R211.020.012NPT	N	20x1/2"	44	60			5	240	34
R211.025.034NPT	N	25x3/4"	52	68			5	170	57
R211.032.001NPT	N	32x1"	62	78,5			5	80	96
R211.040.114NPT	N	40x1 1/4"	72	90			1	60	132
R211.050.112NPT	N	50x1 1/2"	86,5	104			1	30	234
R211.063.002NPT	N	63x2"	105	119			1	20	374





**ALUMINIUM STRAIGHT MALE FITTING**  
 RACCORDO DIRITTO MASCHIO ALLUMINIO  
 RACOR RECTO MACHO ALUMINIO  
 RACCORD DROIT MÂLE EN ALUMINIUM  
 GERADER VERBINDER MIT ALU AUSSENGEWINDE

**NEW**



**EVO**

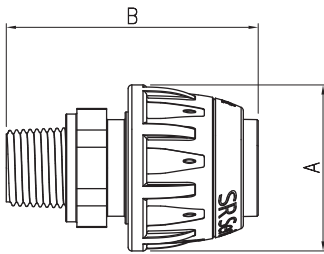

**CLASSIC**

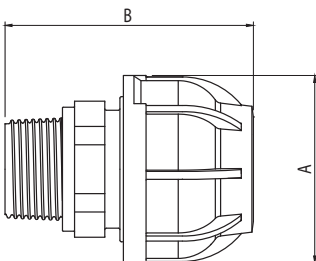

Code	Color	Ø	A	B	C	D	□	◻	(g)
<b>EVO FITTING</b>									
SRR203.020.012	N	20x1/2"	44	68			5	240	60,7
SRR203.025.012	N	25x1/2"	44	75			5	240	85
SRR203.025.034	N	25x3/4"	52	75			5	170	86,5
SRR203.032.001	N	32x1"	52	87			5	170	145,5
SRR203.040.001	N	40x1"	52	95,5			5	170	213
SRR203.040.114	N	40x1 1/4"	62	95,5			5	80	220
SRR203.050.112	N	50x1 1/2"	62	110			5	80	330,5
SRR203.063.002	N	63x2"	105	126,5			1	4	527
SRG203.020.012	N	20x1/2"	44	68			5	240	60,7
SRG203.025.012	N	25x1/2"	44	75			5	240	85
SRG203.025.034	N	25x3/4"	52	75			5	170	86,5
SRG203.032.001	N	32x1"	52	87			5	170	145,5
SRG203.040.001	N	40x1"	52	95,5			5	170	213
SRG203.040.114	N	40x1 1/4"	62	95,5			5	80	220
SRG203.050.112	N	50x1 1/2"	62	110			5	80	330,5
SRG203.063.002	N	63x2"	105	126,5			1	4	527
SRA203.025.012	N	25x1/2"	52	75			5	240	85
SRA203.025.034	N	25x3/4"	52	75			5	170	86,5
SRA203.040.001	N	40x1"	72	95,5			5	170	213
SRA203.040.114	N	40x1 1/4"	72	95,5			5	80	220
<b>CLASSIC FITTING</b>									
R203.020.012	N	20x1/2"	44	60			5	240	34
R203.025.012	N	25x1/2"	44	61			5	240	40
R203.025.034	N	25x3/4"	52	66,5			5	170	55
R203.032.001	N	32x1"	52	68			5	170	57
R203.040.001	N	40x1"	52	71,5			5	170	60
R203.040.114	N	40x1 1/4"	62	78,5			5	80	96
R203.050.112	N	50x1 1/2"	62	80,5			5	80	100
R203.063.002	N	63x2"	72	88,5			1	60	132
A203.025.012	N	25x1/2"	52	66,5			5	30	91
A203.025.034	N	25x3/4"	52	68			5	30	91
A203.040.001	N	40x1"	72	88,5			1	15	202
A203.040.114	N	40x1 1/4"	72	90			1	15	210
V203.063.002	N	63x2"	105	119			1	4	549

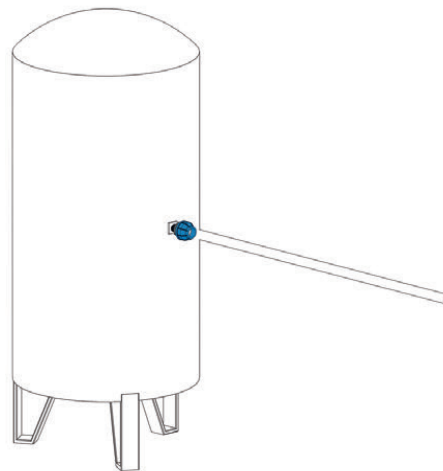



**ELBOW MALE FITTING**  
RACCORDO CURVO MASCHIO  
CODO MACHO  
COUDE ÉGAL MÂLE  
WINKEL MIT AUSSENGEWINDE



EVO

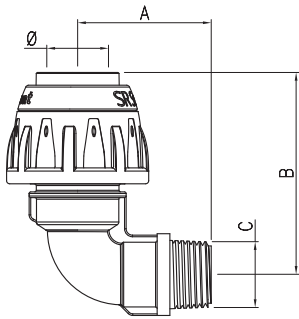

CLASSIC

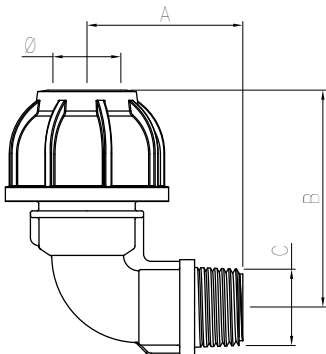

Code	Color	Ø	A	B	C	D			(g)
<b>EVO FITTING</b>									
SRR269.020.012		20x1/2"	42	63,5	1/2"		5	240	44
SRR269.025.012		25x1/2"	45	69,5	1/2"		5	240	66,5
SRR269.025.034		25x3/4"	45	70,5	3/4"		5	240	69,5
SRG269.020.012		20x1/2"	42	63,5	1/2"		5	240	44
SRG269.025.012		25x1/2"	45	69,5	1/2"		5	240	66,5
SRG269.025.034		25x3/4"	45	70,5	3/4"		5	240	69,5
SRA269.025.012		25x1/2"	45	69,5	1/2"		5	240	66,5
SRA269.025.034		25x3/4"	45	70,5	3/4"		5	240	69,5
<b>CLASSIC FITTING</b>									
R269.020.012		20x1/2"	42	57	1/2"		5	240	33
R269.025.012		25x1/2"	45	67	1/2"		5	240	66
R269.025.034		25x3/4"	45	73	3/4"		5	240	64





END CAP  
TAPPO  
TAPÓN  
BOUCHON  
ENDSTOPFEN

**NEW**



**EVO**

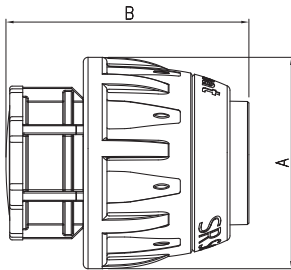

Code	Color	Ø	A	B	C	D			(g)
<b>EVO FITTING</b>									
SRR221.020.000		20	44	50,5			5	250	37
SRR221.025.000		25	52	58			5	170	55
SRR221.032.000		32	62	67			5	90	86
SRR221.040.000		40	72	74,5			1	70	129
SRR221.050.000		50	86,50	89,5			1	40	222
SRR221.063.000		63	105	101			1	25	350
SRG221.020.000		20	44	50,5			5	250	37
SRG221.025.000		25	52	58			5	170	55
SRG221.032.000		32	62	67			5	90	86
SRG221.040.000		40	72	74,5			1	70	129
SRG221.050.000		50	86,50	89,5			1	40	222
SRG221.063.000		63	105	101			1	25	350
SRA221.025.000		25	52	58			5	170	55
SRA221.040.000		40	72	74,5			1	70	129
<b>CLASSIC FITTING</b>									
R221.020.000		20	44	44,5			5	250	31
R221.025.000		25	52	53,5			5	170	54
R221.032.000		32	62	63			5	90	89
R221.040.000		40	72	68,5			1	70	120
R221.050.000		50	86,5	82,5			1	40	220
R221.063.000		63	105	94,5			1	25	347
A221.025.000		25	52	53,5			5	170	54
A221.040.000		40	72	68,5			1	70	120
V221.063.000		63	105	94,5			1	25	347



**CLASSIC**

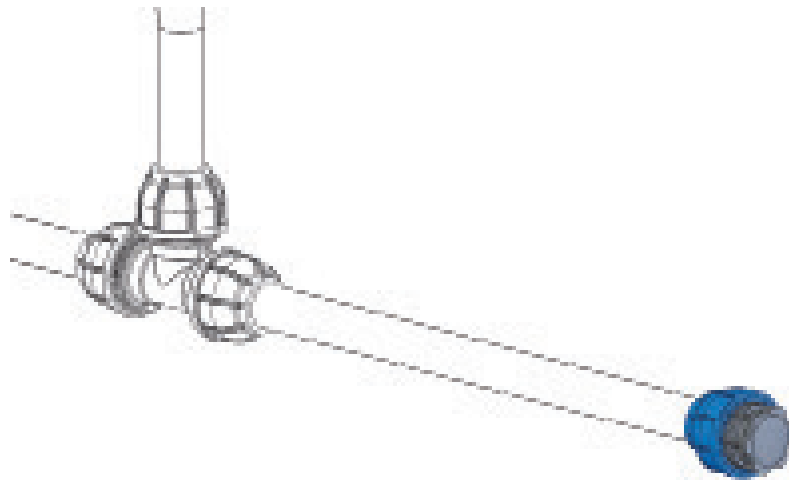
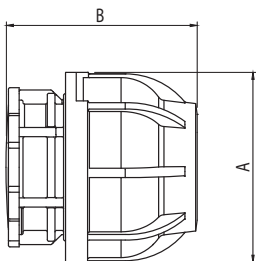



**STRAIGHT UNION FITTING WITH BALL VALVE**  
 RACCORDO DIRITTO CON VALVOLA A SFERA  
 RACOR RECTO CON VÁLVULA DE BOLA  
 RACCORD DROIT AVEC VANNE À BOISEAU SPHÉRIQUE  
 GERADER VERBINDER MIT KUGELHAHN

**NEW**



**EVO**

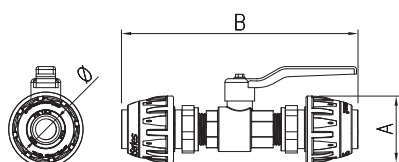

**CLASSIC**

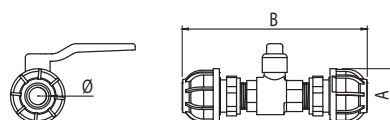

Code	Color	Ø	A	B	C	D			(g)
<b>EVO FITTING</b>									
SRR224.020.012	N	20x1/2"	44	159			-	-	250
SRR224.020.034	N	20x3/4"	44	172			-	-	299
SRR224.025.034	N	25x3/4"	52	179,5			-	-	449
SRR224.025.001	N	25x1"	52	200,5			-	-	605
SRR224.032.001	N	32x1"	62	203,5			-	-	774
SRR224.032.114	N	32x1 1/4"	62	220			-	-	675,5
SRR224.040.114	N	40x1 1/4"	72	233,5			-	-	1211
SRR224.040.112	N	40x1 1/2"	72	257,5			-	-	1092
SRR224.050.112	N	50x1 1/2"	86,50	275			-	-	1882
SRR224.050.002	N	50x2"	86,50	300,5			-	-	2618
SRR224.063.002	N	63x2"	105	316			-	-	2223
SRR224.063.212	N	63x2 1/2"	105				-	-	
SRG224.020.012	N	20x1/2"	44	159			-	-	250
SRG224.020.034	N	20x3/4"	44	172			-	-	299
SRG224.025.034	N	25x3/4"	52	179,5			-	-	449
SRG224.025.001	N	25x1"	52	200,5			-	-	605
SRG224.032.001	N	32x1"	62	203,5			-	-	774
SRG224.032.114	N	32x1 1/4"	62	220			-	-	675,5
SRG224.040.114	N	40x1 1/4"	72	233,5			-	-	1211
SRG224.040.112	N	40x1 1/2"	72	257,5			-	-	1092
SRG224.050.112	N	50x1 1/2"	86,50	275			-	-	1882
SRG224.050.002	N	50x2"	86,50	300,5			-	-	2618
SRG224.063.002	N	63x2"	105	316			-	-	2223
SRG224.063.212	N	63x2 1/2"	105				-	-	
SRA224.025.034	N	25x3/4"	52	179,5			-	-	449
SRA224.025.001	N	25x1"	52	200,5			-	-	605
SRA224.040.114	N	40x1 1/4"	72	233,5			-	-	1211
SRA224.040.112	N	40x1 1/2"	72	257,5			-	-	1092
<b>CLASSIC FITTING</b>									
R224.020.012	N	20x1/2"	44	150			-	-	218
R224.020.034	N	20x3/4"	44	150			-	-	218
R224.025.034	N	25x3/4"	52	170			-	-	334
R224.025.001	N	25x1"	52	170			-	-	334
R224.032.001	N	32x1"	62	195			-	-	577
R224.032.114	N	32x1 1/4"	62	195			-	-	577
R224.040.114	N	40x1 1/4"	72	225			-	-	787
R224.040.112	N	40x1 1/2"	72	225			-	-	787
R224.050.112	N	50x1 1/2"	86,5	260			-	-	1303
R224.050.002	N	50x2"	86,5	260			-	-	1303
R224.063.002	N	63x2"	105	305			-	-	2079
R224.063.212	N	63x2 1/2"	105	305			-	-	2079
A224.025.034	N	25x3/4"	52	170			-	-	334
A224.025.001	N	25x1"	52	170			-	-	334
A224.040.114	N	40x1 1/4"	72	225			-	-	787
A224.040.112	N	40x1 1/2"	72	225			-	-	787
V224.063.002	N	63x2"	105	305			-	-	2079
V224.063.212	N	63x2 1/2"	105	325			-	-	2079





**STRAIGHT UNION FITTING WITH BALL VALVE**  
 RACCORDO A 3 PEZZI CON VALVOLA A SFERA  
 RACOR DE 3 PIEZAS CON VÁLVULA DE BOLA  
 RACCORD AVEC VANNE À BOISEAU SPHÉRIQUE  
 3-TEILIGER VERBINDER MIT KUGELHAHN

**NEW**



**EVO**

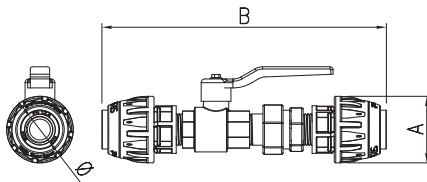

**CLASSIC**

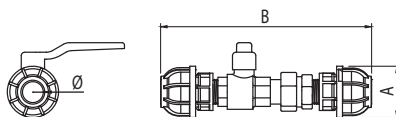

Code	Color	Ø	A	B	C	D			(g)
<b>EVO FITTING</b>									
SRR225.020.012	N	20x1/2"	44	191			-	-	350
SRR225.020.034	N	20x3/4"	44	213			-	-	477
SRR225.025.034	N	25x3/4"	52	216			-	-	570
SRR225.025.001	N	25x1"	52	245			-	-	769
SRR225.032.001	N	32x1"	62	250			-	-	991
SRR225.032.114	N	32x1 1/4"	62	260			-	-	900
SRR225.040.114	N	40x1 1/4"	72	287			-	-	1544
SRR225.040.112	N	40x1 1/2"	72	300			-	-	1250
SRR225.050.112	N	50x1 1/2"	86,50	327			-	-	2435
SRR225.050.002	N	50x2"	86,50	380			-	-	1850
SRR225.063.002	N	63x2"	105	385			-	-	3332
SRR225.063.212	N	63x2 1/2"	105	400			-	-	2750
SRR225.020.012	N	20x1/2"	44	191			-	-	350
SRG225.020.034	N	20x3/4"	44	213			-	-	477
SRG225.025.034	N	25x3/4"	52	216			-	-	570
SRG225.025.001	N	25x1"	52	245			-	-	769
SRG225.032.001	N	32x1"	62	250			-	-	991
SRG225.032.114	N	32x1 1/4"	62	260			-	-	900
SRG225.040.114	N	40x1 1/4"	72	287			-	-	1544
SRG225.040.112	N	40x1 1/2"	72	300			-	-	1250
SRG225.050.112	N	50x1 1/2"	86,50	327			-	-	2435
SRG225.050.002	N	50x2"	86,50	380			-	-	1850
SRG225.063.002	N	63x2"	105	385			-	-	3332
SRG225.063.212	N	63x2 1/2"	105	400			-	-	2750
SRA225.025.034	N	25x3/4"	52	216			-	-	570
SRA225.025.001	N	25x1"	52	245			-	-	769
SRA225.040.114	N	40x1 1/4"	72	287			-	-	1544
SRA225.040.112	N	40x1 1/2"	72	300			-	-	1250
<b>CLASSIC FITTING</b>									
R225.020.012	N	20x1/2"	44	180			-	-	324
R225.020.034	N	20x3/4"	44	190			-	-	324
R225.025.034	N	25x3/4"	52	205			-	-	497
R225.025.001	N	25x1"	52	215			-	-	497
R225.032.001	N	32x1"	62	240			-	-	858
R225.032.114	N	32x1 1/4"	62	255			-	-	858
R225.040.114	N	40x1 1/4"	72	275			-	-	1233
R225.040.112	N	40x1 1/2"	72	295			-	-	1233
R225.050.112	N	50x1 1/2"	86,50	315			-	-	1803
R225.050.002	N	50x2"	86,50	335			-	-	1803
R225.063.002	N	63x2"	105	375			-	-	2679
R225.063.212	N	63x2 1/2"	105	395			-	-	2679
A225.025.034	N	25x3/4"	52	205			-	-	497
A225.025.001	N	25x1"	52	215			-	-	497
A225.040.114	N	40x1 1/4"	72	275			-	-	1233
A225.040.112	N	40x1 1/2"	72	295			-	-	1233
V225.063.002	N	63x2"	105	375			-	-	2679
V225.063.212	N	63x2 1/2"	105	395			-	-	2679





**END CAP WITH MANUAL VENT VALVE**  
**TAPPO CON VALVOLA DI SCARICO MANUALE**  
**TAPÓN CON VÁLVULA DE DESCARGA MANUAL**  
**BOUCHON AVEC PURGE MANUELLE**  
**ENDSTOPFEN MIT ENTWÄSSERUNG**



**EVO**

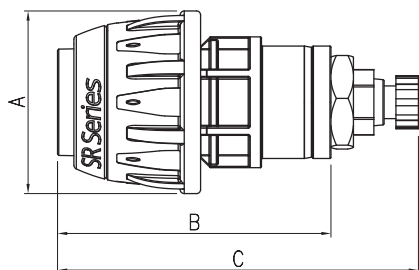

**CLASSIC**

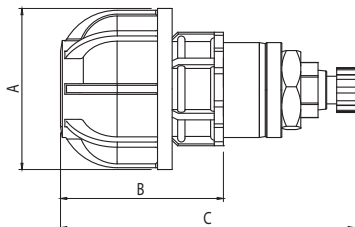

Code	Color	Ø	A	B	C	D			(g)
<b>EVO FITTING</b>									
SRR218.020.014		20	44	67	88		5	-	92
SRR248.025.014		25	52	53,5	88,5		5	-	104
SRR248.032.014		32	62	63	98		5	-	39
SRR248.040.014		40	72	68,5	103,5		1	-	170
SRR248.050.014		50	86,5	82,5	117,5		1	-	270
SRR248.063.014		63	105	94,50	129,5		1	-	397
SRG218.020.014		20	44	44,50	64,5		5	-	51
SRG248.025.014		25	52	53,50	88,5		5	-	104
SRG248.032.014		32	62	63	98		5	-	139
SRG248.040.014		40	72	68,5	103,5		1	-	170
SRG248.050.014		50	86,5	82,5	117,5		1	-	270
SRG248.063.014		63	105	94,5	129,5		1	-	397
SRA248.025.014		25	52	53,5	88,5		5	-	104
SRA248.040.014		40	72	68,5	103,5		1	-	170
<b>CLASSIC FITTING</b>									
R218.020.014		20	44	44,5	64,5		5	-	76
R248.025.014		25	52	53,5	88,5		5	-	99
R248.032.014		32	62	63	98		5	-	131
R248.040.014		40	72	68,5	103,5		1	-	170
R248.050.014		50	86,5	82,5	117,5		1	-	270
R248.063.014		63	105	94,5	129,5		1	-	397

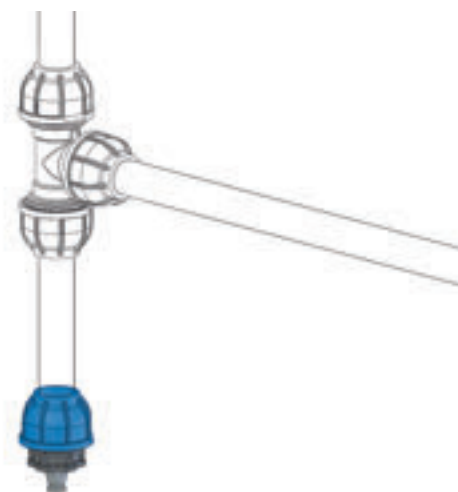



**REDUCING "TEE" FITTING**  
 RACCORDO "T" RIDOTTO  
 RACOR "T" REDUCIDO  
 RACCORD EN "T" RÉDUIT  
 T-REDUZIERSTÜCK



**EVO**

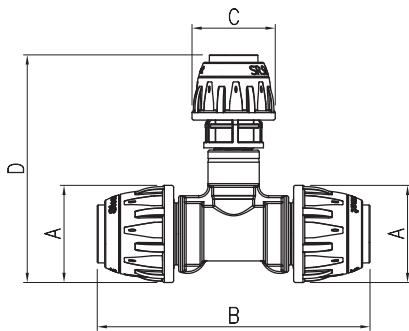

**CLASSIC**

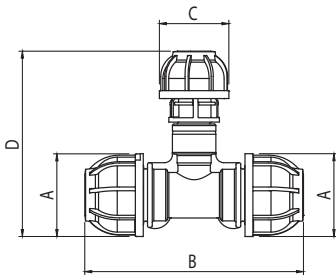

Code	Color	Ø	A	B	C	D			(g)
<b>EVO FITTING</b>									
SRR217.025.020		25X20X25	52	146	44	122	5	40	163
SRR217.032.020		32X20X32	62	172	44	142,5	5	30	248
SRR217.032.025		32X25X32	62	172	52	142,5	5	30	261
SRR217.040.020		40X20X40	72	195	44	158	1	20	375
SRR217.040.025		40X25X40	72	195	52	163,5	1	20	397
SRR217.040.032		40X32X40	72	195	62	170	1	15	418
SRR217.050.020		50X20X50	86,50	239	44	124	1	10	534,5
SRR217.050.025		50X25X50	86,50	239	52	129,5	1	10	550
SRR217.050.032		50X32X50	86,50	239	62	137	1	10	570
SRR217.050.040		50X40X50	86,50	239	72	196	1	5	717
SRR217.063.020		63X20X63	105	275,5	44	195	1	5	1046
SRR217.063.025		63X25X63	105	275,5	52	202	1	5	1068
SRR217.063.032		63X32X63	105	275,5	62	210	1	5	1079,5
SRR217.063.040		63X40X63	105	275,5	72	219	1	5	1123
SRR217.063.050		63X50X63	105	275,5	86,50	242,5	1	5	1216
SRG217.025.020		25X20X25	52	146	44	122	5	40	163
SRG217.032.020		32X20X32	62	172	44	142,5	5	30	248
SRG217.032.025		32X25X32	62	172	52	142,5	5	30	261
SRG217.040.020		40X20X40	72	195	44	158	1	20	375
SRG217.040.025		40X25X40	72	195	52	163,5	1	20	397
SRG217.040.032		40X32X40	72	195	62	170	1	15	418
SRG217.050.020		50X20X50	86,50	239	44	124	1	10	534,5
SRG217.050.025		50X25X50	86,50	239	52	129,5	1	10	550
SRG217.050.032		50X32X50	86,50	239	62	137	1	10	570
SRG217.050.040		50X40X50	86,50	239	72	196	1	5	717
SRG217.063.020		63X20X63	105	275,5	44	195	1	5	1046
SRG217.063.025		63X25X63	105	275,5	52	202	1	5	1068
SRG217.063.032		63X32X63	105	275,5	62	210	1	5	1079,5
SRG217.063.040		63X40X63	105	275,5	72	219	1	5	1123
SRG217.063.050		63X50X63	105	275,5	86,50	242,5	1	5	1216
SRA217.040.025		40X25X40	72	195	52	163,5	1	20	397
<b>CLASSIC FITTING</b>									
R217.025.020		25X20X25	52	132	44	121	5	40	151
R217.032.020		32X20X32	62	159,5	44	95	5	30	207
R217.032.025		32X25X32	62	159,5	52	105	5	30	227
R217.040.020		40X20X40	72	182	44	150	1	20	355
R217.040.025		40X25X40	72	182	52	161	1	20	373
R217.040.032		40X32X40	72	182	62	169	1	15	399
R217.050.020		50X20X50	86,5	225	44	118	1	10	629
R217.050.025		50X25X50	86,5	225	52	125	1	10	648
R217.050.032		50X32X50	86,5	225	62	137	1	10	670
R217.050.040		50X40X50	86,5	225	72	196	1	5	725
R217.063.020		63X20X63	105	262	44	195	1	5	1002
R217.063.025		63X25X63	105	262	52	206	1	5	1024
R217.063.032		63X32X63	105	262	62	214	1	5	1031
R217.063.040		63X40X63	105	262	72	223	1	5	1125
R217.063.050		63X50X63	105	262	86,5	235	1	5	1144
A217.040.025		40X25X40	72	182	52	161	1	20	373

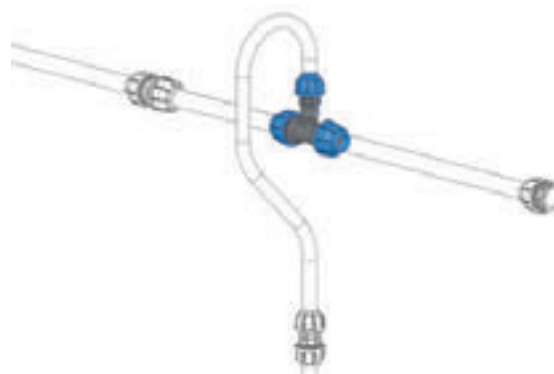



**END CAP WITH BALL VALVE**  
 TAPPO CON VALVOLA A SFERA  
 TAPÓN CON VÁLVULA DE BOLA  
 BOUCHON AVEC VANNE À BOISEAU SPHÉRIQUE  
 ENDSTOPFEN MIT KUGELHAHN

**NEW**



**EVO**

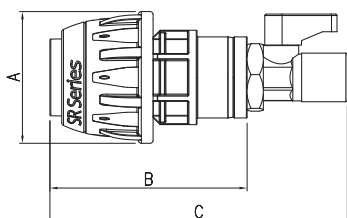

Code	Color	Ø	A	B	C	D			(g)
<b>EVO FITTING</b>									
SRR219.020.014		20x <sup>1</sup> / <sub>4</sub> "	44	67	104		5	-	87
SRR249.025.014		25x <sup>1</sup> / <sub>4</sub> "	52	58	106		5	-	137
SRR249.032.014		32x <sup>1</sup> / <sub>4</sub> "	62	67	115		5	-	169,5
SRR249.040.014		40x <sup>1</sup> / <sub>4</sub> "	72	74,5	123		1	-	208
SR249.050.014		50x <sup>1</sup> / <sub>4</sub> "	86,50	89,5	137		1	-	302
SRR249.063.014		63x <sup>1</sup> / <sub>4</sub> "	105	101	148		1	-	430
SRG219.020.014		20x <sup>1</sup> / <sub>4</sub> "	44	67	104		5	-	87
SRG249.025.014		25x <sup>1</sup> / <sub>4</sub> "	52	58	106		5	-	137
SRG249.032.014		32x <sup>1</sup> / <sub>4</sub> "	62	67	115		5	-	169,5
SRG249.040.014		40x <sup>1</sup> / <sub>4</sub> "	72	74,5	123		1	-	208
SRG249.050.014		50x <sup>1</sup> / <sub>4</sub> "	86,50	89,5	137		1	-	302
SRG249.063.014		63x <sup>1</sup> / <sub>4</sub> "	105	101	148		1	-	430
SRA249.025.014		25x <sup>1</sup> / <sub>4</sub> "	52	58	106		5	-	137
SRA249.040.014		40x <sup>1</sup> / <sub>4</sub> "	72	74,5	123		1	-	208
<b>CLASSIC FITTING</b>									
R219.020.014		20x <sup>1</sup> / <sub>4</sub> "	44	44,50	74,50		5	-	102
R249.025.014		25x <sup>1</sup> / <sub>4</sub> "	52	53,50	98,50		5	-	126
R249.032.014		32x <sup>1</sup> / <sub>4</sub> "	62	63	108		5	-	158
R249.040.014		40x <sup>1</sup> / <sub>4</sub> "	72	68,50	113,50		1	-	194
R249.050.014		50x <sup>1</sup> / <sub>4</sub> "	86,50	82,50	127,50		1	-	297
R249.063.014		63x <sup>1</sup> / <sub>4</sub> "	105	94,50	139,50		1	-	429
A249.025.014		25x <sup>1</sup> / <sub>4</sub> "	52	53,50	98,50		5	-	126
A249.040.014		40x <sup>1</sup> / <sub>4</sub> "	72	68,50	113,50		5	-	194

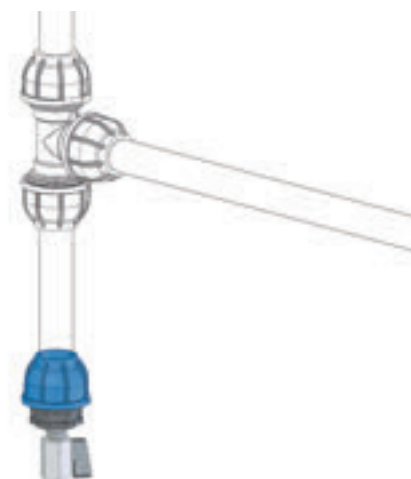

**CLASSIC**

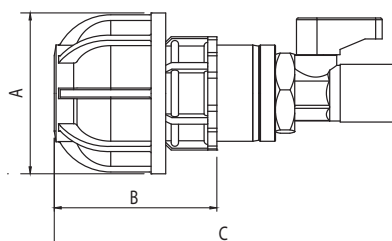



**FEMALE "TEE" FITTING**  
 RACCORDO "T" FEMMINA  
 EMPALME EN "T" HEMBRA  
 RACCORD EN "T" FEMELLE  
 T-STÜCK MIT INNENGEWINDE



EVO

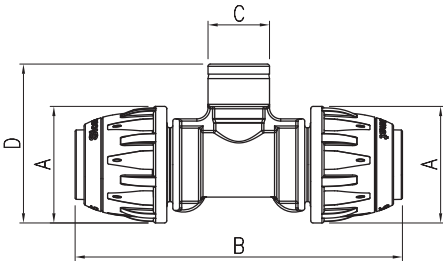

CLASSIC

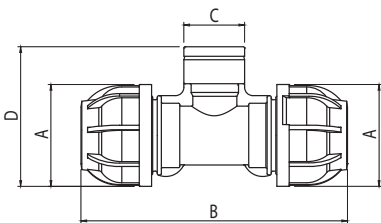

Code	Color	Ø	A	B	C	D			(g)
<b>EVO FITTING</b>									
SRR215.025.012		25x1/2"x25	52	146	30	75	5	60	127
SRR215.032.034		32x3/4"x32	62	172	37	85	5	35	200,5
SRR215.040.001		40x1"x40	72	195	43	103	1	20	323,5
SRR215.050.112		50x1 1/2"x50	56,5	239	62	121	1	10	552,5
SRR215.063.002		63x2"x63	105	275,5	77	148	1	8	890
SRG215.025.012		25x1/2"x25	52	146	30	75	5	60	127
SRG215.032.034		32x3/4"x32	62	172	37	85	5	35	200,5
SRG215.040.001		40x1"x40	72	195	43	103	1	20	323,5
SRG215.050.112		50x1 1/2"x50	56,5	239	62	121	1	10	552,5
SRG215.063.002		63x2"x63	105	275,5	77	148	1	8	890
SRA215.025.012		25x1/2"x25	52	146	30	75	5	60	127
SRA215.040.001		40x1"x40	72	195	43	103	1	20	323,5
<b>CLASSIC FITTING</b>									
R215.025.012		25x1/2"x25	52	132	30	75	5	60	118
R215.032.034		32x3/4"x32	62	159,5	37	85	5	35	193
R215.040.001		40x1"x40	72	182	43	103	1	20	300
R215.050.112		50x1 1/2"x50	56,5	225	62	121	1	10	550
R215.063.002		63x2"x63	105	262	77	148	1	8	874
A215.025.012		25x1/2"x25	52	132	30	75	5	60	118
A215.040.001		40x1"x40	72	182	43	103	1	20	300
V215.063.002		63x2"x63	105	262	77	148	1	8	874

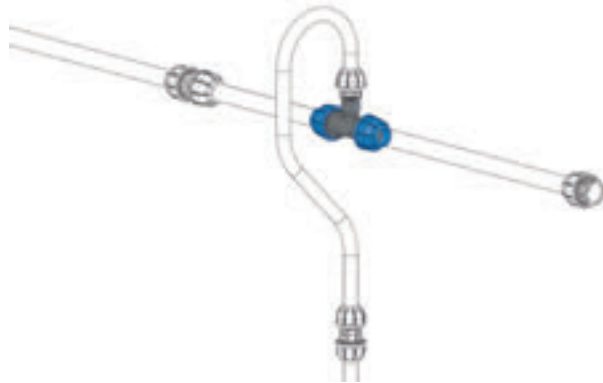



**DRY AIR DROP TEE FITTING**

RACCORDO "T" RIDOTTO PER CALATA  
 RACOR "T" REDUCIDO PARA BAJADA  
 RACCOR EN "T" REDUIT POUR DESCENTE  
 T-REDUZIERSTÜCK MIT KONDENSAT-STOPP

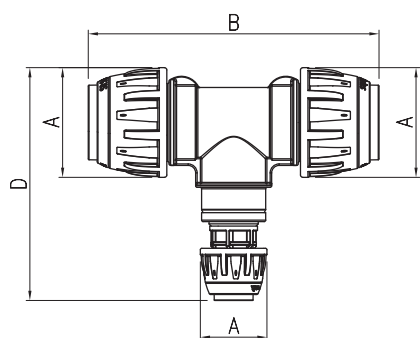

**EVO**

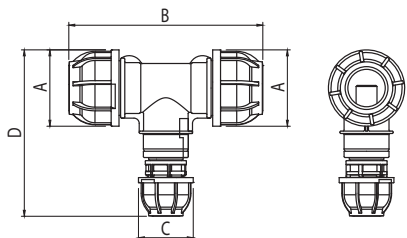

**CLASSIC**

Code	Color	Ø	A	B	C	D	⊞	⊞	(g)
<b>EVO FITTING</b>									
SRR247.040.020	N	40x20x40	72	195	44	156	1	20	384,5
SRR247.040.025	N	40x25x40	72	195	52	163,5	1	20	406,5
SRR247.050.020	N	50x20x50	86,5	239	44	170,5	1	10	735
SRR247.050.025	N	50x25x50	86,5	239	52	178	1	10	757,5
SRR247.050.032	N	50x32x50	86,5	239	62	186	1	10	703
SRR247.050.040	N	50x40x50	86,5	239	72	196	1	10	746,5
SRR247.063.020	N	63x20x63	105	275,5	44	193	1	5	1063,5
SRR247.063.025	N	63x25x63	105	275,5	52	200,5	1	5	1102,5
SRR247.063.032	N	63x32x63	105	275,5	62	209,5	1	5	1109,5
SRR247.063.040	N	63x40x63	105	275,5	72	219	1	5	1152,5
SRR247.063.050	N	63x50x63	105	275,5	86,5	241,5	1	5	1269,5
SRG247.040.020	N	40x20x40	72	195	44	156	1	20	384,5
SRG247.040.025	N	40x25x40	72	195	52	163,5	1	20	406,5
SRG247.050.020	N	50x20x50	86,5	239	44	170,5	1	10	735
SRG247.050.025	N	50x25x50	86,5	239	52	178	1	10	757,5
SRG247.050.032	N	50x32x50	86,5	239	62	186	1	10	703
SRG247.050.040	N	50x40x50	86,5	239	72	196	1	10	746,5
SRG247.063.020	N	63x20x63	105	275,5	44	193	1	5	1063,5
SRG247.063.025	N	63x25x63	105	275,5	52	200,5	1	5	1102,5
SRG247.063.032	N	63x32x63	105	275,5	62	209,5	1	5	1109,5
SRG247.063.040	N	63x40x63	105	275,5	72	219	1	5	1152,5
SRG247.063.050	N	63x50x63	105	275,5	86,5	241,5	1	5	1269,5
SRA247.040.025	N	40x25x40	72	195	52	163,5	1	20	406,5
<b>CLASSIC FITTING</b>									
R247.040.020	N	40x20x40	72	182	44	150	1	20	380
R247.040.025	N	40x25x40	72	182	52	161	1	20	398
R247.050.020	N	50x20x50	86,5	225	44	168	1	10	654
R247.050.025	N	50x25x50	86,5	225	52	179	1	10	673
R247.050.032	N	50x32x50	86,5	225	62	187	1	10	700
R247.050.040	N	50x40x50	86,5	225	72	196	1	10	755
R247.063.020	N	63x20x63	105	262	44	195	1	5	1027
R247.063.025	N	63x25x63	105	262	52	206	1	5	1049
R247.063.032	N	63x32x63	105	262	62	214	1	5	1061
R247.063.040	N	63x40x63	105	262	72	223	1	5	1055
R247.063.050	N	63x50x63	105	262	86,5	235	1	5	1044
A247.040.025	N	40x25x40	72	182	52	161	1	20	398

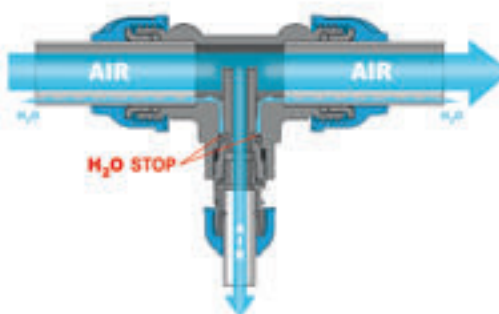



**DRY AIR TAKE-OFF ADAPTER**

PRESA ARIA PER ATTACCO INTERMEDIO  
TOMA DE AIRE PARA CONEXIÓN INTERMEDIA  
BRIDE DE PIQUAGE  
ABZWEIG-FLANSCH

Code	Ø	A	B	C	D			(g)
<b>R259.025.000</b>	25	78	95	40	1/2"	1	1	170
<b>R259.032.000</b>	32	78	95	40	1/2"	1	1	160



ANTICONDENSATE

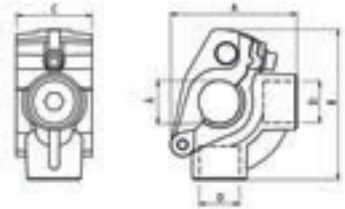
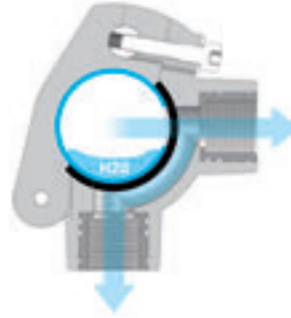

**DRY AIR TAKE-OFF ADAPTER**

PRESA ARIA PER ATTACCO INTERMEDIO  
TOMA DE AIRE PARA CONEXIÓN INTERMEDIA  
BRIDE DE PIQUAGE  
ABZWEIG-FLANSCH

Code	Ø	A	B	C	D			(g)
<b>R208.040.040</b>	40	85	93	50	1/2"	1	1	255
<b>R208.050.063</b>	50	134	146,50	80	1"	1	1	974
<b>R208.063.063</b>	63	134	146,50	80	1"	1	1	841



ANTICONDENSATE

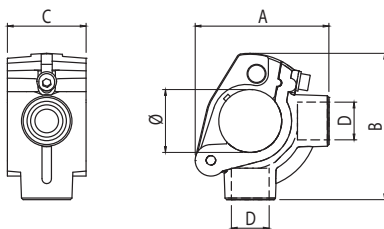
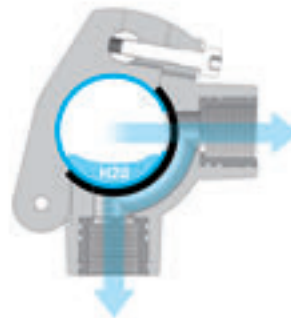



**THREADED DROP CONNECTION**

DERIVAZIONE FILETTATA  
 DERIVACIÓN ROSCADA  
 BRIDE DE PIQUAGE TARAUEE  
 GEWINDEAUSGANG

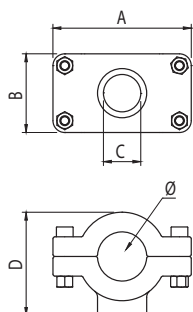

Code	Ø	A	B	C	D			(g)
<b>QSB2012</b>	20	62	37	1/2"	55,50	1	-	433
<b>QSB2512</b>	25	65	40	1/2"	57,50	1	-	63
<b>QSB3212</b>	32	78	45	1/2"	59,50	1	-	102
<b>QSB4012</b>	40	86	51	1/2"	69	1	-	121
<b>QSB5012</b>	50	86	53	1/2"	78	1	-	122
<b>QSB6312</b>	63	94	71	1/2"	93,50	1	-	235
<b>QSB2534</b>	25	65	40	3/4"	57,50	1	-	69
<b>QSB3234</b>	32	78	45	3/4"	60	1	-	107
<b>QSB4034</b>	40	86	51	3/4"	72	1	-	123
<b>QSB5034</b>	50	86	53	3/4"	79	1	-	126
<b>QSB6334</b>	63	95	71	3/4"	96	1	-	238



**PIPE CLIP**

COLLARE  
 COLLARÍN  
 COLLIER  
 HALTERING

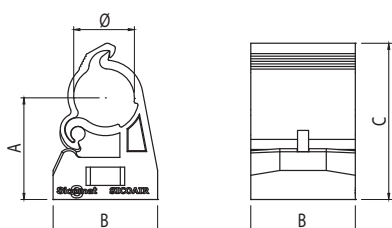

Code	Ø	A	B	C	D			(g)
<b>R244.020.000</b>	20	35	36	54		25	-	18
<b>R244.025.000</b>	25	35	36	56		25	-	18
<b>R244.032.000</b>	32	45	36	70		10	-	26
<b>R244.040.000</b>	40	45	36	75		10	-	28
<b>R244.050.000</b>	50	55	36	92		10	-	34
<b>R244.063.000</b>	63	55	36	98		10	-	36





**SPACER**  
DISTANZIALE  
DISTANCIADOR  
ENTRETOISE  
DISTANZPLATTE

Code	Ø	A	B	C	D			(g)
<b>R244.000.010</b>	9	10	36			10	-	8

**To be used with / Da utilizzare con / Para usar con / À utiliser avec / Zur Anwendung mit**



**R244.020.000 - R244.025.000 - R244.032.000**  
**R244.040.000 - R244.050.000 - R244.063.000**

Pipe clip

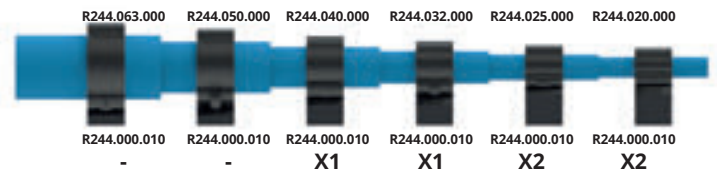
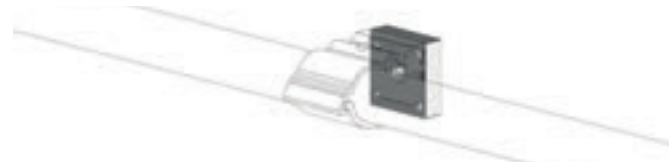
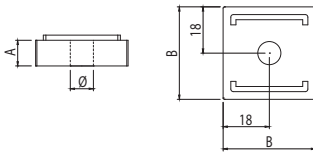
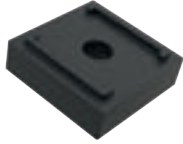

**EPDM INSERT**  
INSERTO IN EPDM  
INSERTO EN EPDM  
INSERT EN EPDM  
EINSATZ AUS EPDM

Code	Ø	A	B	C	D			(g)
<b>R244.000.030</b>		9	36	2		10	-	1

**To be used with / Da utilizzare con / Para usar con / À utiliser avec / Zur Anwendung mit**  
R244.020.000 - R244.025.000 - R244.032.000 - R244.040.000 - R244.050.000 - R244.063.000

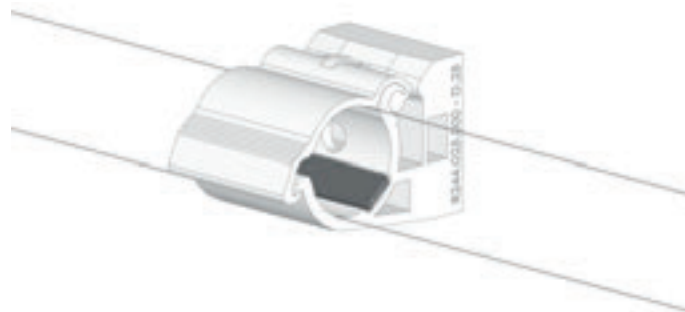
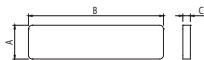

**RAWLPLUG ADAPTER**  
ADATTATORE PER TASSELLO  
ADAPTADOR PARA TACO  
ADAPTATEUR POUR CHEVILLE  
ADAPTER FÜR DÜBEL

Code	Ø	A	B	C	D			(g)
<b>R244.000.020</b>	5,2	5,8	35	12,8		10	-	5

**To be used with / Da utilizzare con / Para usar con / À utiliser avec / Zur Anwendung mit**  
R244.020.000 - R244.025.000 - R244.032.000 - R244.040.000 - R244.050.000 - R244.063.000

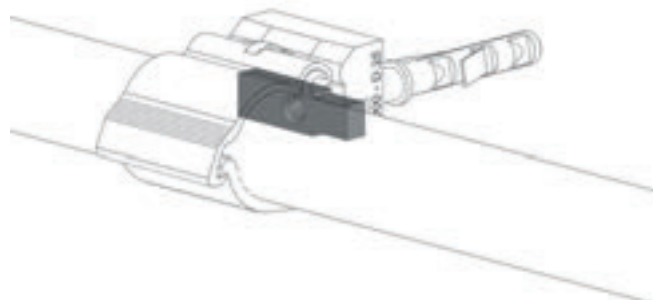
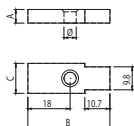
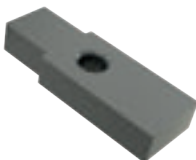



### PIPE CLIPS ATTACHMENT

MODALITÀ DI FISSAGGIO DEI COLLARI / MODOS DE FIJACIÓN DE LOS COLLARINES / MODE DE FIXATION DES COLLIERS / BEFESTIGUNGSMODUS DER HALTERINGE

#### A) Mounting with screw and nut

Montaggio con vite e controdamo / Montaje con tornillo y contratuera / Installation avec vis et écrou de serrage / Montage mit Schraube und Kontermutter

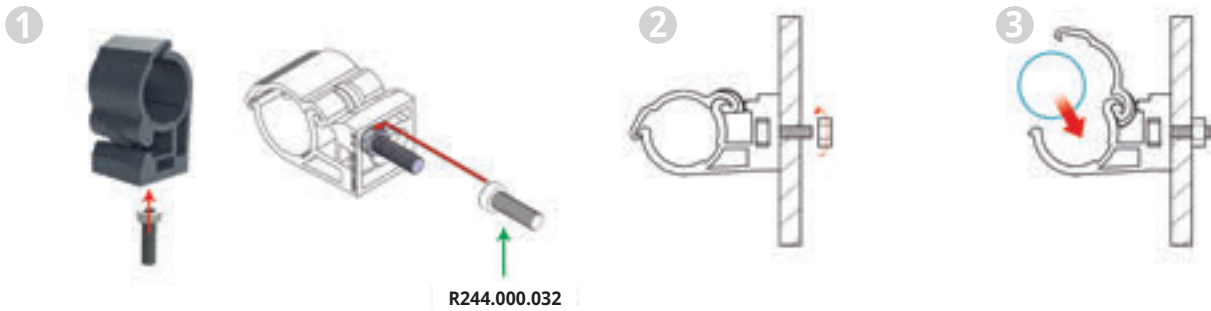

#### B) Mounting with screw and external nut

Montaggio con dado e vite esterna / Montaje con tuerca y tornillo exterior / Installation avec écrou et vis externe / Montage mit Mutter und externer Schraube

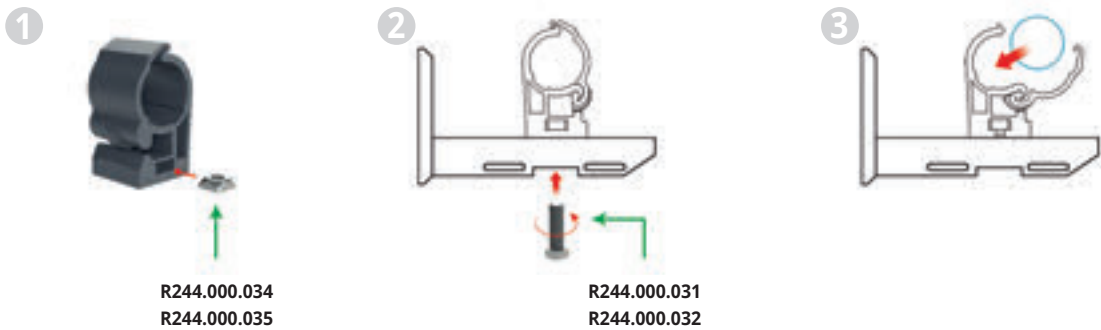

#### C) Mounting with threaded rawlplug

Montaggio con tassello filettato / Montaje con taco roscado / Installation avec cheville taraudée / Montage mit Dübel

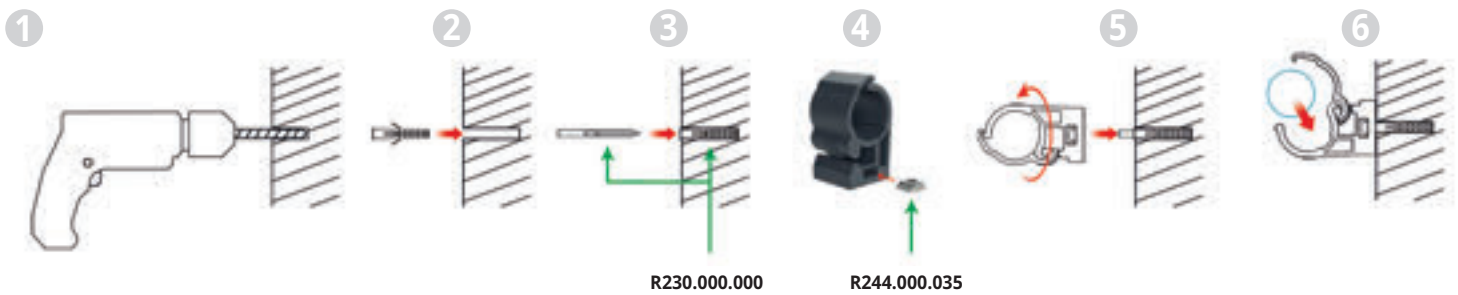

#### D) Mounting with rawlplug

Montaggio con tassello / Montaje con taco / Installation avec cheville / Montage mit Dübel





## INSTALLATION OF THE PIPES

MONTAGGIO DEI TUBI / MONTAJE DE LOS TUBOS / INSTALLATION DES TUBES / MONTAGE DER ROHRE

Vertical or horizontal pipe assembly.

The particular shape of the EVO **Alusic** pipe clip ensures the retention of the tube until the catching lid is closed.

Possibilità di montaggio del tubo verticalmente e orizzontalmente. La particolare forma dei nuovi collari **Alusic** garantisce il trattenimento del tubo fino al momento della chiusura del coperchio ad aggancio.

Posibilidad de montar el tubo vertical y horizontalmente. La forma especial de los nuevos collarines **Alusic** garantiza la retención del tubo hasta cerrar la tapa de enganche.

Possibilité de installation du tube verticalement et horizontalement. La forme particulière des nouveaux collier **Alusic** assure la retenue du tube jusqu'au moment de la fermeture du couvercle par accrochage.

Vertikale und horizontale Montagemöglichkeit des Rohrs. Die besondere Form der neuen **Alusic** Halteringe garantiert das Festhalten des Rohrs bis sich der Rastdeckel schließt.

### Vertical installation

Installazione verticale/Instalación vertical/  
Installation vertical/Vertikale Installation

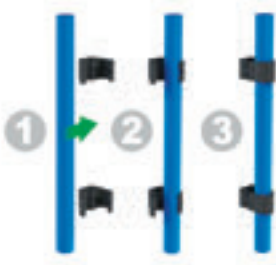

### Horizontal installation

Installazione orizzontale/Instalación horizontal/  
Installation horizontal/Horizontale Installation



## SAFETY RELEASE SYSTEM

SISTEMA DI SGANCIO IN SICUREZZA / SISTEMA DE DESENGANCHE DE SEGURIDAD  
SYSTÈME DE DÉCROCHAGE EN TOUTE SÉCURITÉ / SICHERES ENTRIEGELUNGSSYSTEM

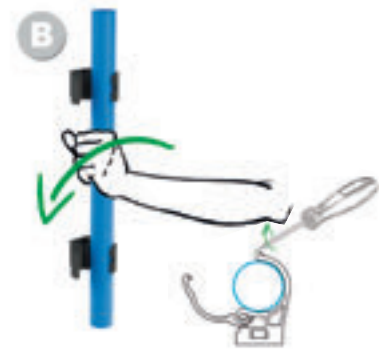

### Efficient locking system with the two large hooking areas between the pipe clip body and lid

Elevata resistenza all'apertura grazie alle ampie superfici di aggancio tra corpo e coperchio del collare

Gran resistencia a la apertura gracias a la amplia superficie de enganche entre el cuerpo y la tapa del collarín

Haute résistance à l'ouverture grâce aux amples surfaces d'accrochage entre le corps et le couvercle du collier

Hoher Öffnungswiderstand durch die großen Befestigungsflächen zwischen Körper und Deckel des Halterings

### Quick and easy opening just by using a slotted screwdriver through the unhooking hole on the front side of the pipe clip

Apertura facile e rapida con l'impiego di un semplice cacciavite a taglio tramite il foro di sgancio presente nella parte frontale del collare

Apertura fácil y rápida utilizando simplemente un destornillador de corte a través de orificio de desenganche que se encuentra en la parte frontal del collarín

Ouverture facile et rapide avec un simple tournevis plat, introduit dans l'orifice de décrochage présent sur la partie frontale du collier

Leichtes und schnelles Öffnen mithilfe eines einfachen Schlitzschraubenziehers über die im Vorderteil des Halterings vorhandene Entriegelungsöffnung



**SCREW M6 - M8**

VITE  
TORNILLO  
VIS  
SCHRAUBE

Code	M	A	B	C	D			(g)
R244.000.031	M6	20	10			-	200	4
R244.000.032	M8	20	13			-	200	10
R244.000.036	M8	30	13			-	200	15
R244.000.037	M8	40	13			-	200	18

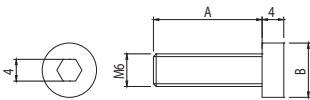

**M8 only for / M8 solo per / M8 solo para / M8 seulement pour / M8 nur für**



R244.020.000 - R244.025.000 - R244.032.000  
R244.040.000 - R244.050.000 - R244.063.000

Pipe clip

**SQUARE NUT M6 - M8**

DADO QUADRO  
TUERCA CUADRADA  
ÉCROU CARRÉ  
VIERKANTMUTTER

Code	M	A	B	C	D			(g)
R244.000.034	M6	6	13			-	1500	3
R244.000.035	M8	6	13			-	1500	3

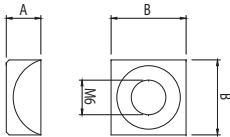

**M8 only for / M8 solo per / M8 solo para / M8 seulement pour / M8 nur für**



R244.020.000 - R244.025.000 - R244.032.000  
R244.040.000 - R244.050.000 - R244.063.000

Pipe clip

**RAWLPLUG**

TASSELLO  
TACO  
CHEVILLE  
DÜBEL

Code	M	A	B	C	D			(g)
R244.000.033		45	d6			-	-	15

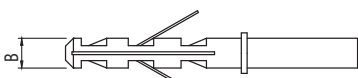
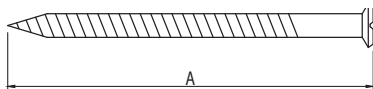

**To be used with / Da utilizzare con / Para usar con / À utiliser avec / Zur Anwendung mit**



R244.020.000 - R244.025.000 - R244.032.000  
R244.040.000 - R244.050.000 - R244.063.000

Pipe clip



**CROSS TAKE OFF FITTING**

GIUNZIONE A CROCE  
JUNTA CRUCETA  
JONCTION CRUCIFORME  
KREUZVERBINDER

Code	Ø	A	B	C	D			(g)
<b>ML215.020.012</b>	20	70	54	40		-	-	65
<b>ML215.025.012</b>	25	70	54	40		-	-	65

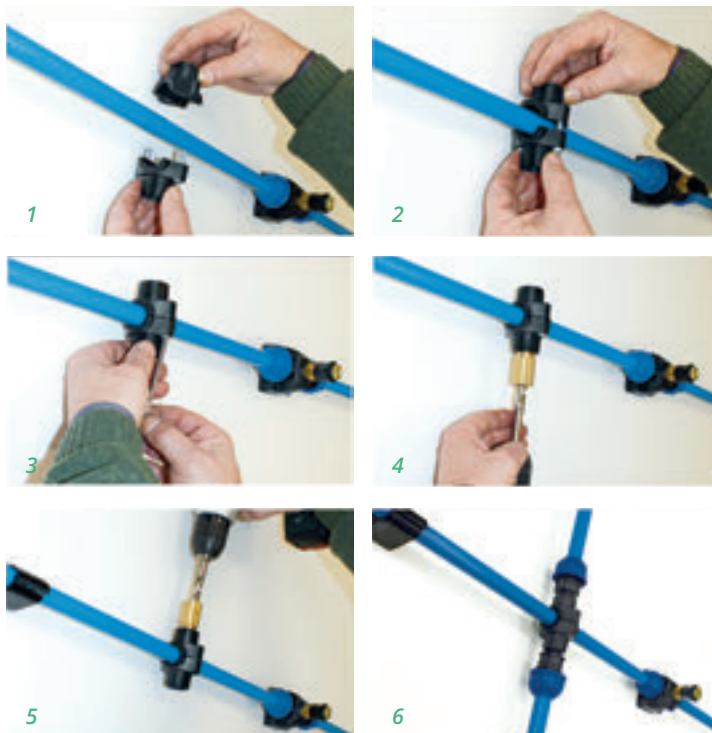
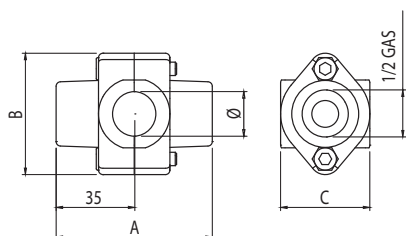

**ANGLED WALL BRACKET**

DERIVAZIONE INCLINATA CON PUNTO DI ANCORAGGIO INTEGRATO  
DERIVACIÓN INCLINADA CON PUNTO DE ANCLAJE INTEGRADO  
BRIDE DE PIQUAGE INCLINÉE AVEC POINT D'ANCRAGE INCORPORÉ  
SCHRÄGER ABZWEIG MIT INTEGRIERTEM BEFESTIGUNGSPUNKT

Code	Ø	A	B	C	D			(g)
<b>ML231.020.012</b>	20	90	54	40		-	-	65
<b>ML231.025.012</b>	25	90	54	40		-	-	65

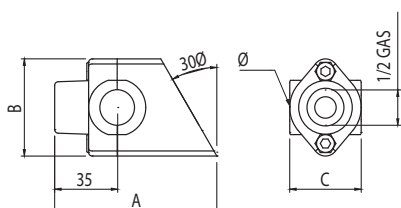

**WALL BRACKET**

DERIVAZIONE CON PUNTO DI ANCORAGGIO INTEGRATO  
 DERIVACIÓN CON PUNTO DE ANCLAJE INTEGRADO  
 BRIDE DE PIQUAGE AVEC POINT D'ANCRAGE INCORPORÉ  
 ABZWEIG MIT INTEGRIERTEM BEFESTIGUNGSPUNKT

Code	Ø	A	B	C	D			(g)
<b>ML241.020.012</b>	20	70	54	40		-	-	65
<b>ML241.025.012</b>	25	70	54	40		-	-	65

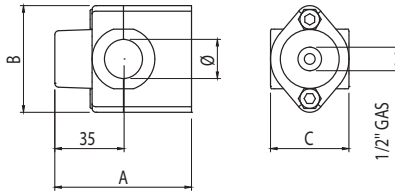
**TAKE-OFF ADAPTER**

DERIVAZIONE SEMPLICE  
 DERIVACIÓN  
 BRIDE DE PIQUAGE  
 ABZWEIG

Code	Ø	A	B	C	D			(g)
<b>ML214.020.012</b>	20	51	54	40		-	-	50
<b>ML214.025.012</b>	25	51	54	40		-	-	50

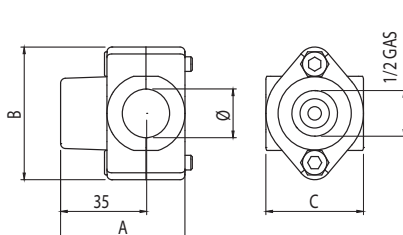



**RAWLPLUG MALE THREADED**  
 TASSELLO FILETTATO MASCHIO  
 TACO ROSCADO MACHO  
 CHEVILLE TARAUDÉE MÂLE  
 DÜBEL MIT AUSSENGEWINDE

Code	M	A	B	C	D			(g)
<b>R230.000.000</b>	M8	90	10			-	-	26

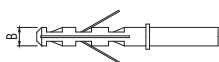
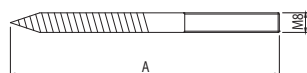

**PIPE CLAMP (M8 / M10)**

COLLARI PER FISSAGGIO TUBI (M8 / M10)  
 COLLARÍN PARA FIJACIÓN DE TUBOS (M8 / M10)  
 COLLIERS POUR FIXER LES TUBES (M8 / M10)  
 HALTERINGE FÜR ROHRBEFESTIGUNG (M8 / M10)

Code	Ø	A	B	C	D			(g)
<b>R230.020.000</b>	20	M8/M10	M6	20		-	-	72
<b>R230.025.000</b>	25	M8/M10	M6	20		-	-	80
<b>R230.032.000</b>	32	M8/M10	M6	20		-	-	90
<b>R230.040.000</b>	40	M8/M10	M6	25		-	-	99
<b>R230.050.000</b>	50	M8/M10	M6	25		-	-	115
<b>R230.063.000</b>	63	M8/M10	M6	25		-	-	128

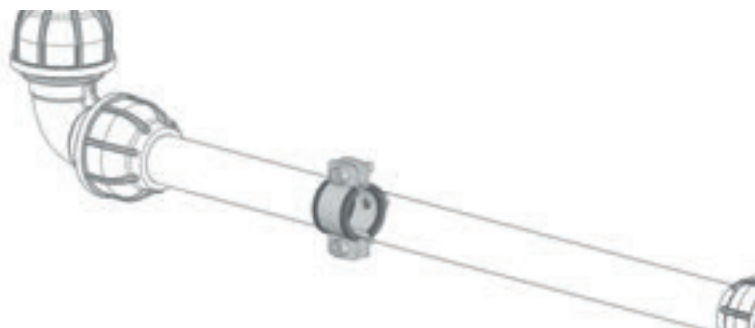
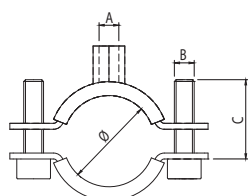

**PIPE CLAMP FOR ATTACHMENT WITH RAWLPLUG**

COLLARI PER FISSAGGIO TUBI CON TASSELLO  
 COLLARÍN PARA FIJACIÓN DE TUBOS CON TACO  
 COLLIERS POUR FIXER LES TUBES AVEC LA CHEVILLE  
 HALTERINGE FÜR ROHRBEFESTIGUNG MIT DÜBEL

Code	Ø	A	B	C	D			(g)
<b>R240.020.000</b>	20	M8/M10	M6	20		-	-	101
<b>R240.025.000</b>	25	M8/M10	M6	20		-	-	107
<b>R240.032.000</b>	32	M8/M10	M6	20		-	-	117
<b>R240.040.000</b>	40	M8/M10	M6	25		-	-	125
<b>R240.050.000</b>	50	M8/M10	M6	25		-	-	133
<b>R240.063.000</b>	63	M8/M10	M6	25		-	-	145

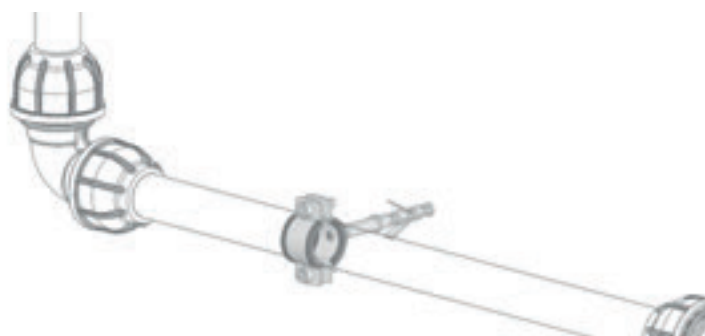
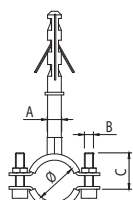

**BEAM CLIP**

MORSETTO ANCORAGGIO SU TRAVI  
MORDAZA DE ANCLAJE  
BRIDE D'ANCRAGE  
TRÄGERKLEMME

Code	Ø	A	B	C	D	(g)
<b>R230.000.001</b>	M6	30	34			27

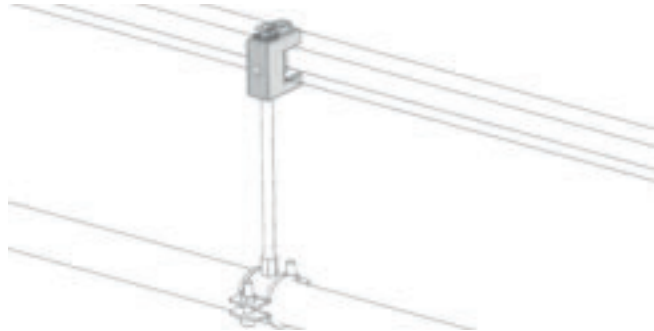
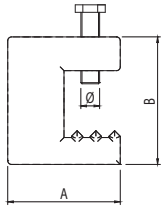
**BEAM CLIP**

MORSETTO ANCORAGGIO SU TRAVI  
MORDAZA DE ANCLAJE  
BRIDE D'ANCRAGE  
TRÄGERKLEMME

Code	Ø	A	B	C	D	(g)
<b>R233.000.001</b>	11	3/8				30
<b>R233.000.002</b>	11	8/14				32
<b>R233.000.003</b>	11	14/20				33

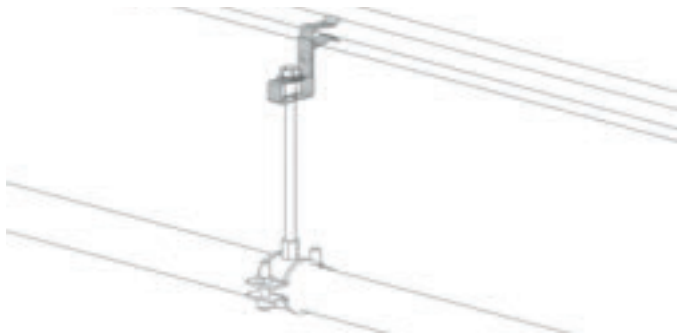
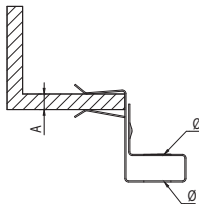
**BEAM CLIP**

MORSETTO ANCORAGGIO SU TRAVI  
MORDAZA DE ANCLAJE  
BRIDE D'ANCRAGE  
TRÄGERKLEMME

Code	Ø	A	B	C	D	(g)
<b>R234.000.001</b>	9					79
<b>R234.000.002</b>	M8					82

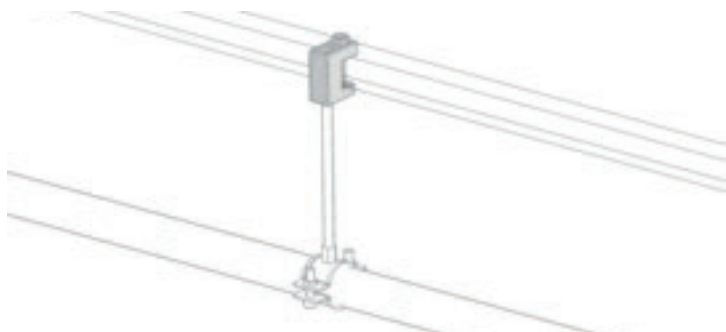
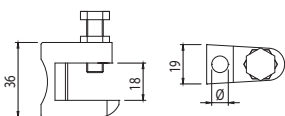



**NYLON AND ALUMINIUM FITTING REDUCER**

RIDUZIONE IN NYLON E ALLUMINIO PER RACCORDI  
 REDUCCIÓN DE NYLON Y ALUMINIO PARA RACORES  
 RÉDUCEUR EN NYLON ET EN ALUMINIUM POUR RACCORDS  
 REDUZIERSTÜCK AUS NYLON UND ALUMINIUM FÜR VERBINDER

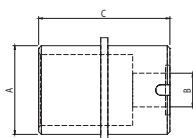

Code	Ø	A	B	C	D			(g)
R237.025.012*		25	1/2"	65		1	-	42
R237.032.012		32	1/2"	57		1	-	34
R237.040.012		40	1/2"	62		1	-	68
R237.040.001		40	1"	62		1	-	36
R237.050.012		50	1/2"	74		1	-	144
R237.050.001		50	1"	74		1	-	103
R237.063.012		63	1/2"	77		1	-	254
R237.063.001		63	1"	77		1	-	210
R237.063.112		63	1 1/2"	77		1	-	133

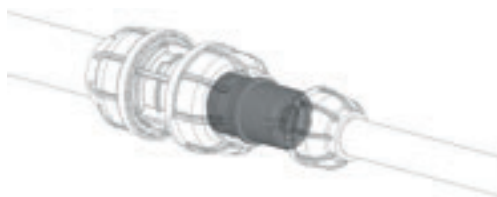

**THREADED NYLON FITTING REDUCER (WITH O-RING)**

RIDUZIONE FILETTATA IN NYLON (TENUTA CON OR)  
 REDUCCIÓN ROSCADA DE NYLON (CON JUNTA TÓRICA)  
 RÉDUCEUR TARAUDÉ EN NYLON (JOINT TORIQUE)  
 GEWINDE-REDUZIERSTÜCK AUS NYLON (DICHTIGKEIT MIT O-RING)

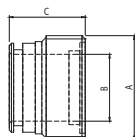

Code	Ø	A	B	C	D			(g)
R238.034.012		3/4"	1/2"	30		1	-	6
R238.001.012		1"	1/2"	32		1	-	1
R238.112.012		1 1/2"	1/2"	35		1	-	45
R238.112.001		1 1/2"	1"	35		1	-	25
R238.002.012		2"	1/2"	41		1	-	95
R238.002.001		2"	1"	41		1	-	69
R238.002.112		2"	1 1/2"	41		1	-	36

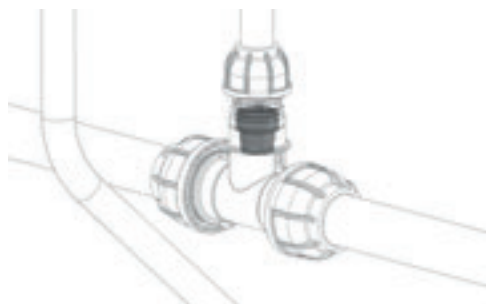

**ALUMINIUM REDUCER**

RIDUZIONE IN ALLUMINIO  
 REDUCCIÓN DE ALUMINIO  
 RÉDUCEUR EN ALUMINIUM  
 REDUZIERSTÜCK AUS ALUMINIUM

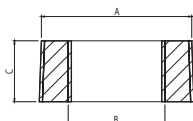

Code	Ø	A	B	C	D			(g)
R232.034.012		3/4"	1/2"	14,50		5	-	7
R232.001.012		1"	1/2"	17		5	-	22
R232.001.034		1"	3/4"	17		5	-	20
R232.114.012		1 1/4"	1/2"	19		1	-	62
R232.114.034		1 1/4"	3/4"	19		1	-	47
R232.112.012		1 1/2"	1 1/2"	19		1	-	50
R232.112.034		1 1/2"	3/4"	19		1	-	48
R232.112.001		1 1/2"	1"	19		1	-	46
R232.002.012		2"	1/2"	23		1	-	148
R232.002.034		2"	3/4"	23		1	-	122
R232.002.001		2"	1"	23		1	-	117
R232.002.112		2"	1 1/2"	23		1	-	59



**FLEXIBLES L. 500 mm**

TUBI FLESSIBILI L. 500 mm  
TUBOS FLEXIBLES L. 500 mm  
TUBES FLEXIBLES 500 mm de long  
VERBINDERSCHLÄUCHE L. 500 mm



Code	Ø1	Ø2	Length	PN	(g)
<b>R226.012.500</b>	1/2"	1/2"	500	20	201
<b>R226.034.500</b>	3/4"	3/4"	500	20	373
<b>R226.001.500</b>	1"	1"	500	15	676
<b>R226.114.500</b>	1 1/4"	1 1/4"	500	10	1200
<b>R226.112.500</b>	1 1/2"	1 1/2"	500	10	1400
<b>R226.002.500</b>	2"	2"	500	10	2000

**FLEXIBLES L. 1.500 mm**

TUBI FLESSIBILI L. 1.500 mm  
TUBOS FLEXIBLES L. 1.500 mm  
TUBES FLEXIBLES 1.500 mm de long  
VERBINDERSCHLÄUCHE L. 1.500 mm



Code	Ø1	Ø2	Length	PN	(g)
<b>R227.012.150</b>	1/2"	1/2"	1500	20	450
<b>R227.034.150</b>	3/4"	3/4"	1500	20	810
<b>R227.001.150</b>	1"	1"	1500	15	1340
<b>R227.114.150</b>	1 1/4"	1 1/4"	1500	10	2600
<b>R227.112.150</b>	1 1/2"	1 1/2"	1500	10	3010
<b>R227.002.150</b>	2"	2"	1500	10	5040



**ROTARY HOLE SAW FOR PRESSURIZED SYSTEMS**

ATTREZZI DI FORATURA  
HERRAMIENTA DE PERFORACIÓN  
OUTIL DE PERÇAGE  
BOHRWERKZEUG

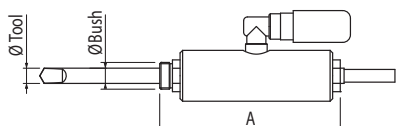

Code	Ø BUSH	Ø TOOL	A	Description	(g)
<b>R208.010.040</b>	1/2"	Ø10	202	Rotary hole saw ø10 for pressurized systems Attrezzo ø10 per foratura tubi in pressione Herramienta ø10 para perforación de tubos a presión Outil ø10 pour percer les tubes sous pression Bohrwerkzeug ø10 für Rohren unter Druck	676
<b>R208.012.040</b>	1/2"	Ø12	142	Rotary hole saw ø12 for pressurized systems Attrezzo ø12 per foratura tubi in pressione Herramienta ø12 para perforación de tubos a presión Outil ø12 pour percer les tubes sous pression Bohrwerkzeug ø12 für Rohren unter Druck	676
<b>R208.001.063</b>	1"		294	Rotary hole saw for pressurized systems Attrezzo per foratura tubi in pressione Herramienta para perforación de tubos a presión Outil pour percer les tubes sous pression Bohrwerkzeug für Rohren unter Druck	2262

**ROTARY HOLE SAW**

ATTREZZI DI FORATURA SEMPLICI  
HERRAMIENTAS DE PERFORACIÓN SENCILLAS  
OUTILS DE PERÇAGE SIMPLE  
BOHRWERKZEUGE

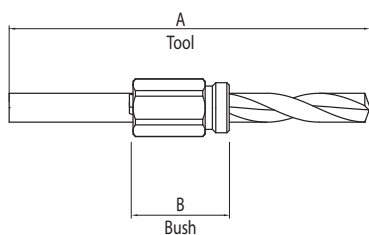

Code	Ø BUSH	Ø TOOL	A	B	Description	(g)
<b>R208.012.010</b>	1/2"	-	-	25	Bush Boccola Casquillo Douille Buchse	54
<b>R208.012.012</b>	1/2"	-	-	40	Bush Boccola Casquillo Douille Buchse	90
<b>R208.010.000</b>	1/2"	10	135	25	Bush + tool ø10 Boccola + utensile ø10 Casquillo + herramienta ø10 Douille + outil ø10 Buchse + Werkzeug ø10	102
<b>R208.012.000</b>	1/2"	12	150	40	Bush + tool ø12 Boccola + utensile ø12 Casquillo + herramienta ø12 Douille + outil ø12 Buchse + Werkzeug ø12	179
<b>R208.034.000</b>	3/4"	15	170	50	Bush + tool ø15 Boccola + utensile ø15 Casquillo + herramienta ø15 Douille + outil ø15 Buchse + Werkzeug ø15	335
<b>R208.001.020</b>	1"	20	205	60	Bush + tool ø20 Boccola + utensile ø20 Casquillo + herramienta ø20 Douille + outil ø20 Buchse + Werkzeug ø20	658



**CHAMFER AND DEBURRING TOOL UP TO Ø 50**  
 CONO SMUSSATORE FINO A Ø 50  
 CONO PARA ACHAFLANAR MÁX. Ø 50  
 OUTIL À CHANFREINER JUSQU'À Ø 50  
 ROHRENTGRATER BIS ZU Ø 50

Code	Ø	Description	(g)
<b>R230.000.008</b>	15-50	External and internal chamfering up to Ø 50 mm Smussatura esterna e interna fino a Ø 50 mm Achaflanado externo e interno máx. Ø 50 mm Chanfreinage externe et interne jusqu'à Ø 50 mm Äußere und innere Entgratung bis zu Ø 50 mm	257



**Internal chamfering**

Smussatura interna  
Achaflanado interno  
Chanfreinage interne  
Innere Entgratung



**External chamfering**

Smussatura esterna  
Achaflanado externo  
Chanfreinage externe  
Äußere Entgratung

**DEBURRING TOOL**  
 SMUSSATORE MANUALE  
 BISELADORA MANUAL  
 OUTIL POUR CHANFREINER  
 ENTGRATWERKZEUG

Code	Ø	Description	(g)
<b>R230.000.007</b>	-	Internal chamfering Smussatura interna Achaflanado interno Chanfreinage interne Innere Entgratung	26





**PIPES CUTTER with chamfer tool**

ATTREZZO TAGLIA TUBI con smussatore  
 HERRAMIENTA PARA CORTAR TUBOS con biseladora  
 OUTIL POUR DÉCOUPER LES TUBES avec outil pour chanfreiner  
 ROHRSCHEIDER mit Entgrater



Code	Ø	Description	(g)
<b>R230.000.009</b>	15-40	For pipes from Ø 15 to Ø 40 mm Per tubi da Ø 15 a Ø 40 mm Para tubos de Ø 15 a Ø 40 mm Pour tubes de Ø 15 à Ø 40 mm Für Rohre von Ø 15 bis Ø 40 mm	507
<b>R230.000.010</b>	15-63	For pipes from Ø 15 to Ø 63 mm Per tubi da Ø 15 a Ø 63 mm Para tubos de Ø 15 a Ø 63 mm Pour tubes de Ø 15 à Ø 63 mm Für Rohre von Ø 15 bis Ø 63 mm	800



**ADJUSTABLE REAMER for pipes from 50 to 160**

ALESATORE REGOLABILE per tubi 50 a 160  
 ESCARIADOR REGULABLE para tubos 50 a 160  
 OUTIL POUR CHANFREINER RÉGLABLE pour tubes de 50 à 160  
 VERSTELLBARER ROHRENTGRATER für Rohre 50 bis 160



Code	Ø	Description	(g)
<b>R230.000.011</b>	50-63	For large size pipes 814 Per tubi di grandi dimensioni Para tubos de gran tamaño Pour tubes de grandes dimensions Für große Rohre	814





**FITTING RING SPANNERS**  
 CHIAVI SERRAGGIO GHIERE  
 LLAVES DE APRIETE PARA TUERCAS  
 CLÉS DE SERRAGE ÉCROU GRIFFES  
 ANZIEHSCHLÜSSEL FÜR MUTTERN

**NEW**



**EVO**

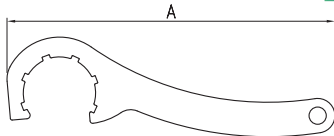

**CLASSIC**

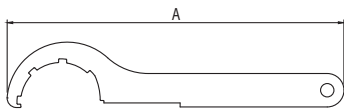

Code	Ø	A	(g)
<b>FOR EVO FITTING</b>			
<b>SRR235.020.025</b>	20 - 25	237	148
<b>SRR235.032.040</b>	32 - 40	285	192
<b>SRR235.050.063</b>	50 - 63	361	301
<b>FOR CLASSIC FITTING</b>			
<b>R235.020.000</b>	20	170	66
<b>R235.025.000</b>	25	210	71
<b>R235.032.000</b>	32	210	73
<b>R235.040.000</b>	40	240	133
<b>R235.050.000</b>	50	280	188
<b>R235.063.000</b>	63	320	306



**Internal chamfering**

Smussatura interna  
 Achaflanado interno  
 Chanfreinage interne  
 Innere Entgratung



**Insert the fitting up to mark**

Inserire il raccordo fino al segno  
 Introducir el racor hasta la señal  
 Introduire le raccord jusqu'au repère  
 Den Verbinder bis zum Zeichen einsetzen

**FITTING BODY SPANNERS**  
 CHIAVI SERRAGGIO CORPO  
 LLAVES DE APRIETE PARA CUERPO  
 CLÉS DE SERRAGE CORPS  
 ANZIEHSCHLÜSSELN KÖRPER

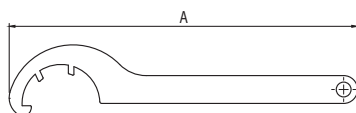

Code	Ø	A	(g)
<b>R236.020.000</b>	20	170	70
<b>R236.025.000</b>	25	210	102
<b>R236.032.000</b>	32	210	114
<b>R236.040.000</b>	40	240	150
<b>R236.050.000</b>	50	280	210
<b>R236.063.000</b>	63	320	271



**Positioning of spanners**

Posizionamento delle chiavi  
 Posicionamiento de las llaves  
 Positionnement des clés  
 Positionierung der Schlüssel



**Locking of the fitting**

Chiusura del raccordo  
 Cierre del racor  
 Fermeture du raccord  
 Schließung des Verbinders



**VASELINE OIL SPRAY**  
OLIO DI VASELLINA SPRAY  
ACEITE DE VASELINA SPRAY  
HUILE DE VASELINE EN SPRAY  
VASELINÖL SPRAY



Code	Ø	Description	(g)
<b>M207.025.016</b>		Oil spray for junction Olio spray per giunzioni Aceite spray para juntas Huile en spray pour jonctions Ölspray für Verbindungen	500

**"L" ALLEN WRENCH**  
CHIAVE A BRUGOLA A "L"  
LLAVE DINAMOMÉTRICA EN "L"  
CLÉ À SIX PANS MÂLE EN L  
SECHSKANT-WINKELSCHRAUBENDREHER



Code	Ø	Description	(g)
<b>M209.025.016</b>		With spherical head Con testa sferica Con cabeza esférica Avec tête ronde Mit Kugelkopf	10

**FITTING RING**

GHIERA DI SERRAGGIO  
TUERCA DE APRIETE  
ÉCROU GRIFFES  
SPANN-MUTTER

**NEW**



**EVO**

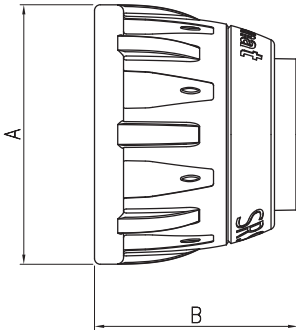

Code	Color	Ø	A	B	C	D			(g)
SRR253.020.000		20	44	35			5	-	21
SRR253.025.000		25	52	41			5	-	27,3
SRR253.032.000		32	62	42			5	-	41,3
SRR253.040.000		40	72	53			5	-	66
SRR253.050.000		50	86,50	65			5	-	111,2
SRR253.063.000		63	105	70			5	-	163
SRG253.020.000		20	44	35			5	-	21
SRG253.025.000		25	52	41			5	-	27,3
SRG253.032.000		32	62	42			5	-	41,3
SRG253.040.000		40	72	53			5	-	66
SRG253.050.000		50	86,50	65			5	-	111,2
SRG253.063.000		63	105	70			5	-	163
SRA253.025.000		25	52	41			5	-	27,3
SRA253.040.000		40	72	53			5	-	66

**FITTING RING**

GHIERA DI SERRAGGIO  
TUERCA DE APRIETE  
ÉCROU GRIFFES  
SPANN-MUTTER



**CLASSIC**

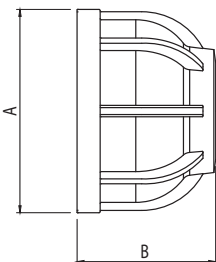

Code	Color	Ø	A	B	C	D			(g)
R209.020.000		20	44	30			5	-	15
R209.025.000		25	52	37			5	-	25
R209.032.000		32	62	43			5	-	39
R209.040.000		40	72	47			5	-	53
R209.050.000		50	86,50	59			5	-	106
R209.063.000		63	105	70			5	-	156
A209.025.000		25	52	37			5	-	25
A209.040.000		40	72	47			5	-	53
V209.063.000		63	105	70			5	-	156

**ELLIPTICAL O-RING**

O-RING ELLITTICO  
 JUNTA TÓRICA ELÍPTICA  
 JOINT TORIQUE ELLIPTIQUE  
 ELIPTISCHER O-RING



Code	Color	Ø	A	B	C	D			(g)
<b>R200.020.000</b>	-	20	-	-			5	-	1
<b>R200.025.000</b>	-	25	-	-			5	-	2
<b>R200.032.000</b>	-	32	-	-			5	-	3
<b>R200.040.000</b>	-	40	-	-			5	-	4
<b>R200.050.000</b>	-	50	-	-			5	-	6
<b>R200.063.000</b>	-	63	-	-			5	-	8

**RING**

GRAFFETTA  
 GRAPA  
 GRIFFE  
 MUTTER

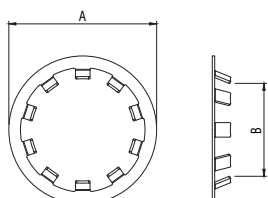

Code	Color	Ø	A	B	C	D			(g)
<b>R216.020.000</b>	-	20	31	20,20			5	-	1
<b>R216.025.000</b>	-	25	38,8	25,20			5	-	2
<b>R216.032.000</b>	-	32	48,20	32,50			5	-	3
<b>R216.040.000</b>	-	40	56,30	40,50			5	-	4
<b>R216.050.000</b>	-	50	69	50,50			5	-	6
<b>R216.063.000</b>	-	63	85,10	63,20			5	-	8

**SPACER**

DISTANZIALE  
 DISTANCIADOR  
 ENTRETOISE  
 DISTANZPLATTE



Code	Color	Ø	A	B	C	D			(g)
<b>R229.020.000</b>	-	20	-	-			5	-	1
<b>R229.025.000</b>	-	25	-	-			5	-	2
<b>R229.032.000</b>	-	32	-	-			5	-	3
<b>R229.040.000</b>	-	40	-	-			5	-	4
<b>R229.050.000</b>	-	50	-	-			5	-	6
<b>R229.063.000</b>	-	63	-	-			5	-	8

